

THIS IS TO CERTIFY THAT I ON JUNE 27, 1991 SURVEYED THE PROPERTY SHOWN ON THIS PLAT, AND THAT THE TITLE LINES AND THE WALLS OF THE BUILDING ARE AS SHOWN ON THIS PLAT.

THE IMPROVEMENTS STAND STRICTLY WITHIN THE TITLE LINES AND THERE ARE NO ENCROACHMENTS OR VISIBLE EASEMENTS, EXCEPT AS SHOWN.

SIGNED John G. Horton L.S.



NOW OR FORMERLY  
BAYSIDE, INC.  
M.B. 242, P. 80

NOW OR FORMERLY  
PARCEL #  
A.D. MALLORY, SR.  
PROPERTY  
M.B. 37, P. 25

**PARCEL 1**  
913,574 SQ. FT. : OR  
20.97 AC. :

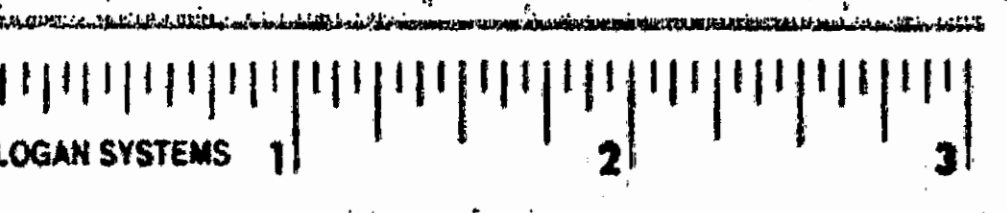

NO.	DELTA	CH. BRG.	RADIUS	LENGTH	TANGENT	CHORD
1	06°18'13"	N83°47'22"W	2839.79'	312.43'	156.37'	312.26'
2	01°12'19"	N86°20'19"W	2889.79'	60.79'	30.40'	66.79'
3	00°35'41"	N86°02'00"W	2889.79'	30.00'	15.00'	30.00'
4	00°36'38"	N86°38'10"W	2889.79'	30.79'	15.40'	30.79'

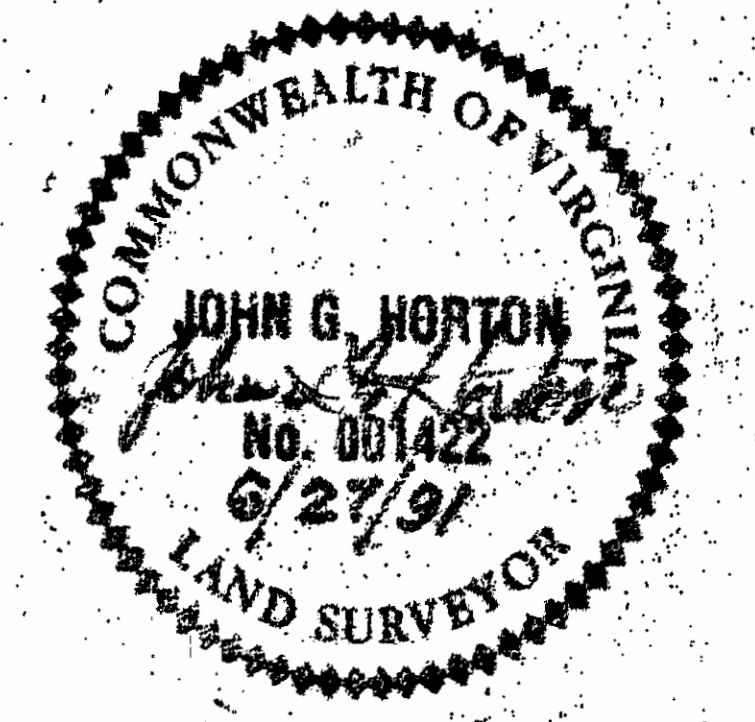
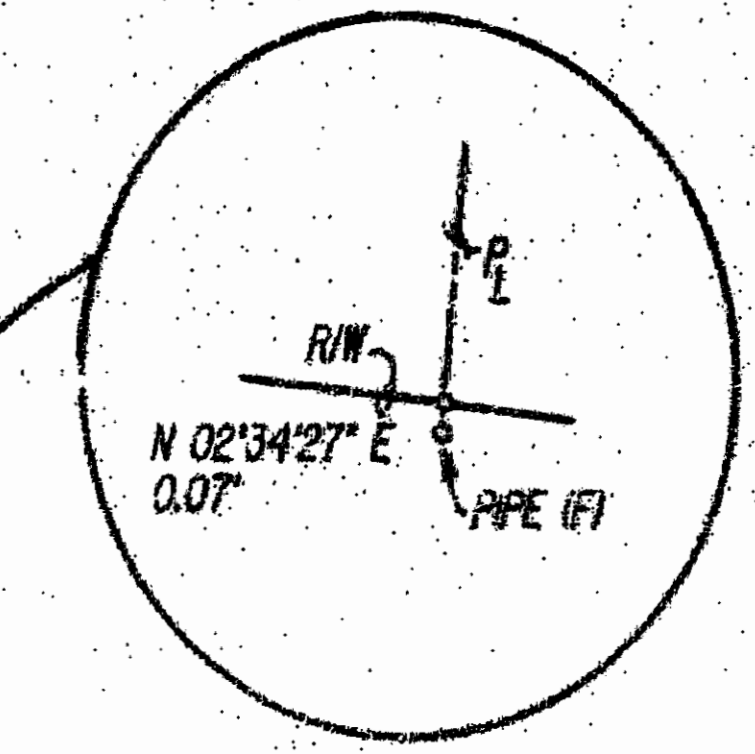
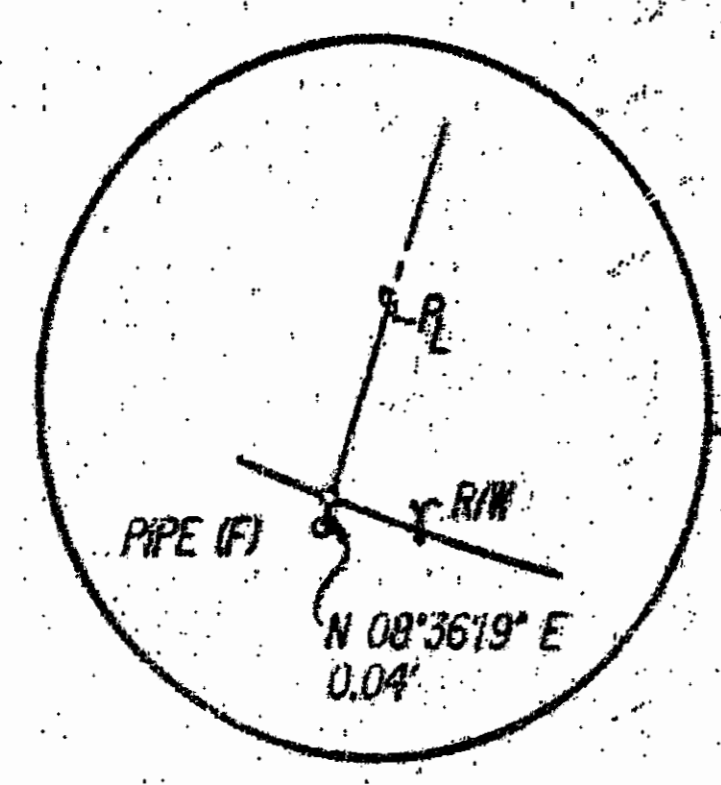

THIS SURVEY IS BASED ON INFORMATION TAKEN FROM RECORDED MAP, NO DEED OR TITLE REPORT FURNISHED.

This is to certify that this survey refers to the same lot as set forth by PLAT dated FEB. 17, 1982 and recorded in the clerk's office of the CIRCUIT Court of JAMES CITY COUNTY, Virginia in MAP Book 37 Page 25 W.O. 5525

ALSO SEE D.B. 221, P. 567

L = 312.27', R = 2764.36' - PLAT M.B. 37, P. 22  
L = 312.43' FIELD  
R = 2839.78' PER HWY. PROJ.  
0612-047-105, C-501  
SHEETS 38 4

**STATE ROUTE 612 (LONGHILL ROAD)**

PHYSICAL SURVEY  
OF  
PARCEL 1  
SUBDIVISION PLAT OF  
PROPERTY STANDING IN THE NAME OF  
**A.D. MALLORY, SR.**  
LOCATED BERKELEY DISTRICT  
JAMES CITY COUNTY, VIRGINIA  
FOR  
**ROLLING MEADOWS ASSOCIATES, L.P.**  
HORTON & DODD, P.C.  
SURVEYORS - ENGINEERS - PLANNERS  
CHESAPEAKE VIRGINIA

SCALE: 1" = 100'

334 pm.  
26  
539  
244  
Horton & Dodd