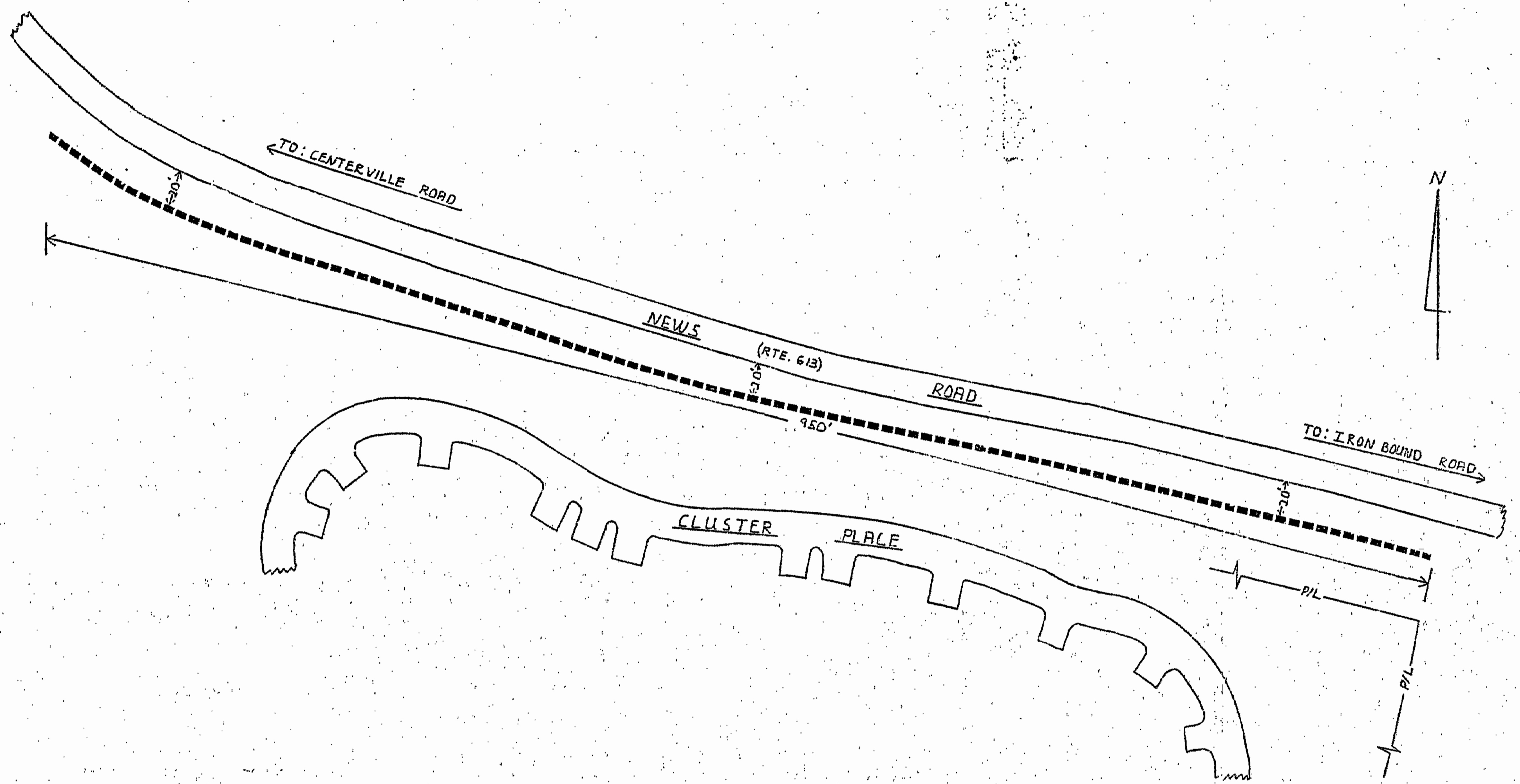

EXHIBIT "A"



NO SCALE

----- DEMOTES CENTER LINE OF 20' RIGHT OF WAY

DRAWN FROM PLAT OF
POWHATAN OF WILLIAMSBURG SECONDARY
CLUSTER HOMES
PROJ. NO. 78-41
DWG. 1086W

| |
|---|
| THE CHESAPEAKE AND POTOMAC TELEPHONE COMPANY OF VIRGINIA |
| DISTRICT BERKELEY |
| COUNTY JAMES CITY |
| PERMIT NO. EC-351073-R |
| PREPARED BY: G. IVEY DATE 5-30-91 |

SHEET 3 OF 3

8:40 AM.
Recorded 279 day of July 1991
in
B. B. No. 521 pages 495
Helene Steward Clerk

