

**OWNER'S CERTIFICATE**

THIS PLAT IS WITH THE FREE CONSENT AND IN ACCORDANCE WITH THE DESIRE OF THE UNDERSIGNED OWNERS, PROPRIETORS AND/OR TRUSTEES.

1/27/90 DATE  
 1/11/91 DATE  
 [Signature] AGENT OF THE COUNTY OF JAMES CITY  
 [Signature] AGENT OF THE CITY OF WILLIAMSBURG

**CERTIFICATE OF NOTARIZATION FOR COUNTY OF JAMES CITY**

STATE OF VIRGINIA  
 CITY/COUNTY OF James City I, [Signature]  
 A NOTARY PUBLIC IN AND FOR THE CITY/COUNTY AND STATE AFORESAID, DO HEREBY CERTIFY THAT THE PERSONS WHOSE NAMES ARE SIGNED TO THE FOREGOING WRITING HAVE ACKNOWLEDGED THE SAME BEFORE ME IN THE CITY/COUNTY AFORESAID. GIVEN UNDER MY NAME THIS 27 DAY OF November, 1990. MY COMMISSION EXPIRES March 23, 1993.  
 [Signature] SIGNATURE

**CERTIFICATE OF NOTARIZATION FOR CITY OF WILLIAMSBURG**

STATE OF VIRGINIA  
 CITY/COUNTY OF Williamsburg I, [Signature]  
 A NOTARY PUBLIC IN AND FOR THE CITY/COUNTY AND STATE AFORESAID, DO HEREBY CERTIFY THAT THE PERSONS WHOSE NAMES ARE SIGNED TO THE FOREGOING WRITING HAVE ACKNOWLEDGED THE SAME BEFORE ME IN THE CITY/COUNTY AFORESAID. GIVEN UNDER MY NAME THIS 16th DAY OF January, 1991. MY COMMISSION EXPIRES July 24, 1992.  
 [Signature] SIGNATURE

**CERTIFICATE OF SOURCE OF TITLE**

THE PROPERTY SHOWN ON THIS PLAT WAS CONVEYED TO THE COUNTY OF JAMES CITY AND CITY OF WILLIAMSBURG PER DEED BOOK 292, PAGE 308, RECORDED IN THE OFFICE OF THE CLERK OF THE CIRCUIT COURT OF JAMES CITY COUNTY.

**CERTIFICATE OF APPROVAL**

THIS PLAT IS APPROVED BY THE UNDERSIGNED IN ACCORDANCE WITH EXISTING SUBDIVISION REGULATIONS AND MAY BE ADMITTED TO RECORD  
 1/27/91 DATE  
 [Signature] AGENT OF GOVERNING BODY

**SURVEYOR'S CERTIFICATE**

I HEREBY CERTIFY THAT TO THE BEST OF MY KNOWLEDGE OR BELIEF, THIS PLAT COMPLES WITH ALL OF THE REQUIREMENTS OF THE BOARD OF SUPERVISORS AND ORDINANCES OF THE COUNTY OF JAMES CITY, VIRGINIA, REGARDING THE PLATTING OF SUBDIVISIONS WITHIN THE COUNTY.

OCT. 8, 1990 DATE  
 [Signature] G. T. WILSON, JR. C.I.S.

NOTE: THIS PLAT IS BASED UPON THE REFERENCES NOTED. IT DOES NOT REPRESENT A FIELD SURVEY AND IS SUBJECT TO VERIFICATION.

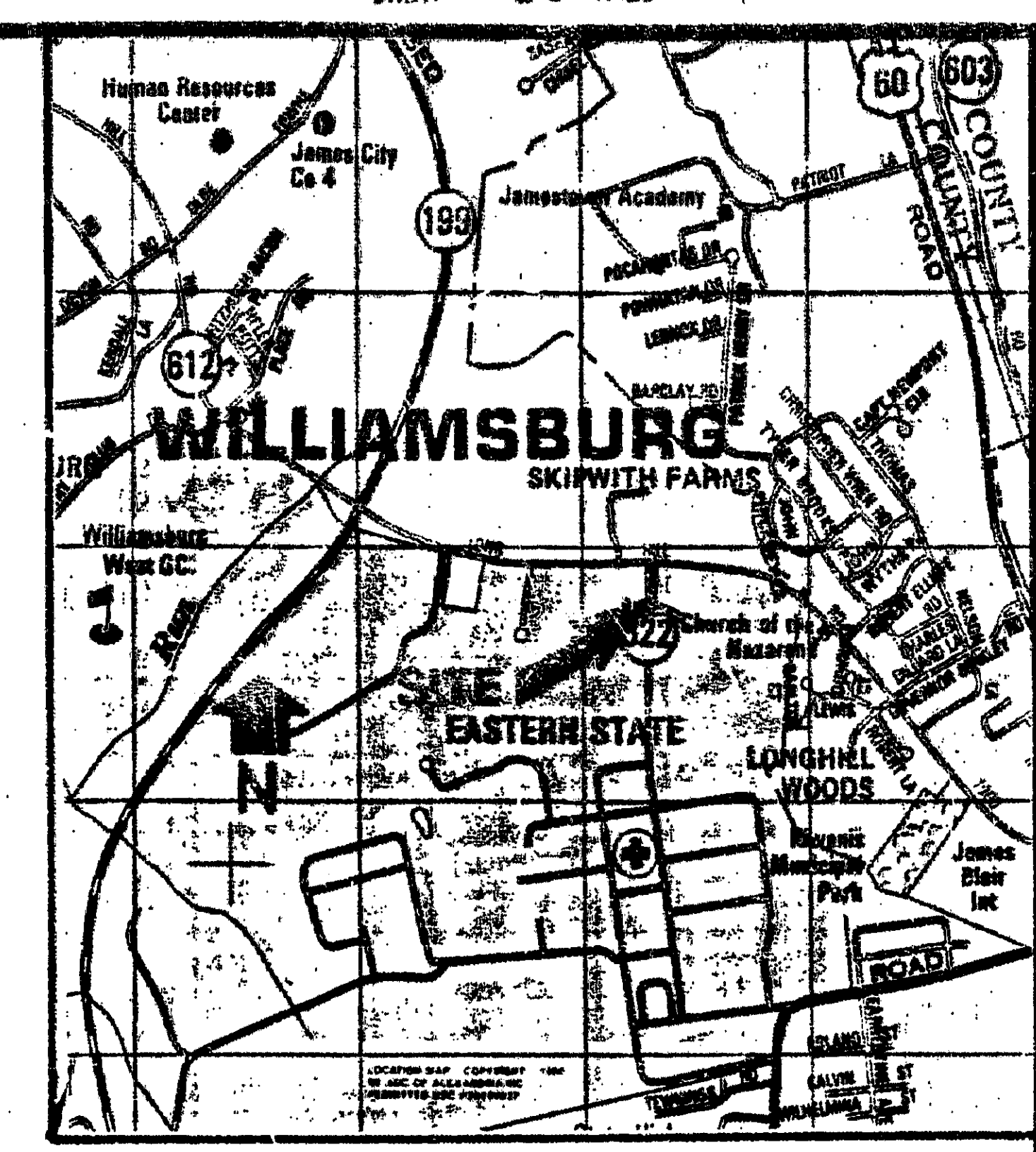
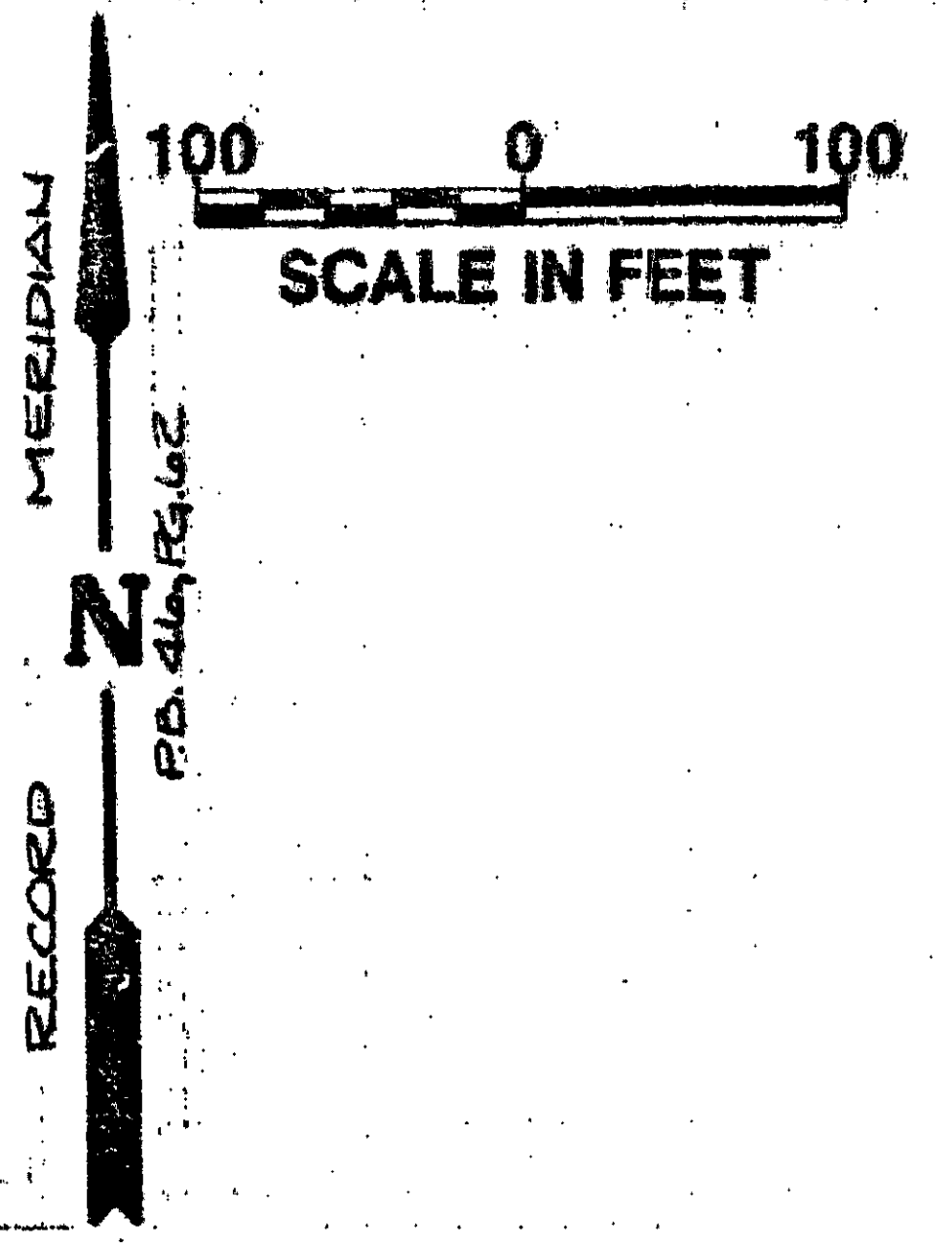
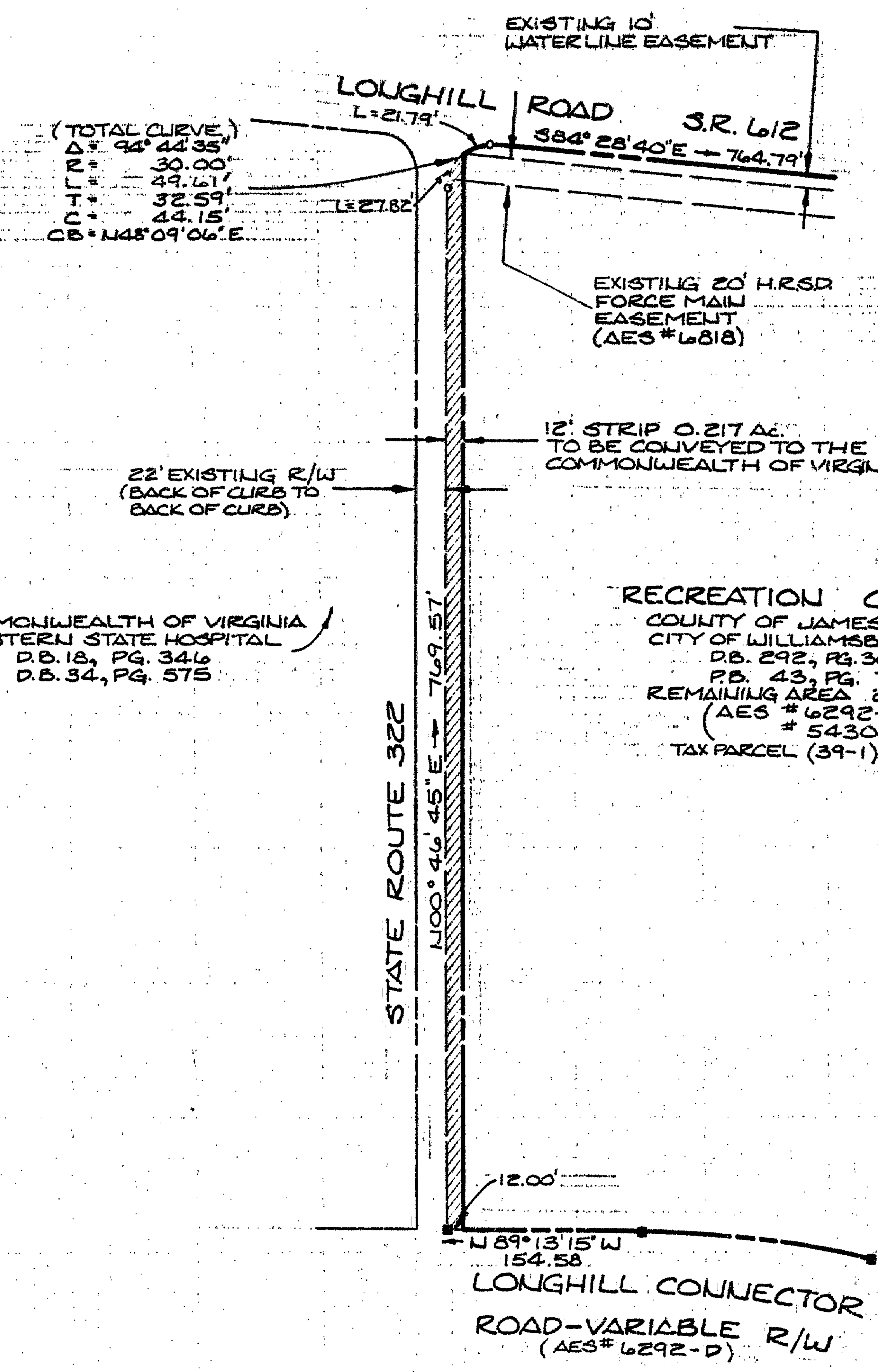

COMMONWEALTH OF VIRGINIA  
 EASTERN STATE HOSPITAL  
 D.B. 18, PG. 346  
 D.B. 34, PG. 575

RECREATION CENTER  
 COUNTY OF JAMES CITY &  
 CITY OF WILLIAMSBURG  
 P.B. 292, PG. 308  
 P.B. 43, PG. 76  
 REMAINING AREA 20.61 Ac.±  
 (AES # 6292-C  
 # 5430-15)  
 TAX PARCEL (39-1) (1-153)

COMMONWEALTH OF VIRGINIA  
 EASTERN STATE HOSPITAL  
 D.B. 18, PG. 346  
 D.B. 34, PG. 575

9:24 AM  
 11/27/91  
 500  
 [Signature]



**CONSULTING ENGINEERS**  
 5248 Olde Towne Road, Suite 1  
 Williamsburg, Virginia 23185  
 (804) 253-0040

PLAT FOR CONVEYANCE AND DEDICATION OF RIGHT-OF-WAY A PARCEL CONTAINING 0.217 Ac.± FROM: COUNTY OF JAMES CITY AND CITY OF WILLIAMSBURG TO: COMMONWEALTH OF VIRGINIA  
 BERKELEY DISTRICT JAMES CITY COUNTY VIRGINIA



No.	DATE	REVISION / COMMENT / NOTE	BY

Designed	Drawn
Scale	Date
1" = 100'	10/4/90
Project No.	
5430-15A	
Drawing No.	
PLAT	