

" EXHIBIT A "

----- C&P TELEPHONE COMPANY
TEN FOOT (10) EASEMENT
○ LOT NUMBERS
- - - - - PROPERTY LINES

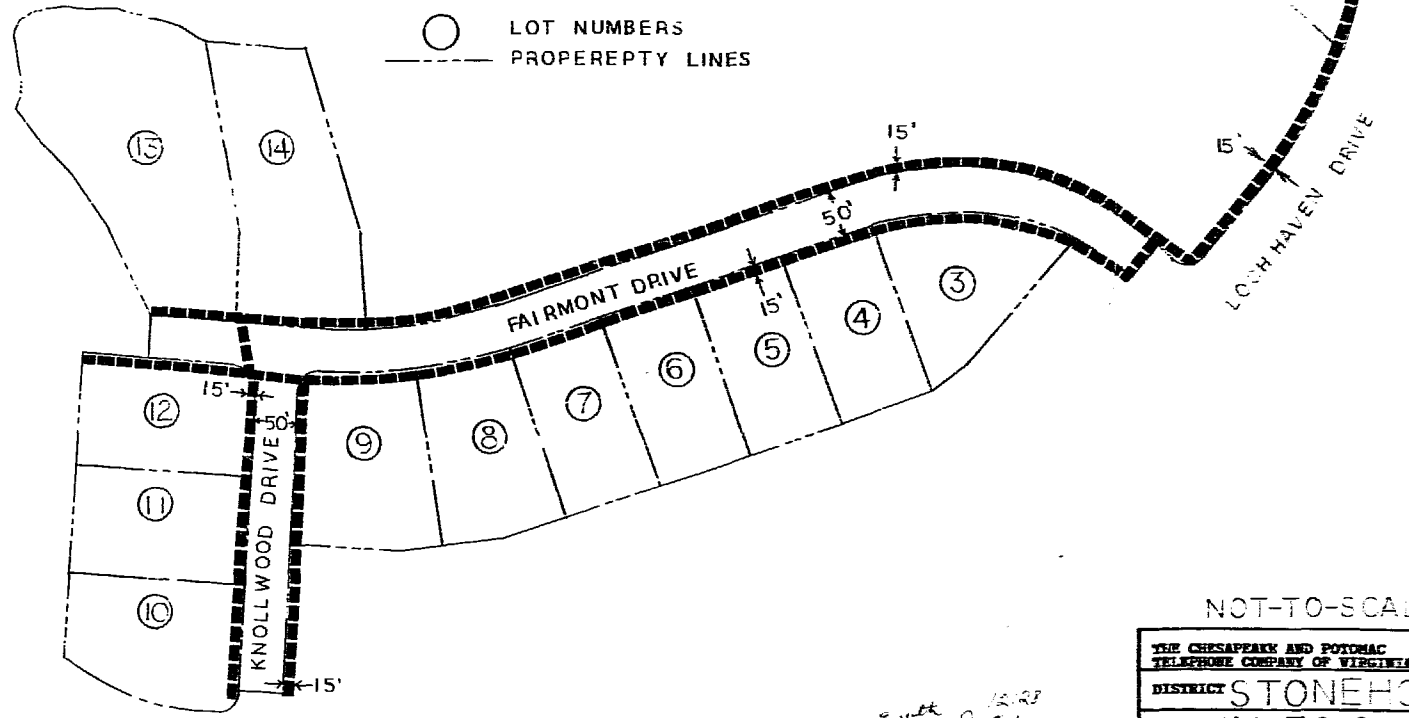

NOT-TO-SCALE

THE CHESAPEAKE AND POTOMAC TELEPHONE COMPANY OF VIRGINIA	
DISTRICT	STONEHOUSE
COUNTY	JAMES CITY
PERMIT NO.	B0334555A
PREPARED BY: DH.	DATE 10-3-89

Recorded *8/24/89* at *12:28*
in *October*
P.B. No. *453* ; pages *572*
Bellevue Stewart Clerk

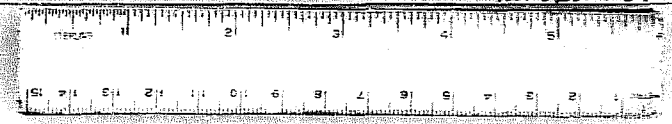

Plan Book 37 19 57