

LCE = LIMITED COMMON ELEMENT

WE HEREBY CERTIFY THAT WE HAVE VIEWED ALL OF THE UNITS OR PORTIONS THEREOF AND DO FURTHER CERTIFY THAT THESE PLANS ARE ACCURATE AND THEY COMPLY WITH SECTION 55-79.58 (B) OF THE CODE OF VIRGINIA AS AMENDED. ALL STRUCTURES ARE SUBSTANTIALLY COMPLETE.

AES, a professional corporation

Paul Small  
PAUL C. SMALL, P.E., C.L.S.

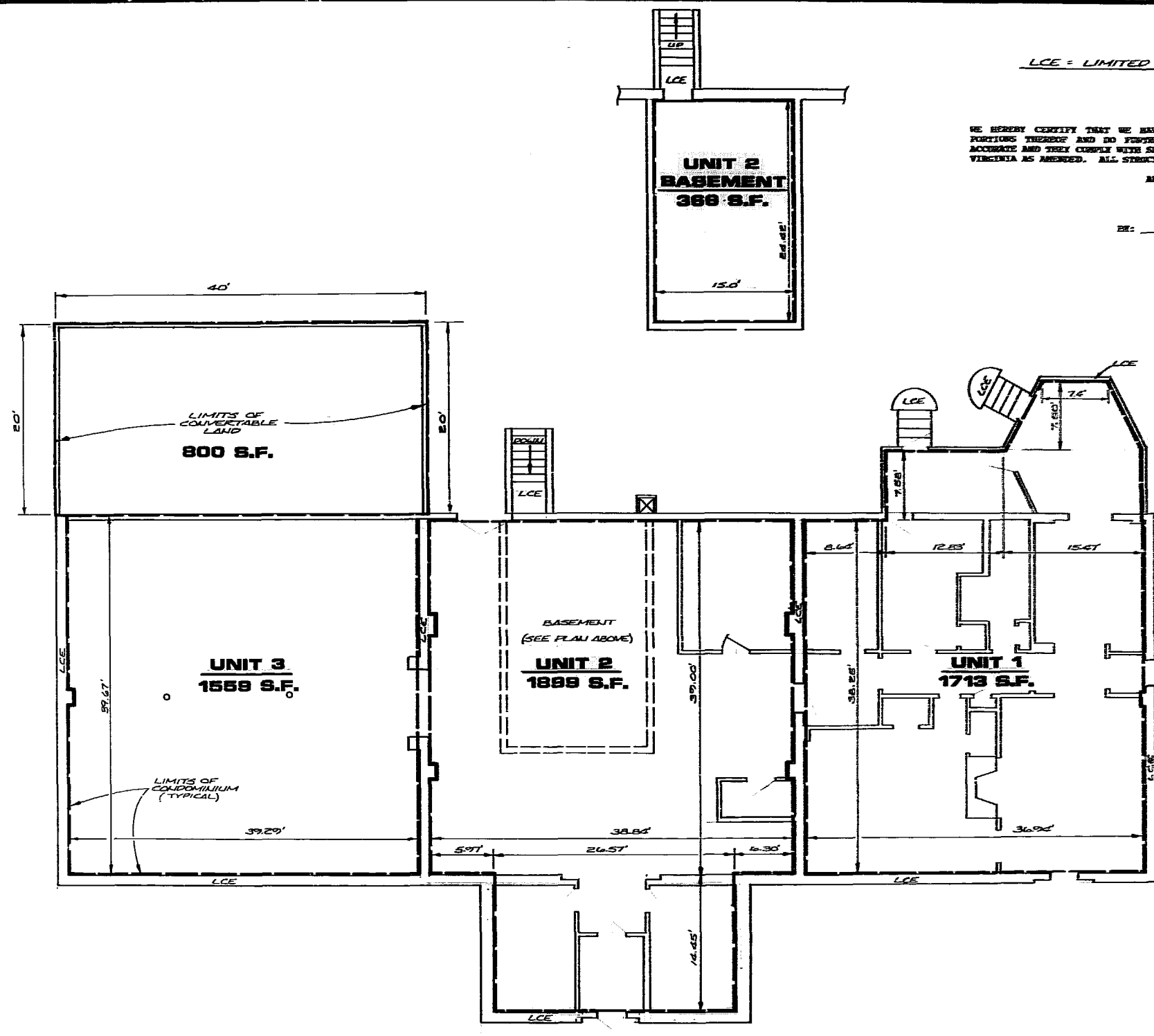

PLAN VIEW  
SCALE: 1/8" = 1'-0"



**AES**, a professional corporation  
5248 Olde Towne Road, Suite 1  
Williamsburg, Virginia 23185  
(804) 253-0040  
Engineering, Planning, Surveying

**CONDOMINIUM PLAT  
OF  
WHITEHALL  
UNITS 1, 2, & 3**  
OWNER/DEVELOPER: MILLER PROPERTIES  
JAMES CITY COUNTY VIRGINIA

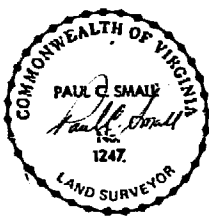

No.	DATE	REVISION / COMMENT / NOTE	BY

Designed	Drewn
Scale	DATE
NOTED	JULY 28, 2009
Project No. 7043	
Drawing No. 2 of 3	

