

RIGHT OF WAY

ON PROPERTY OF:

MOORETOWN ASSOCIATES

a Virginia Limited Partnership  
by W. Dean Short,  
General Partner  
and Robert L. Turlington,  
General Partner

Partner's Initials:

*WDS*  
W.D.S.  
*RLT*  
R.L.T.

ROUTE 60 - RICHMOND ROAD

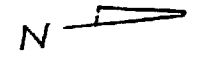

C&O RAILWAY CO.

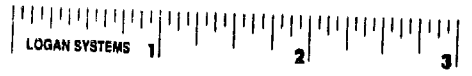
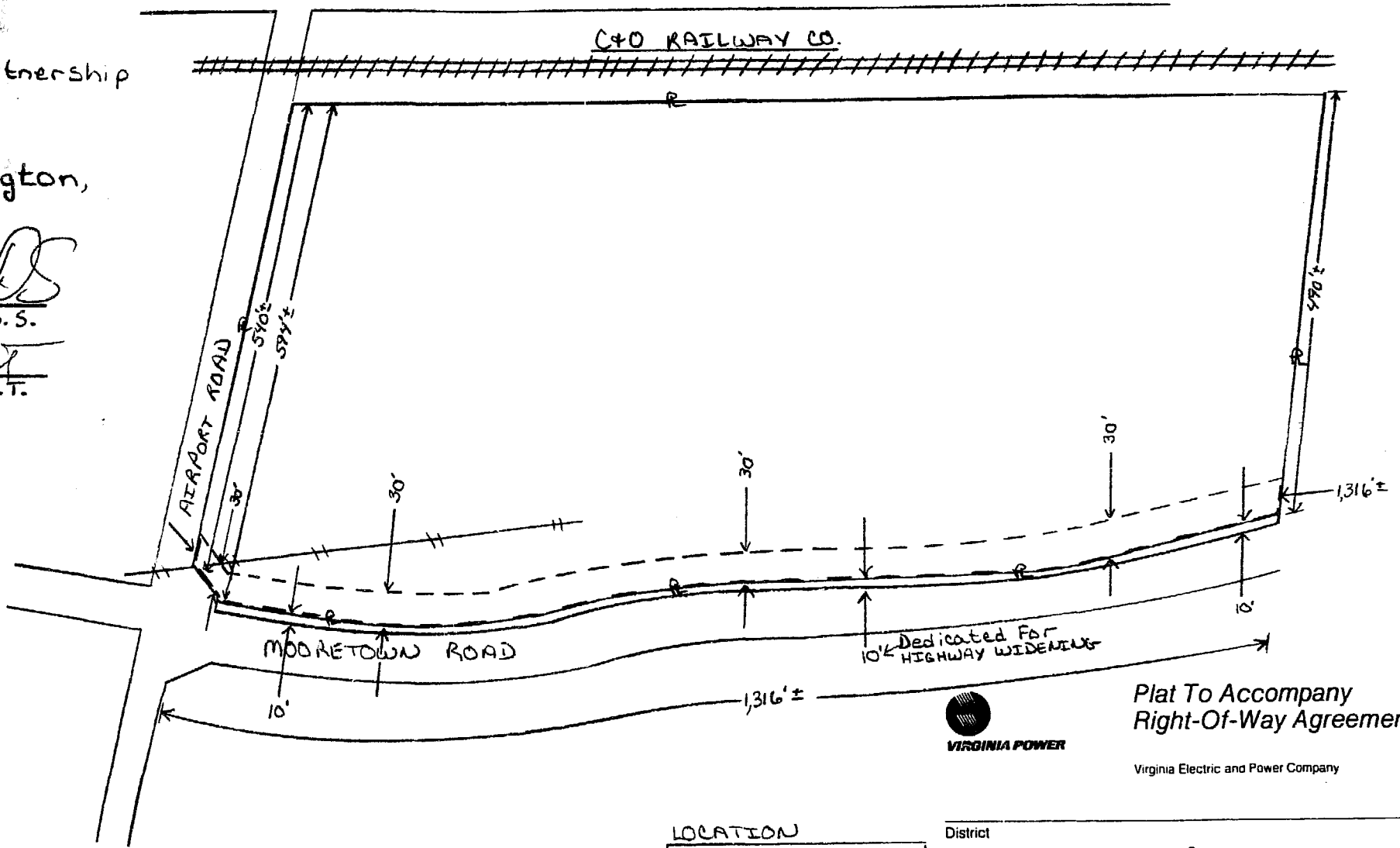

Plat To Accompany  
Right-Of-Way Agreement



Virginia Electric and Power Company

Legend

- Location Of Boundary Line Of Designated Right-of-Way 30 FEET IN WIDTH
- INDICATES PROPERTY LINE IS RIGHT OF WAY BOUNDARY
- || EXISTING VA. POWER FACILITIES

No 97556910  
Rev A

11:53 AM

Recorded 21<sup>st</sup> day of February 1989  
in  
D. B. No. 426 ; pages 474  
Walter Swain Clerk

LOCATION

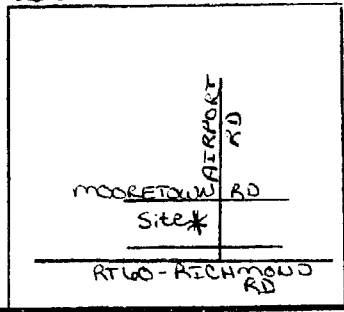

District	Williamsburg - Overhead		
District-Township-Borough	County	City	State
	Berkeley	James City	Va.
Office	Plat Number		
	Williamsburg 28-89-0022		
Estimate Number	Grid Number		
N/A	M1839		
Date	By		
January 27, 1989	Donna H. Lynch		

