

NOTE: THE ARCHER ASHLOCK BOUNDARY REVISED 4/21/71.

THE CHESAPEAKE CORP. OF VA. "FARINHOLT"

152 ACRES

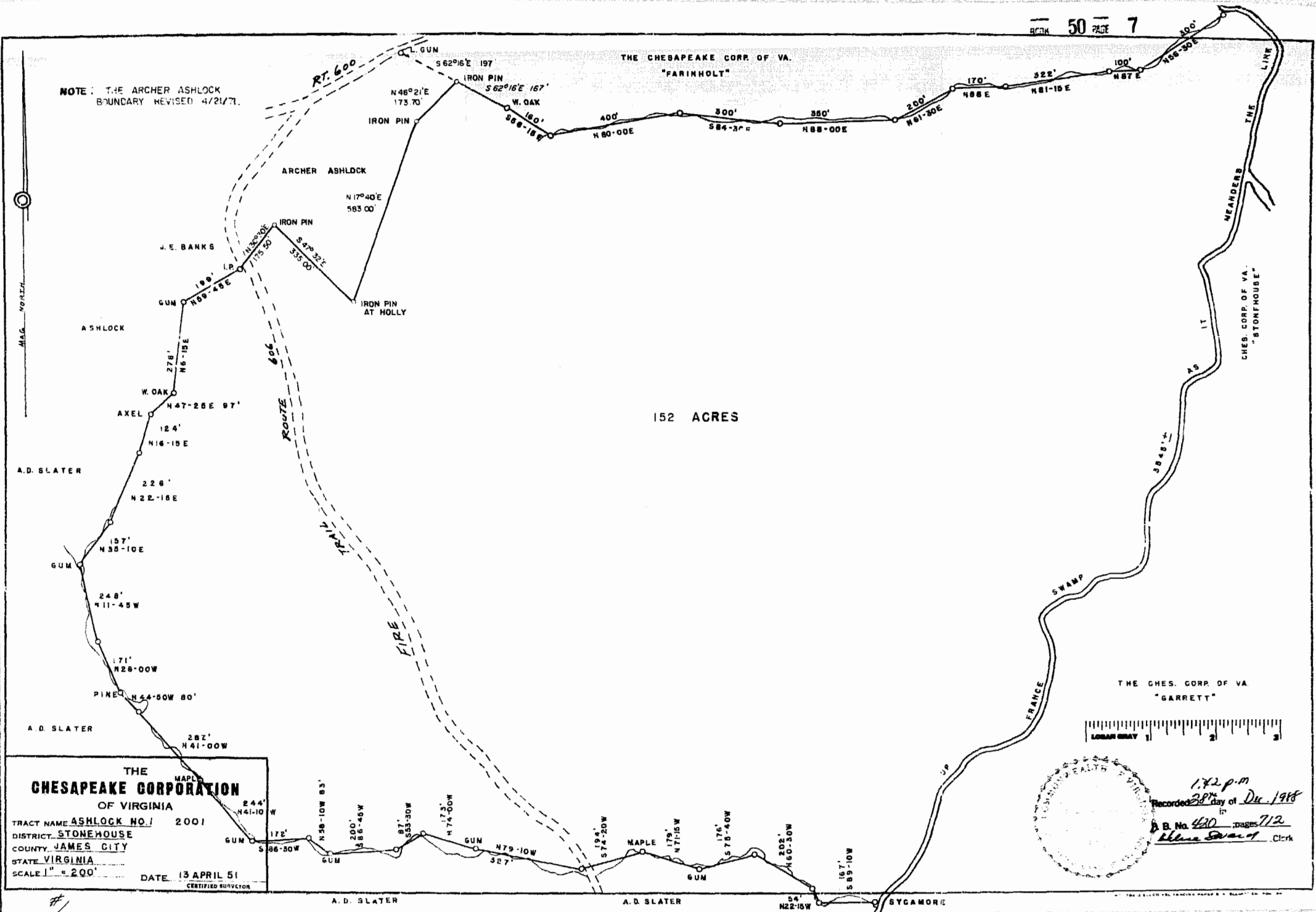

MAG. NORTH

A.D. SLATER

A.D. SLATER

THE CHESAPEAKE CORPORATION OF VIRGINIA

TRACT NAME ASHLOCK NO. 1 2001

DISTRICT STONEHOUSE

COUNTY JAMES CITY

STATE VIRGINIA

SCALE 1" = 200'

DATE 13 APRIL 51

CERTIFIED SURVEYOR

A. D. SLATER

A. D. SLATER

SYCAMORE

THE CHES. CORP. OF VA. "GARRETT"

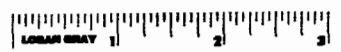

172 p.m.  
 Recorded 28<sup>th</sup> day of Dec 1968  
 in  
 D. B. No. 420, pages 712  
 [Signature] Clerk

