

REFERENCES:

DEED BOOK 38,	PAGE 468 & 469
" 35,	" 241
" 33,	" 290
" 95,	" 186
" 110,	" 522-524
PLAT BOOK 3,	PAGE 26

AREA =
 621,275.66 ±
 OR 14.26 ACRES ±

N OR F
 B. S. BOWLER, JR.

N OR F
 THOMAS O. STEWART

SURVEY LINES ONLY!!
 E OF RAVINE IS R

N OR F
 RYLAND C. LETHELA
 HAZLEWOOD



PREPARED BY
SPEARMAN & ASSOC., INC. - LAND SURVEYING
 P.O. BOX # 1244
 WILLIAMSBURG, VIRGINIA - 23187
 (804) 686 - 1318

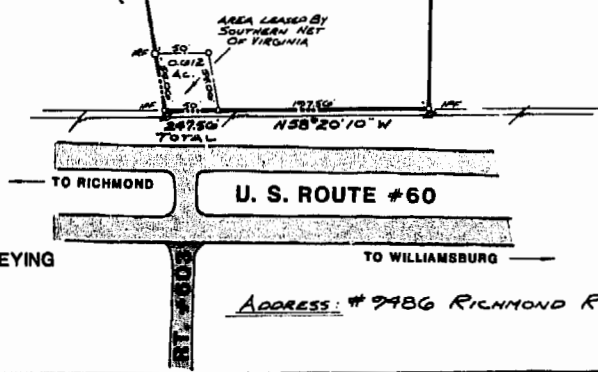

Recorded ^{9th} day of Dec. 1988
 in
 D.B. No. 411, pages 5-65
 William E. Stewart, Client
 by: Dawn R. Martin, Reg. Clerk

BOUNDARY SURVEY
 OF PROPERTY STANDING IN THE NAME OF
WILLIAM E. STEWART, JR.
 BEING
14.26 ACRES ±
 LOCATED
 JAMES CITY COUNTY, VIRGINIA

SCALE: 1"=100'
 DATE: JAN. 7, 1988
 REV'D: FEB. 5, 1988

