

NOTE: THE 10' PERMETER LANDSCAPE STRIP ALONG THE ADJACENT SOUTHWEST PROPERTY LINES CONTAINS ALL LIGHTS. THESE STRIPS ARE A MIN. OF 20'. THE STRIPS SHALL BE PLANTED WITH A VARIETY OF PLANT MATERIALS INCLUDING TREES, SHRUBS, AND PERENNIALS. THESE STRIPS SHALL BE MAINTAINED TO MEET REQUIREMENT. CONCRETE CURB TREE THAT IS REMOVED OR DAMAGED SHALL BE REPLACED WITH ONE THAT MEETS THE MINIMUM HEIGHT REQUIREMENT.

NOTE: THE AREA SURROUNDING BLDGS 7, 8, 9 IS HAUNDED W/ 1" RED PINES & WAKINWOODS OF VARYING DIAMETERS.

NOTE: ALL IMPROVEMENTS FROM EXTERIOR WALLS OF BUILDING TO PROPERTY LINES ARE TO BE KNOWN AS COMMON ELEMENTS (INCLUDING CURB & GUTTER, PAVING, SIDEWALKS, LANDSCAPING, ETC.)

NOTE: UNDERGROUND UTILITIES SERVING ADJACENT PROPERTIES ARE TO BE RECORDED AS BLANKET EASEMENTS

NOTE: ALL PAVED TRAVELWAYS & PARKING AREAS ARE TO BE RECORDED AS CROSS EASEMENTS FOR INGRESS AND EGRESS ON ADJACENT PROPERTIES

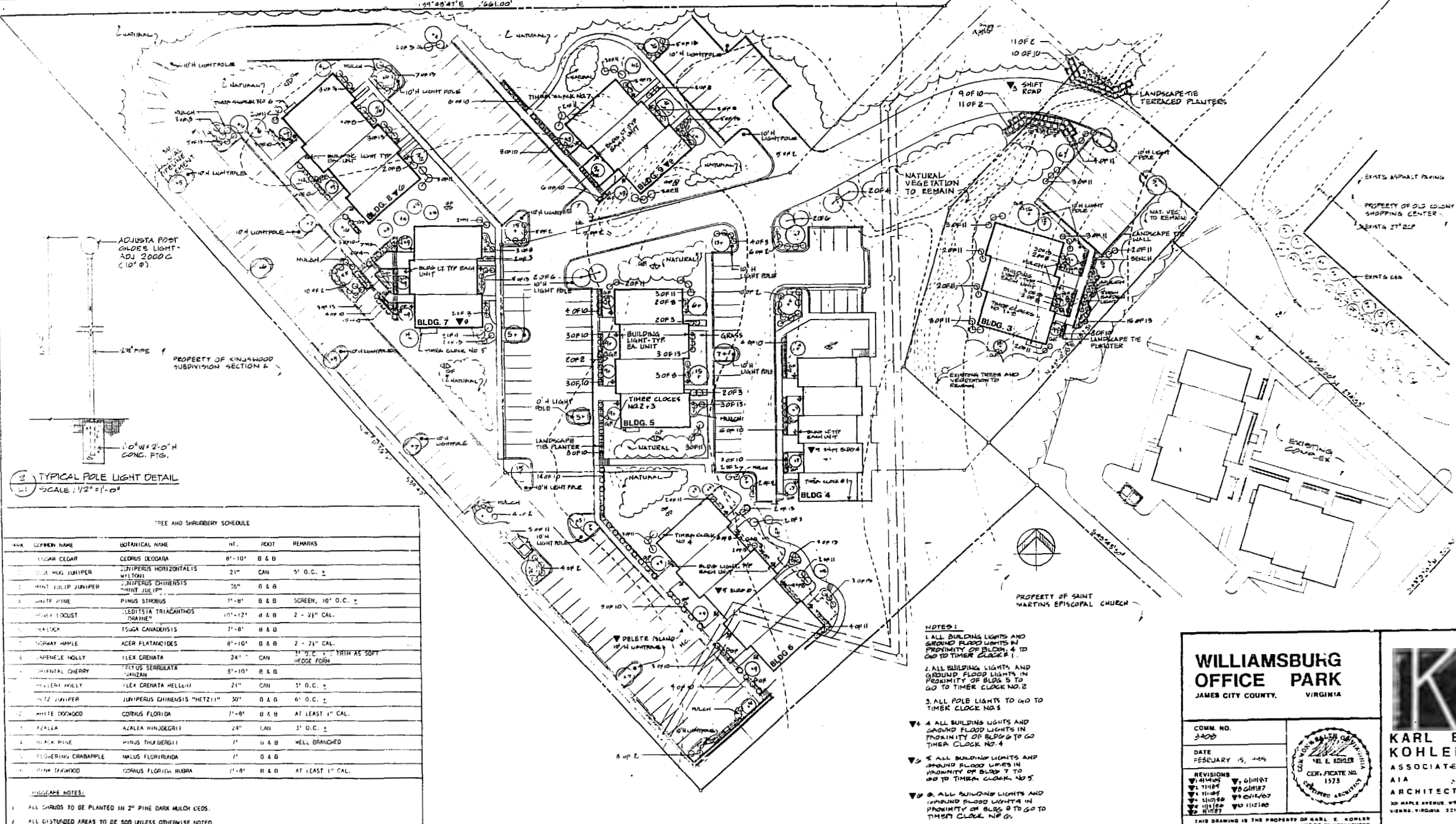

2 TYPICAL POLE LIGHT DETAIL
SCALE: 1/2" = 1'-0"

TREE AND SHRUBBERY SCHEDULE

TAXA	COMMON NAME	BOTANICAL NAME	HT.	FOOT	REMARKS
1	SUGAR CEDAR	CEDRUS CEDARA	8'-10'	B & B	
2	BLUE HOG JUNIPER	JUNIPERUS HORIZONTALIS	21"	CAN	5' O.C. ±
3	MINT JULEP JUNIPER	JUNIPERUS CHINENSIS	35"	B & B	
4	WHITE PINE	PINUS STROBUS	7'-8'	B & B	SCREEN, 10' O.C. ±
5	HONEY LOCUST	LEDISTIA TRIACANTHOS 'ORANGE'	10'-12'	d & B	2 - 21" CAL.
6	REARLOCK	ISOGA CANADENSIS	7'-8'	B & B	
7	ROADWAY MAPLE	ACER FLATLANDICES	8'-10'	B & B	2 - 21" CAL.
8	JAPANESE HOLLY	ILEX CRENATA	24"	CAN	3" O.C. ±; TRIM AS SOFT HEDGE FORM
9	ORIENTAL CHERRY	PALUS SERRULATA 'JANZAN'	8'-10'	B & B	
10	HOLLER HULLY	ILEX CRENATA HELLERII	21"	CAN	3' O.C. ±
11	WITZ JUNIPER	JUNIPERUS CHINENSIS 'WITZII'	30"	B & B	6' O.C. ±
12	WHITE DOGWOOD	CORNUS FLORIDA	7'-8'	B & B	AT LEAST 1" CAL.
13	AZALEA	AZALEA HINDJERGII	24"	CAN	3' O.C. ±
14	BLACK PINE	PINUS THURBERGII	7'	B & B	WELL BRANCHED
15	FLOWERING CRABAPPLE	MALUS FLORIFLORIDA	7'	B & B	
16	PINK DOGWOOD	CORNUS FLORIDA RUBRA	7'-8'	B & B	AT LEAST 1" CAL.

LANDSCAPE NOTES:
 1. ALL SHRUBS TO BE PLANTED IN 2" PINE DARK MULCH DECS.
 2. ALL DISTURBED AREAS TO BE SOO UNLESS OTHERWISE NOTED.
 3. THIS SHEET IS INTENDED FOR LANDSCAPE USE ONLY.

THESE PLANS ARE ACCURATE & ARE IN COMPLIANCE WITH SECTION 55-70.58 CODE OF VIRGINIA, AS AMENDED
 LANDSCAPING & LIGHTING PLAN
 SCALE: 1" = 30'-0"

- NOTES:
1. ALL BUILDING LIGHTS AND GROUND FLOOD LIGHTS IN PROXIMITY OF BLDG. 4 TO GO TO TIMER CLOCK NO. 1.
 2. ALL BUILDING LIGHTS AND GROUND FLOOD LIGHTS IN PROXIMITY OF BLDG. 5 TO GO TO TIMER CLOCK NO. 2.
 3. ALL POLE LIGHTS TO GO TO TIMER CLOCK NO. 3.
 4. ALL BUILDING LIGHTS AND GROUND FLOOD LIGHTS IN PROXIMITY OF BLDG. 6 TO GO TO TIMER CLOCK NO. 4.
 5. ALL BUILDING LIGHTS AND GROUND FLOOD LIGHTS IN PROXIMITY OF BLDG. 7 TO GO TO TIMER CLOCK NO. 5.
 6. ALL BUILDING LIGHTS AND GROUND FLOOD LIGHTS IN PROXIMITY OF BLDG. 8 TO GO TO TIMER CLOCK NO. 6.
 7. ALL BUILDING LIGHTS AND GROUND FLOOD LIGHTS IN PROXIMITY OF BLDG. 9 TO GO TO TIMER CLOCK NO. 7.

WILLIAMSBURG OFFICE PARK
JAMES CITY COUNTY, VIRGINIA

COMM. NO. 3400	
DATE FEBRUARY 15, 1995	
REVISIONS: 1. 4/14/95 2. 7/18/95 3. 8/1/95 4. 8/1/95 5. 8/1/95	6. 8/1/95 7. 8/1/95 8. 8/1/95 9. 8/1/95 10. 8/1/95

THIS DRAWING IS THE PROPERTY OF KARL E. KOHLER ASSOCIATES ARCHITECTS, AND IS NOT TO BE REPRODUCED OR USED FOR ANY PROJECT, IN WHOLE OR IN PART WITHOUT THEIR EXPRESS WRITTEN PERMISSION.

LANDSCAPING & LIGHTING PLAN

K

KARL E. KOHLER ASSOCIATES
AIA ARCHITECTS
30 MAPLE AVENUE, WEST
VIENNA, VIRGINIA 22180
PHONE: (703) 281-0301
FAX: (703) 281-1870

L1