

**NOTE:**

ALL IMPROVEMENTS FROM EXTERIOR WALLS OF BUILDING TO PROPERTY LINES ARE TO BE KNOWN AS COMMON ELEMENTS (INCLUDING CURB & GUTTER, PAVING, SIDEWALKS, LANDSCAPING, ETC.)

**NOTE:**

UNDERGROUND UTILITIES SERVING ADJACENT PROPERTIES ARE TO BE RECORDED AS CROSS EASEMENTS FOR INGRESS AND EGRESS ON ADJACENT PROPERTIES

**NOTE:**

ALL PAVED TRAVELWAYS & PARKING AREAS ARE TO BE RECORDED AS CROSS EASEMENTS FOR INGRESS AND EGRESS ON ADJACENT PROPERTIES

NOTE: 2' MIN. OF COVER SHALL BE MAINTAINED OVER SEWER LINE

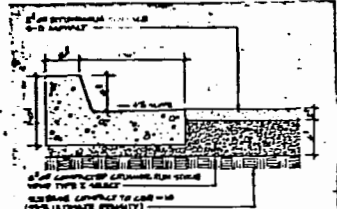

2 CURB & GUTTER AND PAVING DETAILS  
SCALE: N.T.S.

TABLE 1: SUMMARY OF BUILDING DATA

Building No.	Area (sq. ft.)	Volume (cu. ft.)	Height (ft.)	Notes
Building No. 1	11,322	10,258	30	
Building No. 2	7,400	6,144	23	
Building No. 3	9,900	7,987	32	
Building No. 4	7,400	6,144	23	

TABLE 2: PROPOSED CONCRETE

Building No.	Concrete (cu. yd.)	Reinforcing Steel (lbs.)
Building No. 1	3,740	11,210
Building No. 2	2,467	7,392
Building No. 3	3,193	9,579
Building No. 4	2,467	7,392

THESE PLANS ARE ACCURATE & ARE IN COMPLIANCE WITH SECTION 55-79.58 CODE OF VIRGINIA, AS AMENDED



1 SITE & GRADING PLAN  
SCALE: 1" = 50'-0"

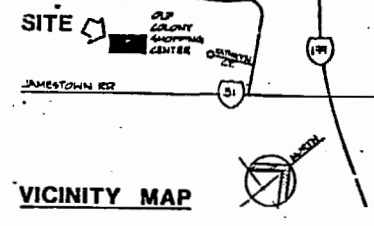
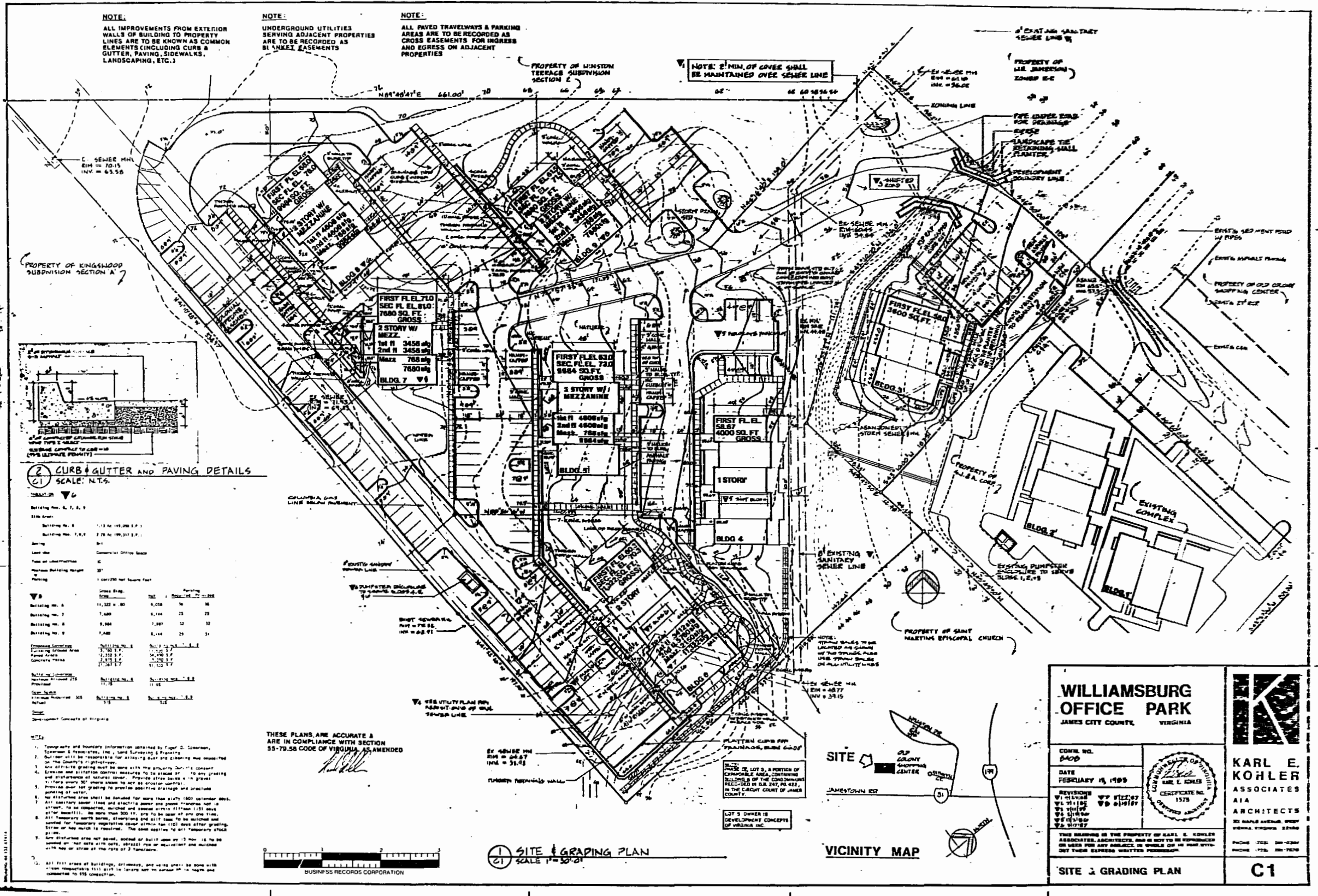

**WILLIAMSBURG OFFICE PARK**  
JAMES CITY COUNTY, VIRGINIA

CONTRACT NO. 8408	
DATE FEBRUARY 14, 1989	
REVISIONS: W1 11/88 W2 11/88 W3 11/88 W4 11/88 W5 11/88 W6 11/88	CERTIFICATE NO. 1578 EXPIRES 11/87

**KARL E. KOHLER ASSOCIATES AIA ARCHITECTS**  
80 HANCOCK AVENUE, SUITE 22100  
VIRGINIA BEACH, VIRGINIA 23464  
PHONE: (757) 381-2300  
FAX: (757) 381-7670

**SITE & GRADING PLAN**

**C1**