

SURVEYOR'S CERTIFICATE

I CERTIFY THAT THIS PLAT OF SUBDIVISION WAS MADE BY ME AT THE DIRECTION OF THE OWNER, AND THAT THE SUBDIVISION IS ENTIRELY WITHIN THE BOUNDARIES OF LAND COVERED BY DEED DULY OF RECORD IN THE CLERK'S OFFICE OF THE CIRCUIT COURT OF THE COUNTY OF JAMES CITY, VIRGINIA DEED OR PLAT BOOKS, DEED BOOK 251, AT PAGE 486, PLAT BOOK 6, AT PAGE 17

H. O. Freeman II
 H. O. FREEMAN II, LAND SURVEYOR

HEREBY CERTIFY THAT TO THE BEST OF MY KNOWLEDGE AND BELIEF, ALL OF THE REQUIREMENTS OF THE BOARD OF SUPERVISORS AND ORDINANCES OF THE COUNTY OF JAMES CITY, VIRGINIA, REGARDING THE PLATTING OF SUBDIVISIONS WITHIN THE COUNTY HAVE BEEN COMPLIED WITH
 GIVEN UNDER MY HAND THIS 30TH DAY OF JUNE, 1987.

H. O. Freeman II
 H. O. FREEMAN II, LAND SURVEYOR

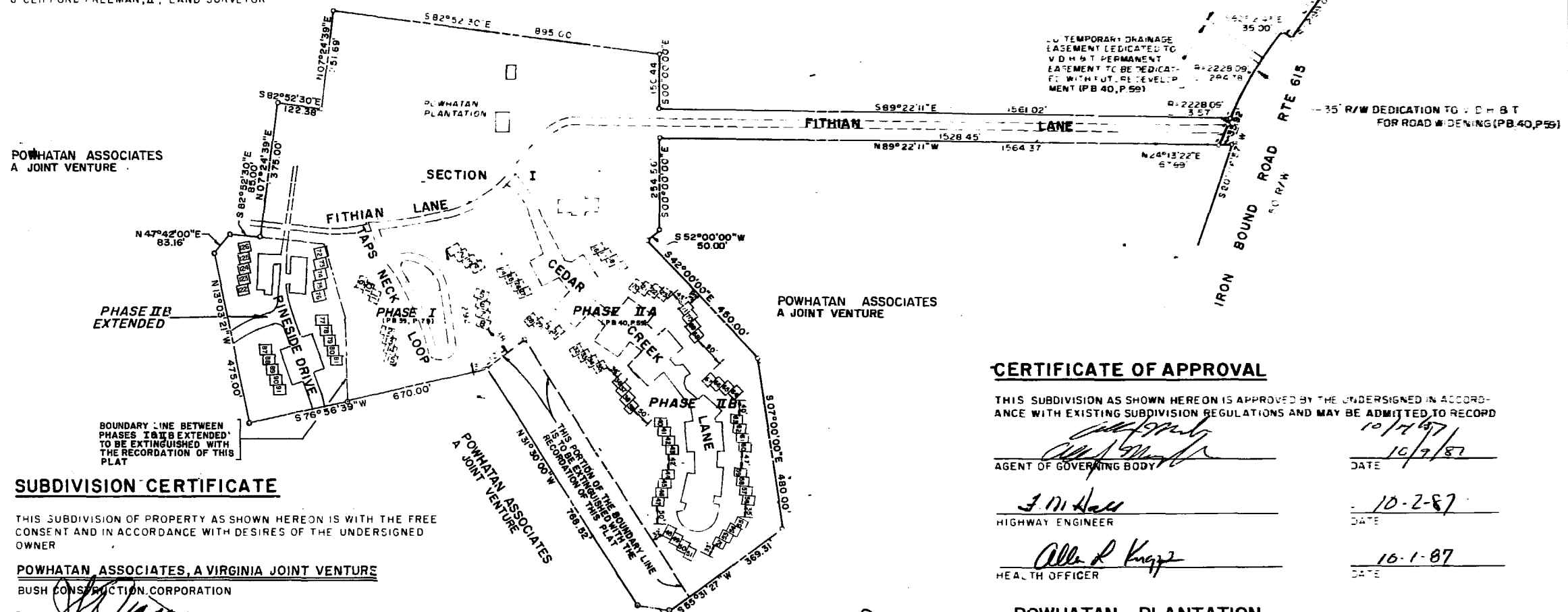
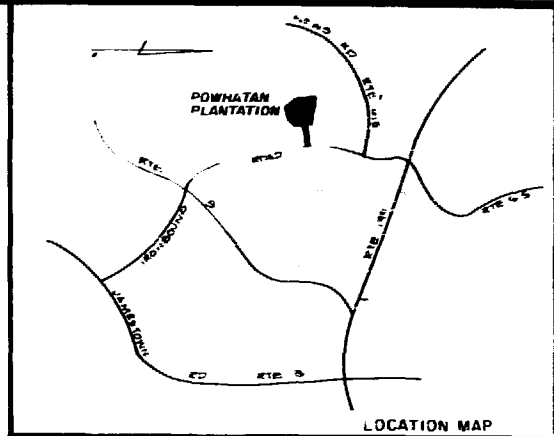

CERTIFICATE OF APPROVAL

THIS SUBDIVISION AS SHOWN HEREON IS APPROVED BY THE UNDERSIGNED IN ACCORDANCE WITH EXISTING SUBDIVISION REGULATIONS AND MAY BE ADMITTED TO RECORD

[Signature] 10/14/87
 AGENT OF GOVERNING BODY DATE
[Signature] 10/7/87
 DATE
 J. M. HARRIS 10-2-87
 HIGHWAY ENGINEER DATE
 Allen R. Kruger 10-1-87
 HEALTH OFFICER DATE

SUBDIVISION CERTIFICATE

THIS SUBDIVISION OF PROPERTY AS SHOWN HEREON IS WITH THE FREE CONSENT AND IN ACCORDANCE WITH DESIRES OF THE UNDERSIGNED OWNER

POWHATAN ASSOCIATES, A VIRGINIA JOINT VENTURE

BUSH CONSTRUCTION CORPORATION

BY: *[Signature]*
 JOHN J. DODGES, PRESIDENT

TOTAL AREA EMBRACED WITHIN SECTION I = 35.4980 ACRES.

STATE OF VIRGINIA, COUNTY OF JAMES CITY, TO WIT

... A NOTARY PUBLIC IN AND FOR THE COUNTY AND STATE AFORESAID DO HEREBY CERTIFY THAT THE PERSONS WHOSE NAMES ARE SIGNED TO THE FOREGOING WRITING HAVE ACKNOWLEDGED THE SAME BEFORE ME

GIVEN UNDER MY HAND AND SEAL THIS 30TH DAY OF JUNE, 1987.

NOTARY PUBLIC

STATE OF VIRGINIA, COUNTY OF JAMES CITY
 IN THE CLERK'S OFFICE OF THE CIRCUIT COURT FOR THE COUNTY OF JAMES CITY, THE MAP SHOWN HEREON WAS PRESENTED AND ADMITTED TO RECORD AS THE LAW DIRECTS

TESTE: *[Signature]* DATE: 10/9/87
 PLAT BOOK 46 65

POWHATAN PLANTATION

PHASE II B EXTENDED AND AMENDED BOUNDARY LINE FOR PHASE II A AND PHASE II B

JAMES CITY COUNTY, VIRGINIA
 SCALE 1" = 200' JUNE 30, 1987

FREEMAN & ASSOCIATES
 LAND SURVEYORS
 NORFOLK, VIRGINIA



2:35
 9/14 Oct 1987
 P.B. 265 Page 269
 TESTE: *[Signature]*
 Clerk