

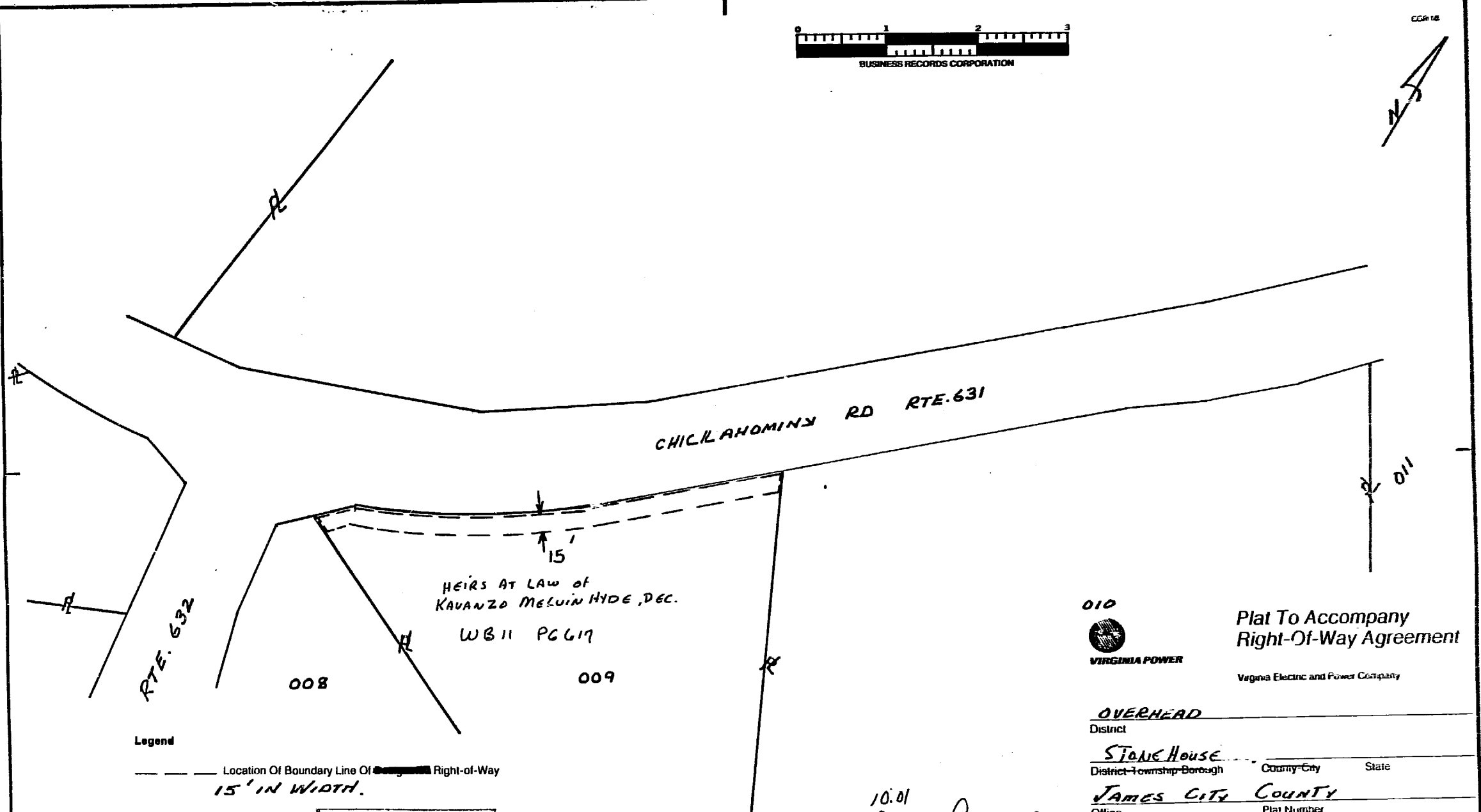

CGR 18



Legend

--- Location Of Boundary Line Of ~~Property~~ Right-of-Way
15' IN WIDTH.

OWNER'S INITIALS
[Handwritten Signature]

010



VIRGINIA POWER

**Plat To Accompany
Right-Of-Way Agreement**

Virginia Electric and Power Company

OVERHEAD

District	STONE HOUSE	
District-Township-Borough	County-City	State
Office	JAMES CITY COUNTY	
Plat Number	28-87-0008	
Estimate Number	2804469000	711640
Date	7-13-87	By <i>[Handwritten Signature]</i>

10.01
Recorded *2644* day of *August* 1987
in *732*
B. B. No. *359* Clerk
Halena C. Ward
By *Dawn B. Hart* Dep. Clerk