

LOCATION MAP
SCALE 1"=2 MILES

OWNER'S CONSENT & DEDICATION

THIS SUBDIVISION IS WITH THE FREE CONSENT AND IN ACCORDANCE WITH THE WISHES AND DESIRES OF THE UNDERSIGNED OWNERS AND PROPRIETORS.

TITLE TO LAND SHOWN HEREON IS VESTED IN REALTEC INCORPORATED, SUCCESSOR BY MERGER TO FORD'S COLONY AT WILLIAMSBURG, INC. BY DEED AS FOLLOWS:

DEED BOOK 324, PAGE 394, DATED DECEMBER 19, 1986

RECORDED IN THE CLERK'S OFFICE OF THE CIRCUIT COURT OF THE CITY OF WILLIAMSBURG AND COUNTY OF JAMES CITY, VIRGINIA.

BY *D. P. Price*
DATE *9/2/87*

STATE OF VIRGINIA.

I, *Paul C. Small* A NOTARY PUBLIC DO CERTIFY THAT THE PERSONS WHOSE NAMES ARE SIGNED TO THE FOREGOING WRITING HAVE ACKNOWLEDGED THE SAME BEFORE ME IN MY CITY AND STATE AFORESAID.
GIVEN UNDER MY HAND THIS *4* DATE OF *August*, 1987.
MY COMMISSION EXPIRES *Jan 23, 1989*

STATE OF VIRGINIA, COUNTY OF JAMES CITY:

IN THE CLERK'S OFFICE OF THE CIRCUIT COURT FOR THE COUNTY OF JAMES CITY THE *2* DAY OF *Sept*, 1987, THIS MAP WAS PRESENTED AND ADMITTED TO BE RECORDED AS THE LAW DIRECTS.

TESTE: *Paul C. Small* CLERK
PLAT BOOK *46*, PAGE *12, 13 & 14*

CERTIFICATE OF APPROVAL

THIS SUBDIVISION KNOWN AS FORD'S COLONY AT WILLIAMSBURG, THE IS APPROVED BY THE UNDERSIGNED IN ACCORDANCE WITH EXISTING SUBDIVISION REGULATIONS AND MAY BE COMMITTED TO RECORD.

DATE *8-4-87* HEALTH OFFICER *D. P. Price*
DATE *9/2/87* AGENT OF GOVERNING BODY *[Signature]*

ENGINEER'S & SURVEYOR'S CERTIFICATE

I CERTIFY THAT THIS PLAT AND SUBDIVISION WAS MADE BY MYSELF AT THE DIRECTION OF THE OWNER, AND THAT THE SUBDIVISION IS ENTIRELY WITHIN THE BOUNDARIES OF LAND COVERED BY DEEDS DULY OF RECORD IN THE CLERK'S OFFICE OF THE CIRCUIT COURT OF JAMES CITY COUNTY, VIRGINIA IN THE AFOREMENTIONED DEED BOOKS.

THIS SUBDIVISION AS IT APPEARS ON THIS PLAT CONFORMS TO THE APPLICABLE REGULATIONS RELATING TO THE SUBDIVISION OF LAND.

GIVEN UNDER MY HAND THIS *26* DAY OF *August*, 1987.
BY: *Paul C. Small*
PAUL C. SMALL, D.E., C.L.S.

NOTE: FOR PURPOSES OF COMPLIANCE WITH BUILDING LOCATION REQUIREMENTS PURSUANT TO SECTION 20-80 OF JAMES CITY COUNTY ZONING ORDINANCE, BUILDING RESTRICTION LINES, CONSTRUCTION AREA LIMITS, AND SETBACK LINE, REFERRED TO THEREIN ARE HEREBY COINCIDENT WITH THE LOT PROPERTY LINES. OWNERS AND BUILDERS ARE REFERRED TO THE "DECLARATION OF RESTRICTIVE COVENANTS, SECTION II LOT 68-117 FORD'S COLONY AT WILLIAMSBURG" FOR ADDITIONAL BUILDING RESTRICTIONS AND REGULATIONS IMPOSED BY THE DEVELOPER AND OR HIS ASSIGNS.

DEVELOPMENT NOTES

1. PROPERTY IS ZONED "R-4" RESIDENTIAL PLANNED COMMUNITY.
2. ALL LOTS ARE TO BE PROVIDED WITH WATER AND SEWER SERVICE BY THE JAMES CITY SERVICE AUTHORITY.
3. ALL STREETS ARE TO BE PRIVATELY OWNED AND MAINTAINED.
4. ALL LOTS ARE WITHIN THE ORIGINAL BOUNDARY SURVEY OF RECORD.

AREA TABULATION

TOTAL AREA OF RESIDENTIAL LOTS	1,136,928 SF	26.100 AC+
TOTAL AREA OF R/W'S	405,808 SF	9.316 AC+
TOTAL AREA OF GREENWAYS	58,262 SF	1.338 AC+
TOTAL AREA OF SECTION VI, LOTS 68 TO 117	1,600,978 SF	36.754 AC+
NUMBER OF LOTS	50	
AVERAGE AREA OF LOTS	22,739 SF	0.522 AC+
GROSS LOTS PER ACRE	1.36 LOTS/GROSS ACRE	

INDEX TO PLAT SHEETS

- COVER SHEET - SHEET 1 OF 3
- LOT 68 TO LOT 86 - SHEET 2 OF 3
- LOT 87 TO LOT 117 - SHEET 3 OF 3

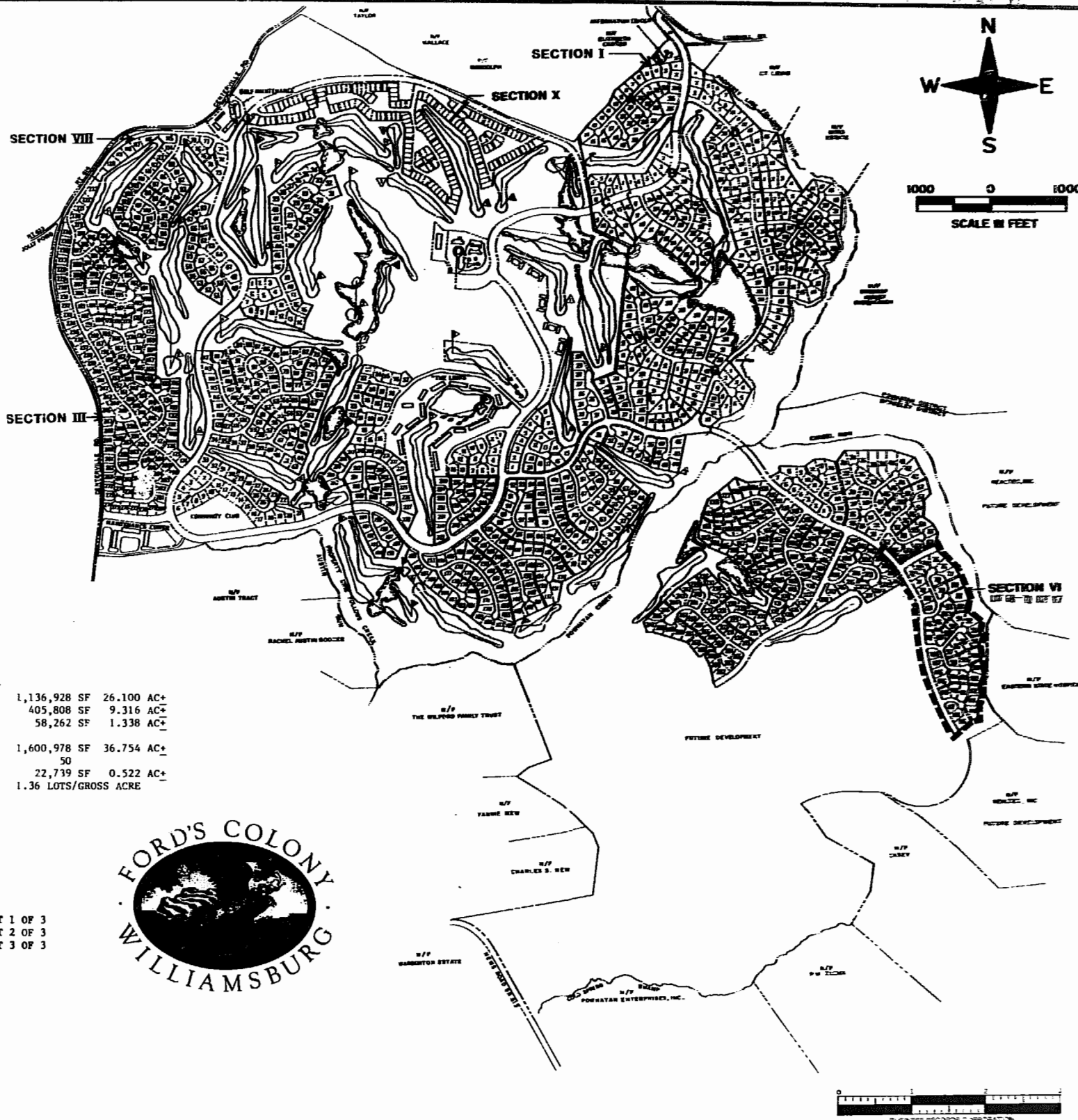

AES, a professional corporation
1761 Jamestown Road, Williamsburg, Va. 23185
804-253-0040
Engineering. Planning. Surveying

PLAT OF FORD'S COLONY @ WILLIAMSBURG
SECTION VI
LOT 68 TO LOT 117
BERKELEY DISTRICT JAMES CITY COUNTY VIRGINIA



NO.	DATE	REVISION	COMMENT	NOTE

Designed	Drawn
LCA/AES	BB
Scale	Date
NOTED	JULY 30, 1987
PROJECT NO.	
5652	
SHEET NO.	
1 of 3	