

BUSINESS RECORDS CORPORATION

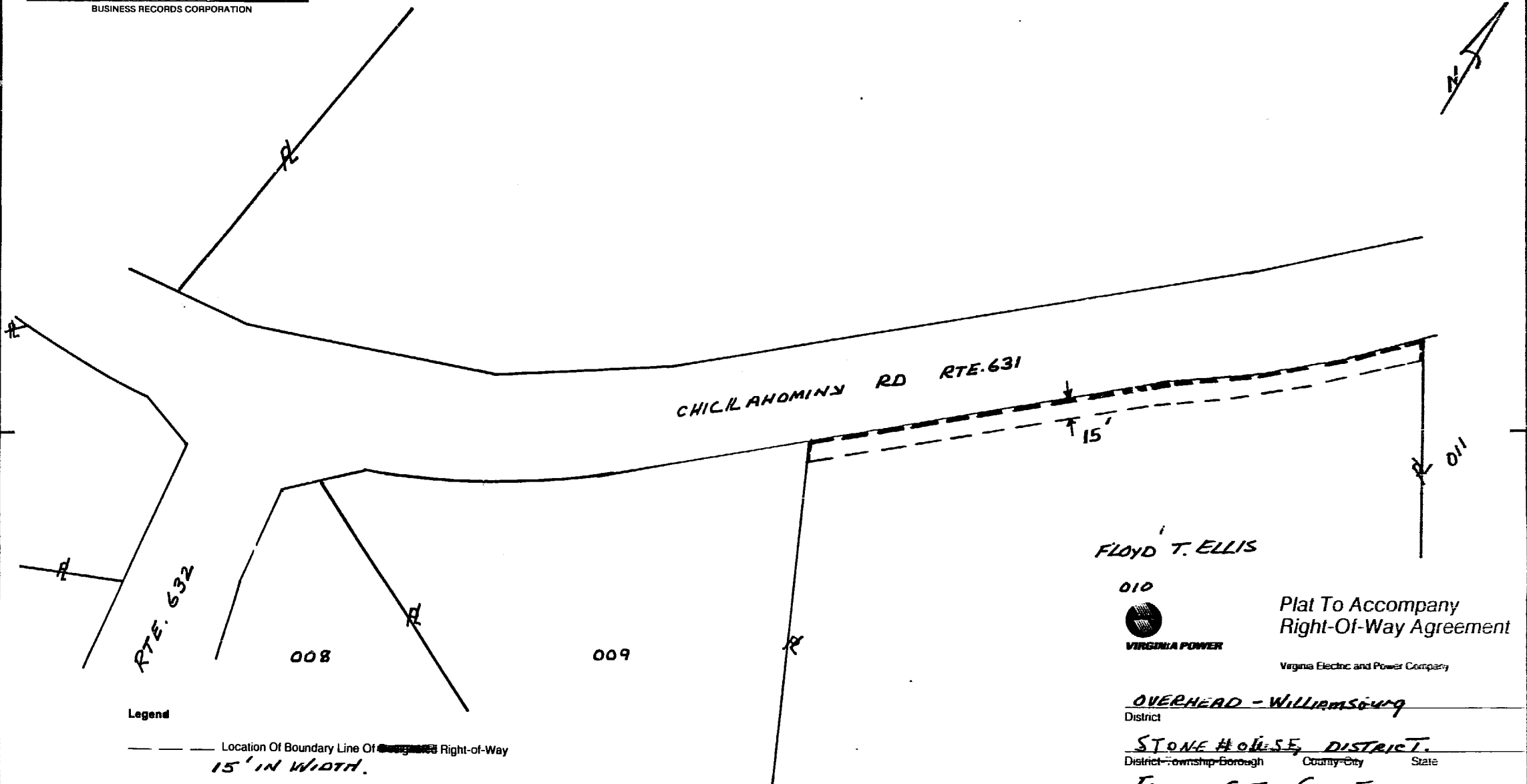

Legend

--- Location Of Boundary Line Of ~~15'~~ Right-of-Way
15' IN WIDTH.

OWNER'S INITIALS
F.T.E

No 97556910
Rev A

3

CHICKLAHOMINY RD RTE. 631

RTE. 632

008

009

FLOYD T. ELLIS

010



VIRGINIA POWER

Plat To Accompany
Right-Of-Way Agreement

Virginia Electric and Power Company

OVERHEAD - WILLIAMSBURG
District

STONE HOUSE, DISTRICT.
District-Township-Borough County-City State

JAMES CITY COUNTY

Office Plat Number

Norfolk 28-87-0009

Estimate Number Grd Number

1804469000 711640

Date By
7-9-87 R. L. P. [Signature]

Recorded 9:09 AM
2nd day of August, 1987

P. B. No. 385 in pages 331

Hobbes S. Ward Clerk
By: Dawn R. [Signature]