

FIRST FLOOR

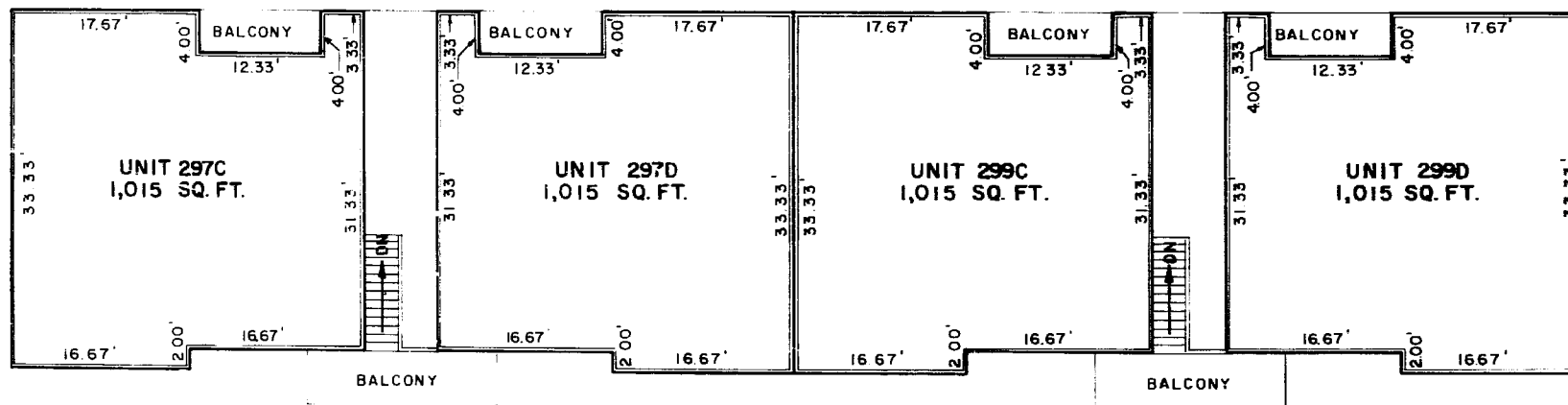

SECOND FLOOR

BUILDING No. 297

BUILDING No. 299

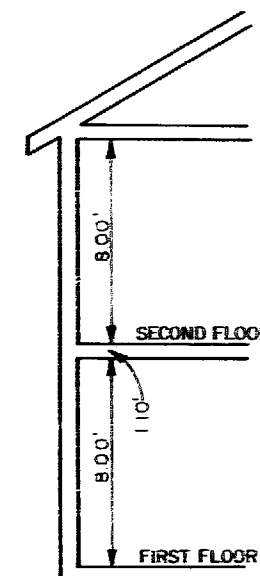

BUILDING ELEVATIONS
NTS.

FOR FINISHED FLOOR ELEVATION OF PARTICULAR BUILDING SEE SHEET

NOTE: DIMENSIONS SHOWN ARE ON FINISHED SURFACES AND MAY VARY ± 2".
DIMENSIONS SHOWN BASED ON ARCHITECTURAL PLANS PROVIDED BY THE DEVELOPER.

CERTIFICATION:
I, THE UNDERSIGNED ENGINEER HEREBY CERTIFY THAT THIS PLAN IS ACCURATE AND COMPLIES WITH SECTION 55-79.58(b) OF THE CODE OF VIRGINIA AND ALL UNITS DEPICTED HEREON HAVE BEEN SUBSTANTIALLY COMPLETED."

SIGNED: *[Signature]* DATE: 9/1/86



CONDOMINIUM PLAN
OF
BUILDING No. 297 & BUILDING No. 299
PATRIOT LANE CONDOMINIUM

WILLIAMSBURG VIRGINIA
SCALE: 1" = 10' APRIL 23, 1986

MILLER-FOX-STEPHENSON P.C.
ENGINEERS-SURVEYORS-PLANNERS
204 GRAYSON ROAD, VIRGINIA BEACH, VA. 23462

EXHIBIT B SHEET 5 OF 5

