

CEDAR GROVE GEMETERY

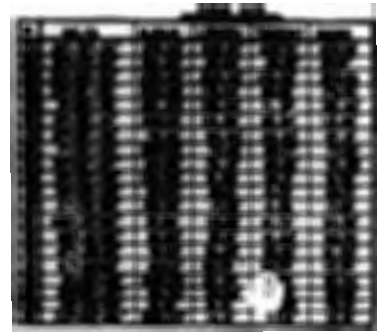

**LEGEND**

	WATERMAIN		FIRE HYDRANT
	TEE BEND		SAN. SEWER MANHOLE
	VALVE		CLEANOUT
	FIRE HYDRANT		SAN. FORCE MAIN
	SAN. SEWER MANHOLE		STORM SEWER
	CLEANOUT		ST. SEWER MANHOLE
	SAN. FORCE MAIN		DROP OR CATCH INLET
	STORM SEWER		SEWER LATERAL
	ST. SEWER MANHOLE		TOP OF CURVE ELEV.
	DROP OR CATCH INLET		RIGHT OF WAY LINE
	SEWER LATERAL		PROPERTY LINE
	TOP OF CURVE ELEV.		SPOT ELEV. PROPOSED GRADING
	RIGHT OF WAY LINE		SAN. SEWER VERTICAL RISE
	PROPERTY LINE		WATER SERVICE CONNECTION WITH TAP AND CURB STOP
	SPOT ELEV. PROPOSED GRADING		STRUCTURE NUMBER
	SAN. SEWER VERTICAL RISE		SHEET NUMBER
	WATER SERVICE CONNECTION WITH TAP AND CURB STOP		DENOTES BORE LOCATION AND NUMBER
	STRUCTURE NUMBER		CALIFORNIA BEARING RATIO

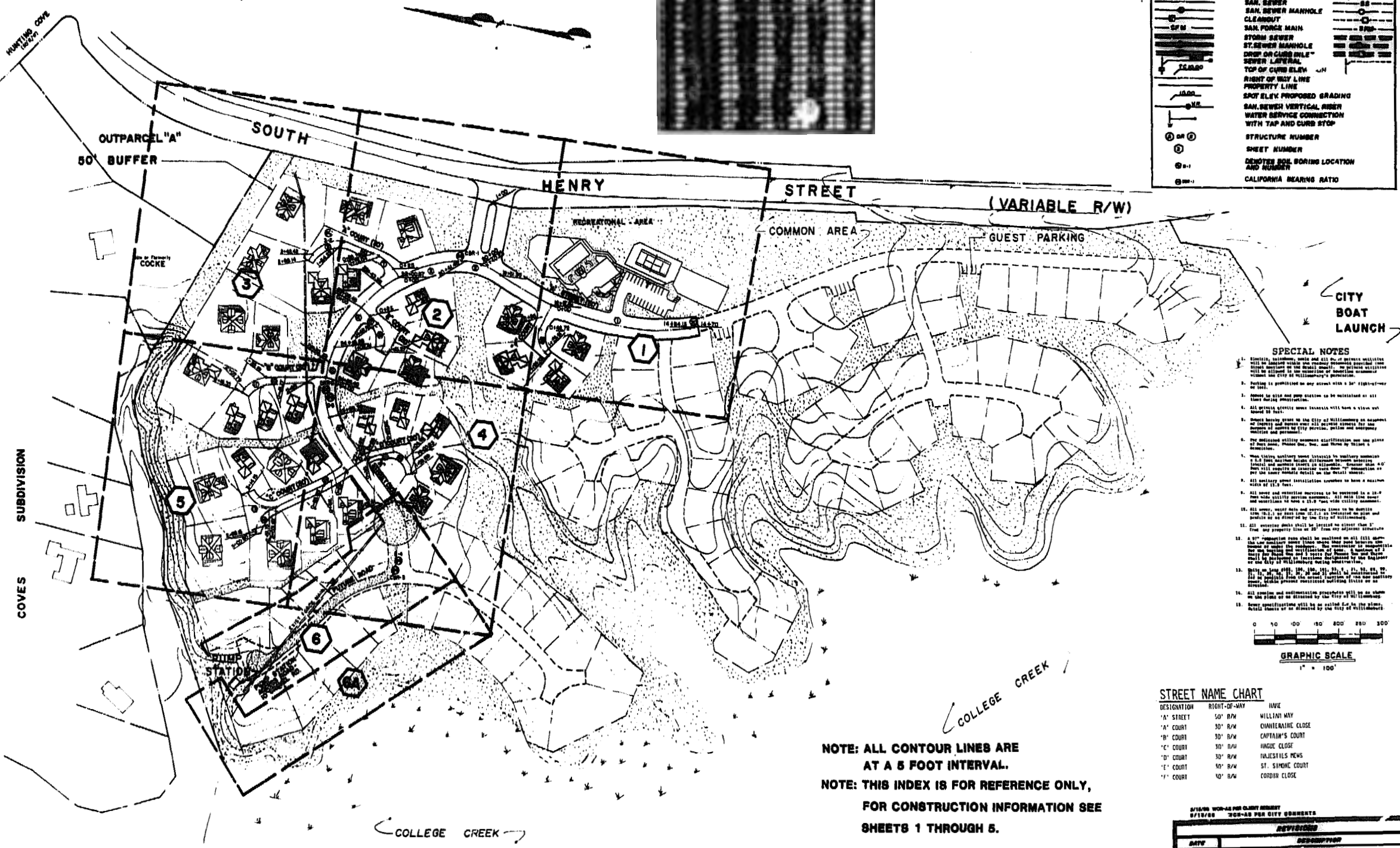

- SPECIAL NOTES**
1. Utilities, easements, and all other property boundaries shall be shown on this plan. The owner shall provide all necessary information for the City of Williamsburg to verify the accuracy of the information provided.
  2. Nothing is prohibited on any street with a 30' right-of-way or less.
  3. Access to site and pump station to be maintained at all times during construction.
  4. All utility structures shall have a 3' x 3' x 3' minimum clearance for the installation of utility structures.
  5. All utility structures shall be installed in a 30' x 30' x 30' minimum clearance for the installation of utility structures.
  6. All utility structures shall be installed in a 30' x 30' x 30' minimum clearance for the installation of utility structures.
  7. All utility structures shall be installed in a 30' x 30' x 30' minimum clearance for the installation of utility structures.
  8. All utility structures shall be installed in a 30' x 30' x 30' minimum clearance for the installation of utility structures.
  9. All utility structures shall be installed in a 30' x 30' x 30' minimum clearance for the installation of utility structures.
  10. All utility structures shall be installed in a 30' x 30' x 30' minimum clearance for the installation of utility structures.
  11. All utility structures shall be installed in a 30' x 30' x 30' minimum clearance for the installation of utility structures.
  12. All utility structures shall be installed in a 30' x 30' x 30' minimum clearance for the installation of utility structures.
  13. All utility structures shall be installed in a 30' x 30' x 30' minimum clearance for the installation of utility structures.
  14. All utility structures shall be installed in a 30' x 30' x 30' minimum clearance for the installation of utility structures.
  15. All utility structures shall be installed in a 30' x 30' x 30' minimum clearance for the installation of utility structures.
  16. All utility structures shall be installed in a 30' x 30' x 30' minimum clearance for the installation of utility structures.
  17. All utility structures shall be installed in a 30' x 30' x 30' minimum clearance for the installation of utility structures.
  18. All utility structures shall be installed in a 30' x 30' x 30' minimum clearance for the installation of utility structures.
  19. All utility structures shall be installed in a 30' x 30' x 30' minimum clearance for the installation of utility structures.
  20. All utility structures shall be installed in a 30' x 30' x 30' minimum clearance for the installation of utility structures.

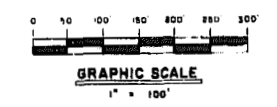

**STREET NAME CHART**

DESIGNATION	RIGHT-OF-WAY	NAME
'A' STREET	50' R/W	WILLIAM WAY
'A' COURT	50' R/W	CHARLENE CLOSE
'B' COURT	50' R/W	CAPTAIN'S COURT
'C' COURT	50' R/W	HAGUE CLOSE
'D' COURT	50' R/W	MAJESTIC NEWS
'E' COURT	50' R/W	ST. SIMON COURT
'F' COURT	50' R/W	CORDIN CLOSE

**NOTE: ALL CONTOUR LINES ARE AT A 5 FOOT INTERVAL.**  
**NOTE: THIS INDEX IS FOR REFERENCE ONLY, FOR CONSTRUCTION INFORMATION SEE SHEETS 1 THROUGH 5.**

DESIGNED: WCR/CPL  
 DRAWN: MJP  
 CHECKED: ADS  
 SCALE: 1" = 100'  
 DATE: 2-26-85  
 FILE NO: E-174019  
 PROJECT NO: 84019  
 SHEET NO:

DATE	DESCRIPTION
2-12-85	AMS - REVISED PER CITY COMMENTS
4-24-85	AMS - REVISED PER CITY & CLIENT COMMENTS
5-10-85	AMS - REVISED PER FINAL CITY COMMENTS
12-30-85	AMS - REVISED PER FINAL CITY COMMENTS
12-30-85	AMS - REVISED PER FINAL CITY COMMENTS

10' 20' 30' 40' 50' 60' 70' 80' 90' 100' 110' 120' 130' 140' 150' 160' 170' 180' 190' 200' 210' 220' 230' 240' 250' 260' 270' 280' 290' 300' 310' 320' 330' 340' 350' 360' 370' 380' 390' 400' 410' 420' 430' 440' 450' 460' 470' 480' 490' 500' 510' 520' 530' 540' 550' 560' 570' 580' 590' 600' 610' 620' 630' 640' 650' 660' 670' 680' 690' 700' 710' 720' 730' 740' 750' 760' 770' 780' 790' 800' 810' 820' 830' 840' 850' 860' 870' 880' 890' 900' 910' 920' 930' 940' 950' 960' 970' 980' 990' 1000'