

PERMANENT EASEMENT = 0.28 acres
CONSTRUCTION EASEMENT = 0.28 acres

WILLIAMSBURG LANDING INC.
D.B. 246 Pg. 116

NOTE: CONSTRUCTION PLANS
JAMES TERRACE WATER
TRANSMISSION MAIN SHEET 29 OF 26

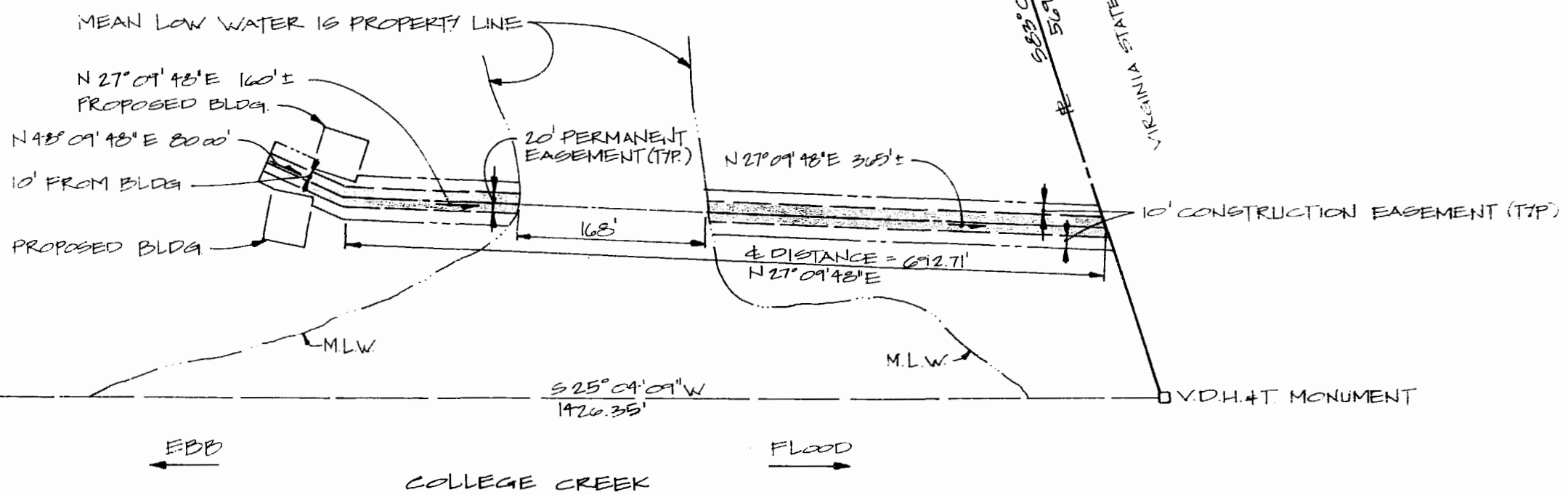

VIRGINIA STATE ROUTE 199 (LIMITED ACCESS),
R/W VARIES
D.B. 151 Pg. 397
D.B. 53 Pg. 709

CEGG THE CEGG PARTNERSHIP
ARCHITECTS & ENGINEERS
CORPORATE CENTER TWO, SUITE 240
VIRGINIA BEACH, VA. 23462
804 499 4562

**PLAT SHOWING
WATERLINE EASEMENT**

TO: JAMES CITY SERVICE
AUTHORITY

FROM: WILLIAMSBURG
LANDING INC.

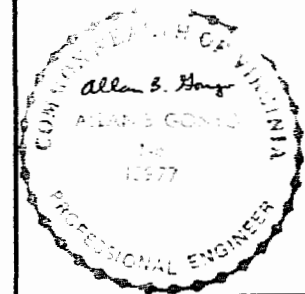

COMM. NO. 4012
SCALE 1" = 100'
DATE AUG 15, 1984
DWN. BY DPN
CKD. BY ABG

Recorded 17th day of December 1985
3:08 P.M.
P. B. No. 290
Allen Sward Clerk

