

NOTE:
UNDERGROUND UTILITIES SERVING ADJACENT PROPERTIES ARE TO BE RECORDED AS BLANKET EASEMENTS

NOTE:
ALL PAVED TRAVELWAYS & PARKING AREAS ARE TO BE RECORDED AS CROSS EASEMENTS FOR INGRESS AND EGRESS ON ADJACENT PROPERTIES

NOTE:
ALL IMPROVEMENTS FROM EXTERIOR WALLS OF BUILDING TO PROPERTY LINES ARE TO BE KNOWN AS COMMON ELEMENTS INCLUDING CURB & GUTTER, PAVING, SIDEWALKS, LANDSCAPING, ETC.
MECHANICAL UTILITIES ARE LIMITED COMMON ELEMENTS

NOTE: A MIN OF 66 TREES WILL REMAIN IN THE PERIMETER OF THE PROPERTY SHOWN ON THIS SITE IN ACCORDANCE W/ SECTION 20-55 OF THE ZONING ORDINANCE

PHASE 2, LOT NO. 3, A PORTION OF THE EXPANDABLE AREA OF THE CONDOMINIUM RECORDED IN DEED BOOK - NO. 247 PAGE 422 IN THE CIRCUIT COURT OF JAMES CITY COUNTY, VIRGINIA
LOT NO. 3, OWNER - DEVELOPMENT CONCEPTS OF VIRGINIA

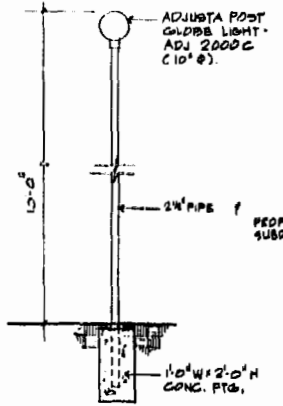
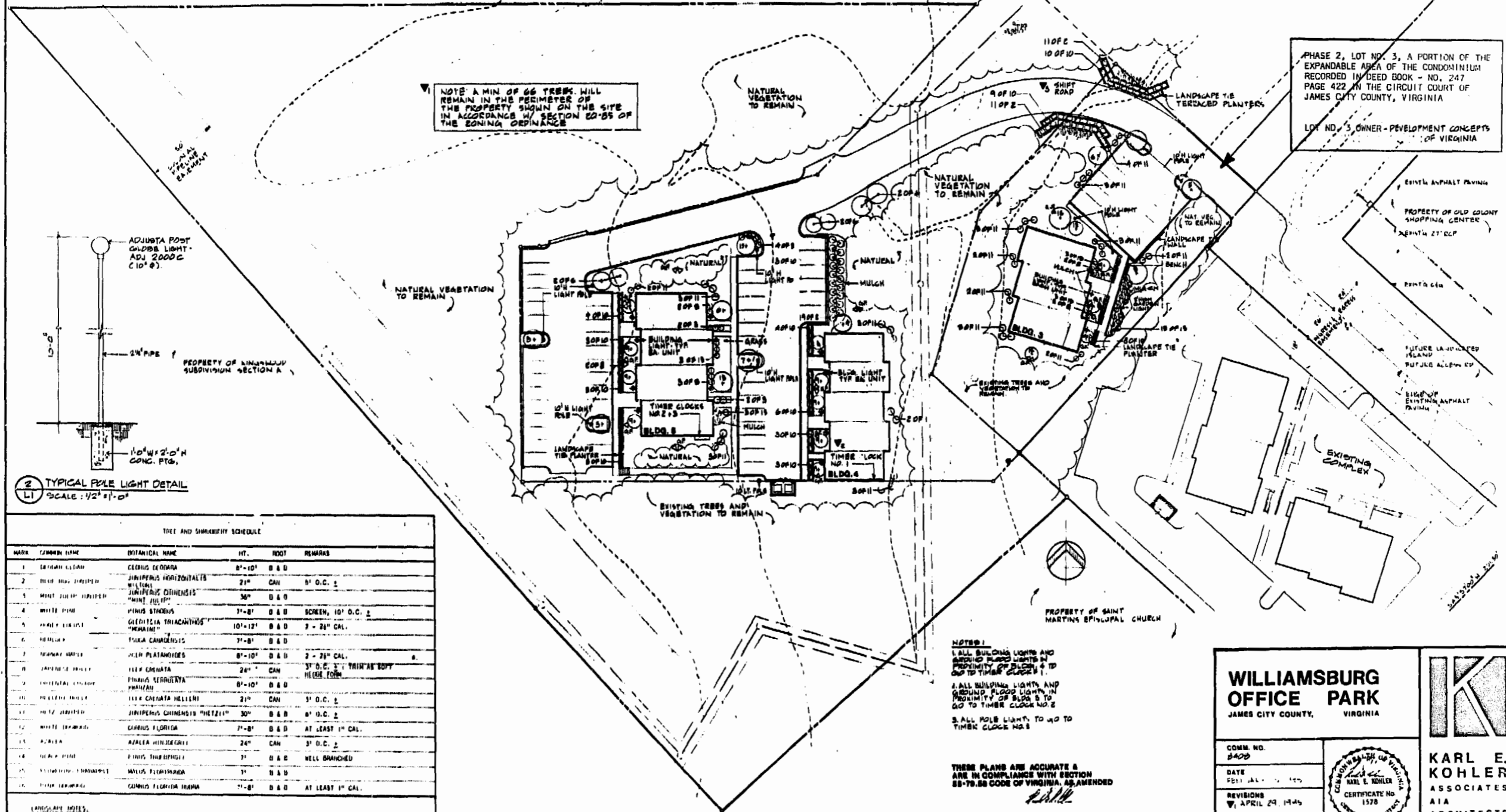

2 TYPICAL POLE LIGHT DETAIL
L1 SCALE: 1/2" = 1'-0"

TREE AND SHRUBBITY SCHEDULE

NO.	COMMON NAME	BOTANICAL NAME	HT.	ROOT	REMARKS
1	CELEBRATION CEDAR	CELEBRATION CEDAR	8'-10'	B & D	
2	BLUE HOLE SPRUCE	JUNIPERUS HORIZONTALIS	21"	CAN	5' O.C. ±
3	MINI JUNIPER	JUNIPERUS CHINENSIS	30"	B & D	
4	WHITE FERN	ADiantum SPECIOSUM	7'-8'	B & D	SCREEN, 10' O.C. ±
5	SPRING BURNING	GLADIOLUS TRIACANTHUS	10'-12'	B & D	7 - 24" CAL.
6	HELMHOLD	TRIFOLIUM ALPENSIS	7'-8'	B & D	
7	TRIMMED MAPLE	ACER PLATANIFOLIUM	8'-10'	B & D	2 - 24" CAL.
8	SPRING BURNING	GLADIOLUS TRIACANTHUS	24"	CAN	3' O.C. ± TRIM AS SOFT HELMOLD FORM
9	SPRING BURNING	GLADIOLUS TRIACANTHUS	8'-10'	B & D	
10	SPRING BURNING	GLADIOLUS TRIACANTHUS	21"	CAN	3' O.C. ±
11	SPRING BURNING	JUNIPERUS CHINENSIS "HEZZEL"	30"	B & D	4' O.C. ±
12	WHITE BURNING	CORNUS FLORIDA	7'-8'	B & D	AT LEAST 1" CAL.
13	SPRING BURNING	ADiantum SPECIOSUM	24"	CAN	3' O.C. ±
14	SPRING BURNING	ADiantum SPECIOSUM	7'	B & D	WELL BRANCHED
15	SPRING BURNING	ADiantum SPECIOSUM	7'	B & D	
16	SPRING BURNING	CORNUS FLORIDA TRIMMA	7'-8'	B & D	AT LEAST 1" CAL.

- LANDSCAPE NOTES:
- ALL SHRUBS TO BE PLANTED IN 2" FINE DARK MULCH BEDS.
 - ALL DISTURBED AREAS TO BE SOG UNLESS OTHERWISE NOTED.
 - THIS SHEET IS INTENDED FOR LANDSCAPE USE ONLY.

NOTES:
1. ALL BUILDING LIGHTS AND GROUND FLOOD LIGHTS IN PROXIMITY OF BLDG. 1 TO GO TO TIMBER CLOCK NO. 1
2. ALL BUILDING LIGHTS AND GROUND FLOOD LIGHTS IN PROXIMITY OF BLDG. 2 TO GO TO TIMBER CLOCK NO. 2
3. ALL POLE LIGHTS TO GO TO TIMBER CLOCK NO. 3

THESE PLANS ARE ACCURATE & ARE IN COMPLIANCE WITH SECTION 55-79.58 CODE OF VIRGINIA, AS AMENDED
[Signature]

1 LANDSCAPING & LIGHTING PLAN
L1 SCALE: 1" = 50'-0"

WILLIAMSBURG OFFICE PARK
JAMES CITY COUNTY, VIRGINIA

COMM. NO. 8400
DATE FEB 14, 1985
REVISIONS
1 APRIL 29, 1985
2 JULY 1, 1985
3 JULY 11, 1985

THIS DRAWING IS THE PROPERTY OF KARL E. KOHLER ASSOCIATES ARCHITECTS AND IS NOT TO BE REPRODUCED OR USED FOR ANY PROJECT IN WHOLE OR IN PART WITHOUT THEIR EXPRESS WRITTEN PERMISSION

LANDSCAPING & LIGHTING PLAN

KARL E. KOHLER ASSOCIATES AIA ARCHITECTS
200 MAPLE AVENUE, WEST VIRGINIA 22160
PHONE (703) 281-0311
FAX (703) 281-1670

2.05 PM
B. B. 281-281
10/15/85