

PROJECT BENCHMARK
MANHOLE RIM
ELEVATION = 34.15
INVERT = 26.53

CERTIFICATION

THE UNDERSIGNED REGISTERED LAND SURVEYOR AND ENGINEER CERTIFIES THAT HE HAS READ VIRGINIA CODE 55-79.58 (a) AND (b) AND FINDS THESE PLATS/PLANS TO BE ACCURATE AND IN COMPLIANCE WITH THE CODE. HE FURTHER CERTIFIES THAT ALL UNITS OR PORTIONS THEREOF DEPICTED HAVE BEEN SUBSTANTIALLY COMPLETED.

SIGNED: W.S. Miller, Jr.
SURVEYOR
SIGNED: Paul C. Small
ENGINEER

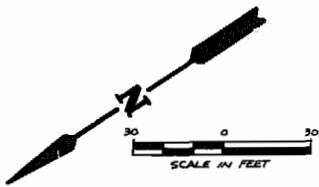

THIS SITE PLAN OF ALBEMARLE CONDOMINIUM CONSTITUTES A TRUE AND ACCURATE REPRESENTATION OF THE UNITS DESCRIBED AND SHOWN HEREON AND THEREBY CAN BE DETERMINED THEREFROM THE IDENTITY, SIZE, AND THE LOCATION OF THE COMMON ELEMENTS AND THE UNITS.

I HEREBY CERTIFY THAT THIS PLAN IS ACCURATE AND THAT IT COMPLIES WITH THE PROVISIONS OF THE CODE OF VIRGINIA OF 1950, AS AMENDED, SECTION 55-79.58 AND I FURTHER CERTIFY THAT THE CONSTRUCTION OF THE UNITS IS SUBSTANTIALLY COMPLETE.

SIGNED: Paul C. Small
ENGINEER
DATE: 5-21-85

SIGNED: W.S. Miller, Jr.
Surveyor
DATE: 5-21-85



ALBEMARLE DRIVE

ALBEMARLE DRIVE

ALBEMARLE DRIVE

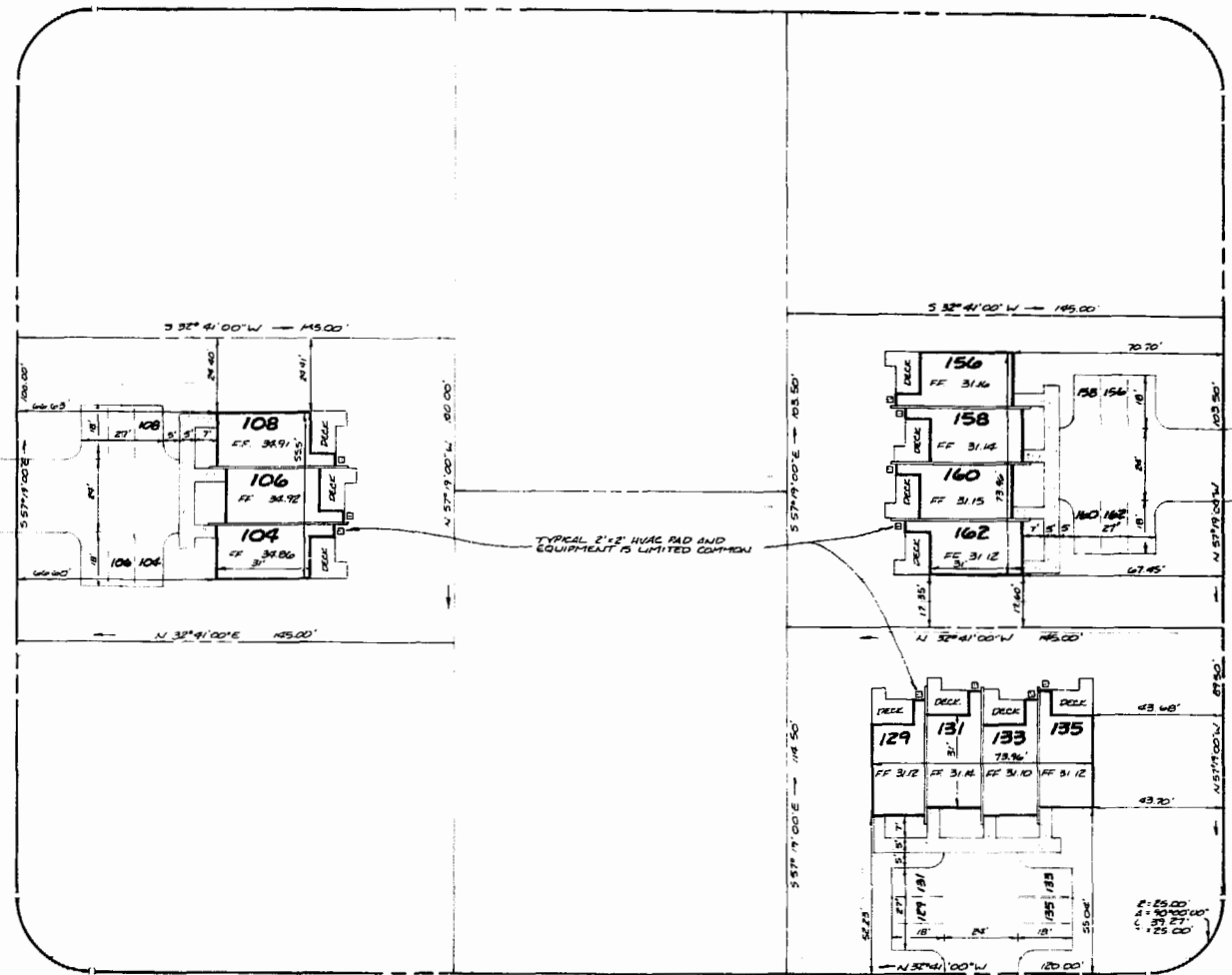

RALEIGH STREET

PLAT PREPARED BY
P.E. NO. 340
JHB
Date: 5/21/85
Drawing No. 5853

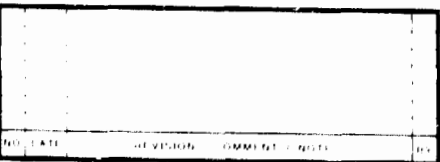

AES, a professional corporation
1761 Jamestown Road
Williamsburg, Virginia, 23185
804-253-0040
Engineering, Planning, Surveying



SITE PLAN
ALBEMARLE CONDOMINIUM
PREPARED FOR: JOSEPH S. TERRELL, INC.
JAMESTOWN DISTRICT JAMES CITY COUNTY VIRGINIA

Drawn by: JHB
Checked by: VMB
Date: 17 FEB 1985
Drawing No. 5853
3

