

ROAD CENTERLINE DATA

NO.	BEGINNING (STATIONING)	ENDPOINT (DISTANCE)	ARC LENGTH	CHORD LENGTH
1	0+00.00	48.00		
2	48.00	106.75	115.00	110.05
3	106.75	147.85	80.85	80.53
4	147.85	188.77		
5	188.77	248.80	80.50	80.50
6	248.80	278.79	82.98	83.31
7	278.79	35.00		
8	35.00	103.52	80.50	79.68
9	103.52	160.15	80.91	80.63
10	160.15	23.98		

1" BIT CONC TYPE B-3 SURFACE COURSE
6" AGG. BASE COURSE TYPE B1-A

SCALE
1/8" = 1'-0"

TYPICAL SECTION: ROUTE 31
(NOT TO SCALE)

BIT CONC TYPE B-3 SURFACE COURSE 1 1/2" (1 1/2") THK
6" BIT CONC TYPE B-3 BASE COURSE

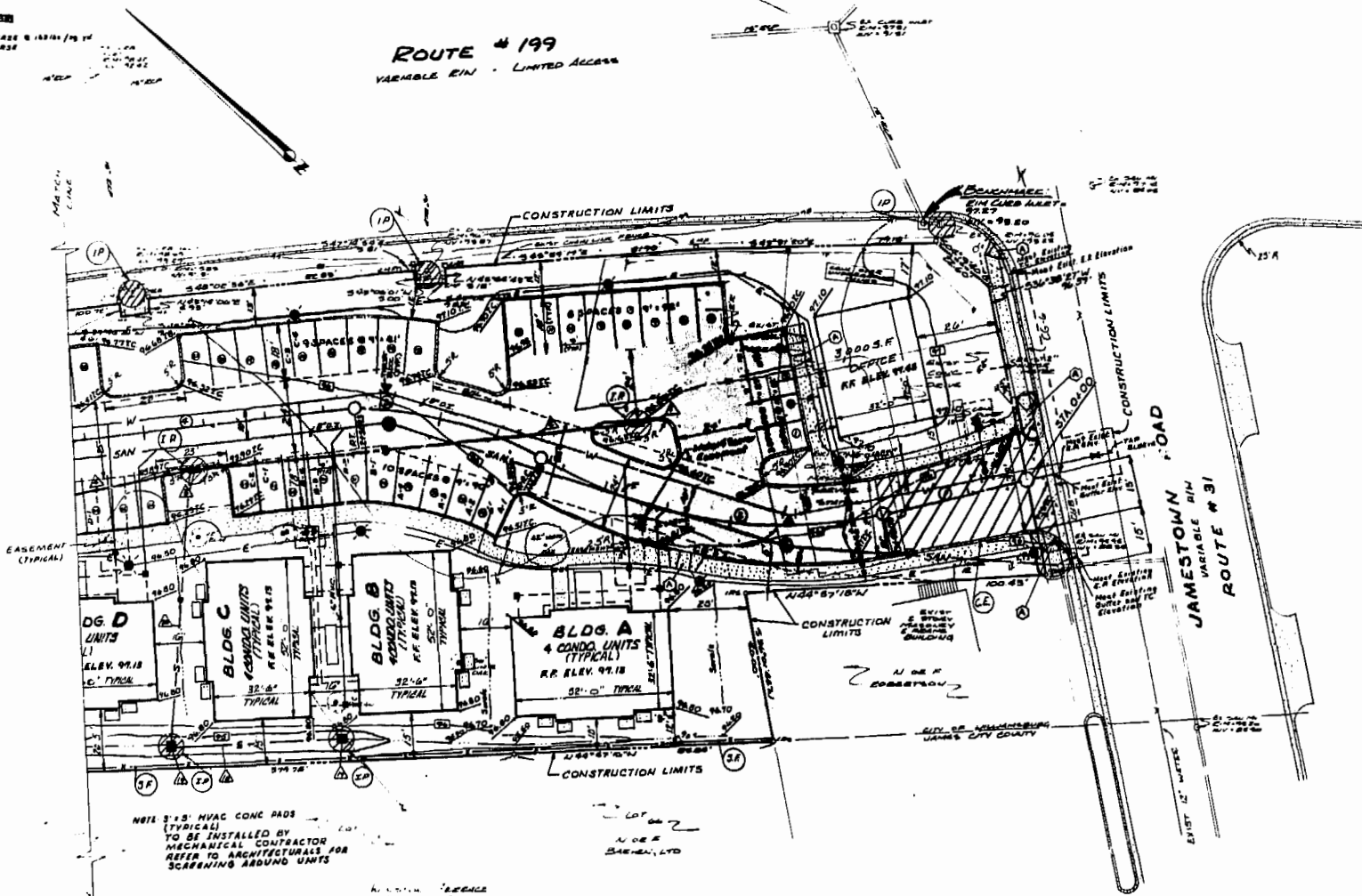

NOTE: 3" x 3" NYAC CONC PADS (TYPICAL) TO BE INSTALLED BY MECHANICAL CONTRACTOR REFER TO ARCHITECTURE FOR SCREENING AIR UNIT SCREENING

NOTE: CONTRACTOR MAY USE PLAIN CONCRETE RIPS EXCEPT UNDER PAVED AREAS R.C.D. IS TO BE USED UNDER PAVED AREAS

STORM INLET SUMMARY

NO.	TYPE	LENGTH	RIM, ELEV.	HEIGHT
1	W/O DI-2	2'-7"	96.00	3.00'
2	DI-3C	8'-0"	95.85	2.33'
3	DI-3B	8'-0"	95.81	2.20'
4	DI-3A	2'-0"	96.38	2.30'
5	DI-3B	2'-0"	96.30	2.66'
6	W/O	4'-0"	96.10	11.33'
7	W/O		96.80	3.00'
8	W/O		97.20	3.33'
9	CDI	12" DIA	96.30	2.00'
10	CDI	12" DIA	96.40	2.00'

STORM CULVERT SUMMARY

NO.	SIZE	TYPE	LENGTH	INV. (UP)	INV. (DOWN)	SLOPE (FT./FT.)	VEL. (FT./SEC.)
1	12"	R.C.P.	144'	92.00	92.78	.0054	2.3
2	12"	R.C.P.	144'	91.55	90.81	.0050	4.0
3	12"	R.C.P.	144'	90.71	89.98	.0080	3.2
4	12"	R.C.P.	86'	89.48	88.31	.0130	3.2
5	12"	R.C.P.	75'	88.21	87.03	.0150	3.2
6	12"	R.C.P.	144'	87.05	85.80	.0080	3.2
7	12"	R.C.P.	92'	85.80	84.98	.0100	3.2
8	12"	R.C.P.	81'	84.75	83.92	.0100	3.2
9	12"	R.C.P.	80'	83.40	82.58	.0100	3.2
10	12"	R.C.P.	80'	82.40	81.55	.0110	3.2

REQUIRED WATERLINE

- 23' L.P. 8" D.I. CLASS 82 WATERLINE
- 32' L.P. 6" D.I. CLASS 82 FIRELINE
- 600' L.P. 6" D.I. CLASS 82 WATERLINE
- 8 - 8" GATE VALVE
- 1 - 8" GATE VALVE
- 3 - 8" 90° BENDS
- 1 - 18" x 8" TAP SLEEVE
- 3 - 2" x 1/2" TEE
- 3 - 1" FIRE HYDRANTS
- 1 - 8" TO 4" REDUCER

12:40 p.m.
Recorded 1st day of August 1984
D. B. [Signature] pages 46
[Signature] Clerk

- ALL WORK SHALL BE IN ACCORDANCE WITH THE VIRGINIA DEPARTMENT OF HIGHWAYS AND TRANSPORTATION, "ROAD AND BRIDGE SPECIFICATIONS", DATED 1982, AND THE VIRGINIA DEPARTMENT OF HIGHWAYS AND TRANSPORTATION, "ROAD AND BRIDGE STANDARDS", 1982, UNLESS OTHERWISE NOTED.
- VERTICAL CONTROL IS BASED ON FINISH PAVES SHOWN ON PLANS.
- HORIZONTAL CONTROL IS BASED UPON EXISTING LINES SHOWN ON PLANS, UNLESS BY SURVEYOR AND ASSOCIATES, INC.
- SELECT CLEARING AND GRUBBING TO EXPOSE OR REMOVE OF ALL TREES, LIMBS, STUMPS AND BRANCHES EXCEPT THOSE TREES DESIGNATED BY OWNER TO REMAIN. ALL TREES SO DESIGNATED TO BE PRESERVED FROM DAMAGE TO THE TRUNK AND ROOT SYSTEM.
- THE CONTRACTOR TO STRIP TOPSOIL MATERIAL TO A DEPTH APPROXIMATELY 6" UNDER HIGHWAY EXISTING STRIPPS TO BE STRIPPED ON SITE AT LOCATIONS DESIGNATED BY OWNER. STRIPPING MAT TO BE CARRIED OUT WHEN SOIL IS APPROPRIATELY MOIST. ALL TRASH AND OTHER EXCESSIVE MATERIAL FROM TOPSOIL WORK STOCKPILE.
- TO CONTROL EROSION DURING CONSTRUCTION, SILT FENCES ARE TO BE INSTALLED AS SHOWN ON THE PLANS. SQUARE EDGE OF STRAW BALES TO BE INSTALLED TO FACE DOWNSTREAM. ALL INLETS TO HAVE DENNIS BASINS.
- ALL SILT FENCES AND STRAW BALES TO REMAIN IN PLACE AND MAINTAINED UNTIL FINISH CONSTRUCTION REQUIRES THEIR REMOVAL OR VEGETATIVE COVER IS ESTABLISHED. ALL EROSION CONTROL TO BE IN ACCORDANCE WITH VIRGINIA SOIL AND WATER CONSERVATION COMMISSION, "EROSION AND SEDIMENT CONTROL HANDBOOK", SECOND EDITION, 1980.
- ALL AREAS DISTURBED BY CONSTRUCTION AND NOT RECLAIMED BY STRUCTURES OR PAVING TO BE SOIL SOILED, SEED, FERTILIZED AND MULCHED IN ACCORDANCE WITH APPROPRIATE BELIEFS OF THE SPECIFICATIONS, OR PLAN GENERAL NOTES.
- ALL DRAINAGE STRUCTURES TO CONFORM TO VIRGINIA DEPARTMENT OF HIGHWAYS AND TRANSPORTATION, "ROAD AND BRIDGE STANDARDS", 1982, UNLESS OTHERWISE INDICATED.
- ST'D. CURB AND PAVED CITIES TO HAVE REPAVED APPROPRIATE FINISH AND CONFORM TO STATE ST'D. GRADE SLOPES TO OVER STORM DRAINAGE AND IN SLOPES, NO EXPOSED AGES IN NEW.
- INVERTS OF STORM DRAINAGE PIPES AND STRUCTURES MAY VARY SLIGHTLY TO SUIT EXISTING UNDESIGNED DRAINAGE.
- TEMPORARY CONSTRUCTION ENTRANCE SHALL BE INSTALLED AT THE LOCATION SHOWN ON PLANS. THIS ENTRANCE IS TO BE CONSTRUCTED IN ACCORDANCE WITH "VIRGINIA EROSION AND SEDIMENT CONTROL", P.C. 11-1-1.
- TEMPORARY SEDIMENT BASINS, PERIMETER DITCHES, EROSION CONTROL STONE AND STRAW BALE BARRIERS SHALL BE PLACED DURING CLEARING AND GRUBBING ACTIVITIES. THESE STRUCTURES ARE TO BE CHECKED PERIODICALLY AND CLEANED AS NECESSARY.
- THE CONTRACTOR SHALL COMPLETE DRAINAGE FACILITIES WITHIN 10 DAYS FOLLOWING COMPLETION OF ROUGH GRADING AT ANY POINT WITHIN THE PROJECT.
- ALL EROSION CONTROL MEASURES (SEDIMENT BASINS, DICES, ETC.) SHALL HAVE BEEN INSTALLED PRIOR TO OR DURING CLEARING.
- ALL DISTURBED AREAS WHICH ARE NOT DESIGNATED FOR PAVING, FILLING OR STRUCTURAL USES SHALL NOT BE EXPOSED FOR LONGER THAN 30 DAYS. VEGETATIVE COVER SHALL BE ESTABLISHED AS FOLLOWS:
TOPSOIL 4" THICK
LIME 4000 LBS./AC.
FERTILIZER 1000 LBS. 10-10-10/AC.
MULCH 3000 LBS./AC.
K-31 SEED 100 LBS./AC.
- ALL AREAS DESIGNATED FOR PAVING, UNDERGROUND UTILITIES AND STRUCTURAL USE SHALL BE STABILIZED AS SOON AS PRACTICAL, BUT NOT EXCEEDING 10 DAYS FOLLOWING INSTALLATION. NO MORE THAN 100' OF SANITARY SEWER OR STORM SEWER ARE TO BE OPEN AT ONE TIME. BASE COURSE MATERIAL SHALL BE PLACED IN ALL PARKING AND DRIVE AREAS WITHIN 30 DAYS OF FINAL GRADING.
- ALL STORM WATER MANAGEMENT FACILITIES INCLUDING EROSION CONTROL STONE ARE TO BE INSTALLED AND MADE OPERATIONAL WITHIN 30 DAYS FOLLOWING THE START OF CLEARING OPERATIONS. THE INSTALLATION OF DRAINAGE FACILITIES SHALL TAKE PREFERENCE OVER ALL OTHER UNDERGROUND UTILITIES.
- PRIOR TO COMMENCEMENT OF CONSTRUCTION CONTRACTOR TO NOTIFY OWNERS OF ALL UTILITIES (V.P.C.D., C & P, ETC.) OF PROPOSED CONSTRUCTION SO THAT THEY MAY LOCATE AND MARK THEIR FACILITIES. ANY DAMAGE TO EXISTING UTILITIES SHALL BE REPAIRED AT THE CONTRACTOR'S EXPENSE.
- WATER AND SEWER LINES TO BE INSTALLED IN ACCORDANCE WITH CITY OF WILLIAMSBURG REQUIREMENTS AS STATED IN WATER AND SEWER NOTES.

Langley and McDonald
A PROFESSIONAL CORPORATION
ENGINEERS • PLANNERS • SURVEYORS
VIRGINIA BEACH • WILLIAMSBURG, VIRGINIA



DES	BBG
DWN	LET
CHK	BBG
DATE	2.27.84

PEPERTREE CONDOMINIUMS
WILLIAMSBURG, VIRGINIA
PREPARED FOR
DMI, INC.

PROJ NO	83-235
FLD BK NO	
SHEET OF	2 OF 4
DWG	1245