

Recorded 8/13/74

CURVE DATA				
Curve No.	Delta	Rad.	Tan.	Arc.
1	87°35'35"	30.0'	28.77'	45.86'
2	90°54'00"	404.28'	411.30'	642.50'
3	53°00'00"	301.57'	150.36'	278.26'
4	51°40'42"	260.42'	465.10'	866.26'
5	51°40'42"	260.42'	440.88'	821.16'
6	53°00'00"	351.57'	175.28'	325.21'
7	90°30'26"	354.28'	358.14'	560.74'
8	89°34'19"	30.0'	29.78'	46.90'
9	3°13'40"	715.82'	20.17'	45.86'

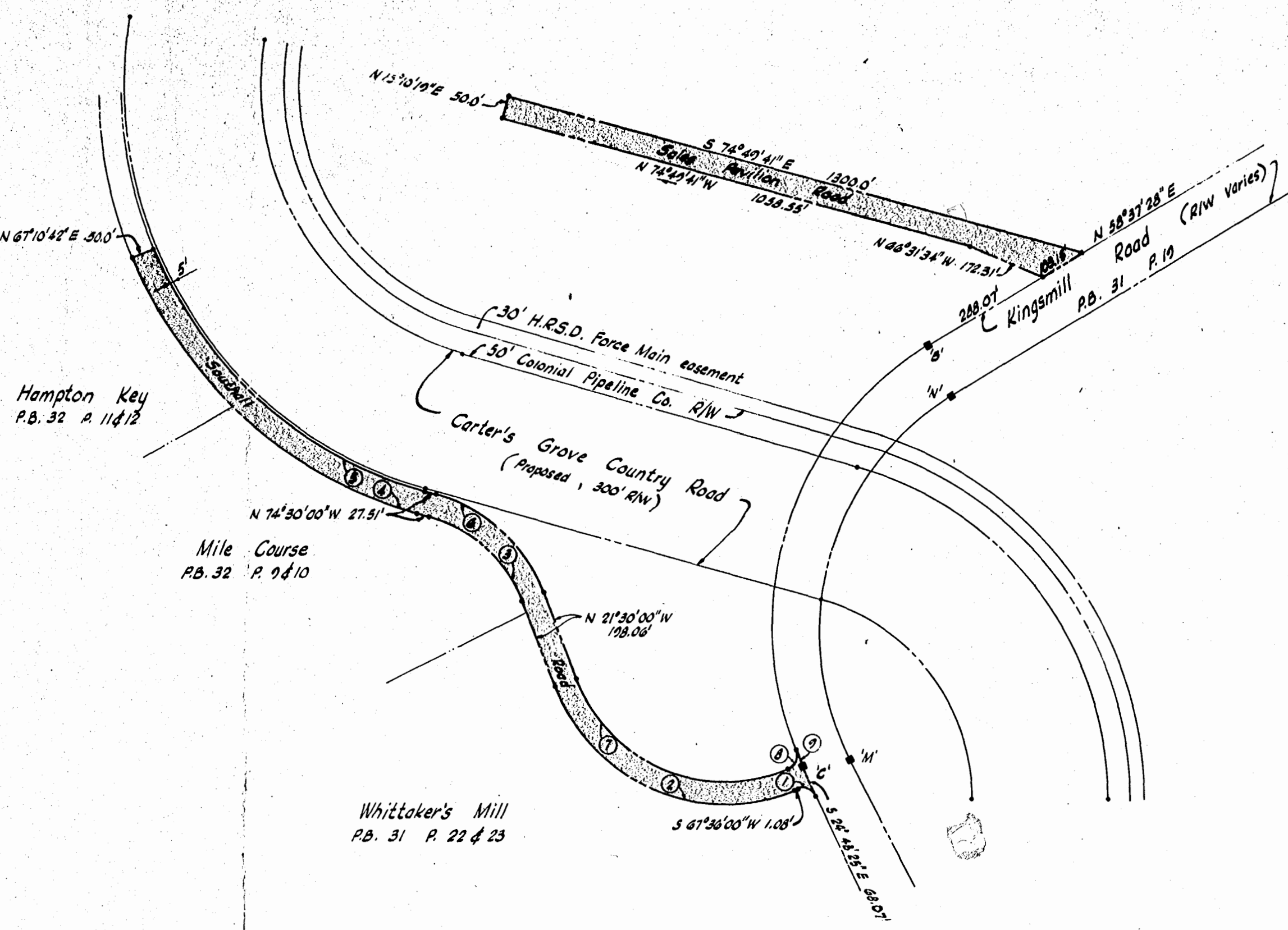

Hampton Key
P.B. 32 P. 11 & 12

Mile Course
P.B. 32 P. 9 & 10

Whittaker's Mill
P.B. 31 P. 22 & 23

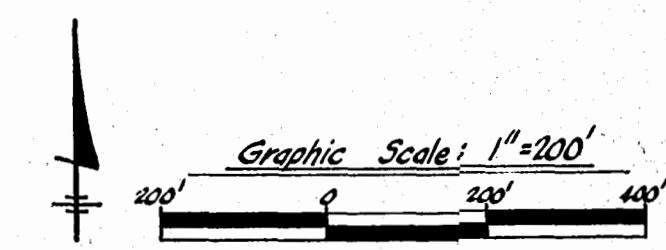

■ DENOTES CONCRETE MONUMENTS
NOTE: MONUMENTED POINTS DESIGNATED BY LETTER INDICATE POINTS ON KINGSMILL ROAD RIGHT-OF-WAY.

PLAT SHOWING UTILITY EASEMENTS
TO BE DEDICATED TO
JAMES CITY SERVICE AUTHORITY
FROM
BLISCH PROPERTIES, INC.
SCALE: 1"=200' AUG. 1, 1974
LANGLEY, McDONALD & OVERMAN
CONSULTING ENGINEERS
VA. BEACH, VA.

