

See DB 133 Pages 153-156-159 & 161
Recorded 9/29/71

D. WARE

J.G. WARBURTON

JAMES CITY COUNTY AREA
191.6 Acres ±

R. L. WHITFIELD

poplar

E.P. RUEGER

Record

Willis

ALONG OF BRANCH

6100' ±

survey base line

1200' ±
V.F.P.C.O. SURVEY LINE

pipe 30" to creek

1000' to Jolly pond
D.E. HAYES

50' EASEMENT INGRESS & FOR EGRESS

Chesapeake Corp.

Old Dominion Hunt Club

ROUTE No 611

1.2 mi. to Rt. No. 632

NOTE:

- = existing road
- - - = along old road
- ⊙ = rod or pipe
- ⊠ = hub

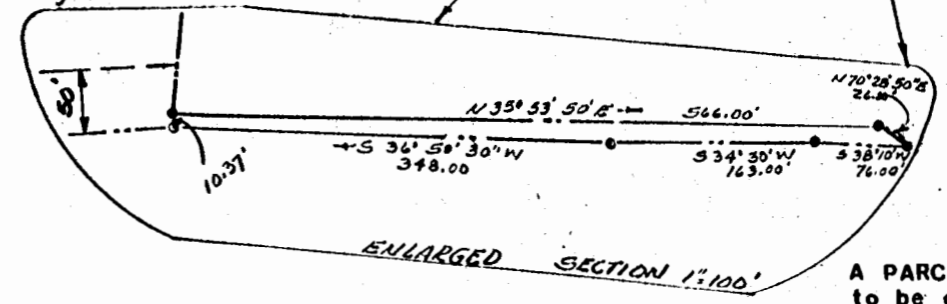

A PARCEL OF LAND to be conveyed to JAMES CITY COUNTY, VA.



R.F. Pyle C.L.S.
WILLIAMSBURG VIRGINIA

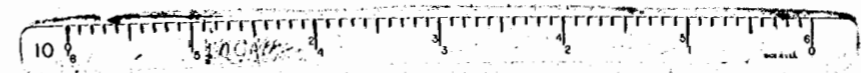

Powhatan District
JAMES CITY COUNTY, VA.
SCALE 1"=300'
JULY 18 1971