

Recorded 9/29/70  
See  
DB 128 Pages 214 & 216

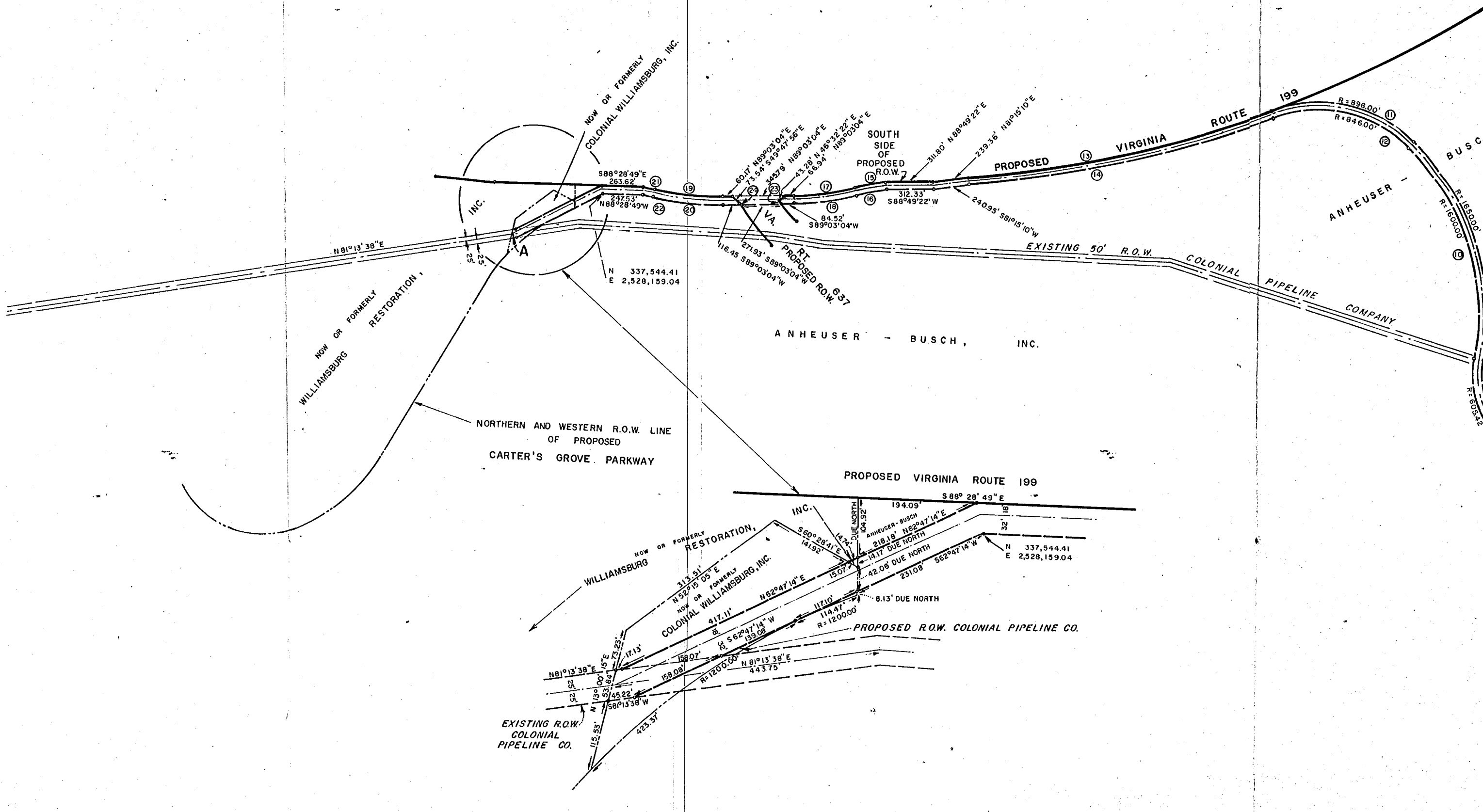

TOTAL LENGTH OF PIPELINE FROM A TO B  
ON CENTER LINE OF PIPE = 16,096.20' FEET

PART  
1.

AREA LEGEND

|   |       |       |
|---|-------|-------|
| WILLIAMSBURG RESTORATION, INC.                      | 0.002 | ACRES |
| COLONIAL WILLIAMSBURG, INC.                         | 0.39  | ACRES |
| R.O.W. THROUGH VA. DEPT. HIGHWAYS<br>AT VA. RT. 637 | 0.34  | ACRES |
| CAMP WALLACE  | 0.12  | ACRES |
| ANHEUSER-BUSCH, INC.                                | 17.45 | ACRES |

