

PLAT BOOK 27 PAGE 33
Recorded 1/16/70
SEE
DB 125 PAGE 101
See Also Plat BK 27 page 55
PART I of 4

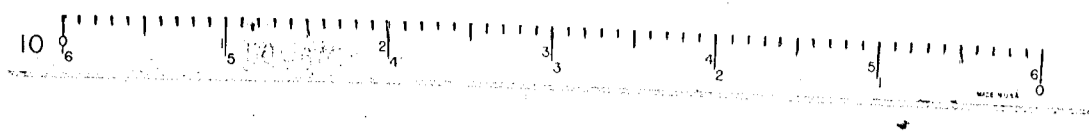

TO WILLIAMS

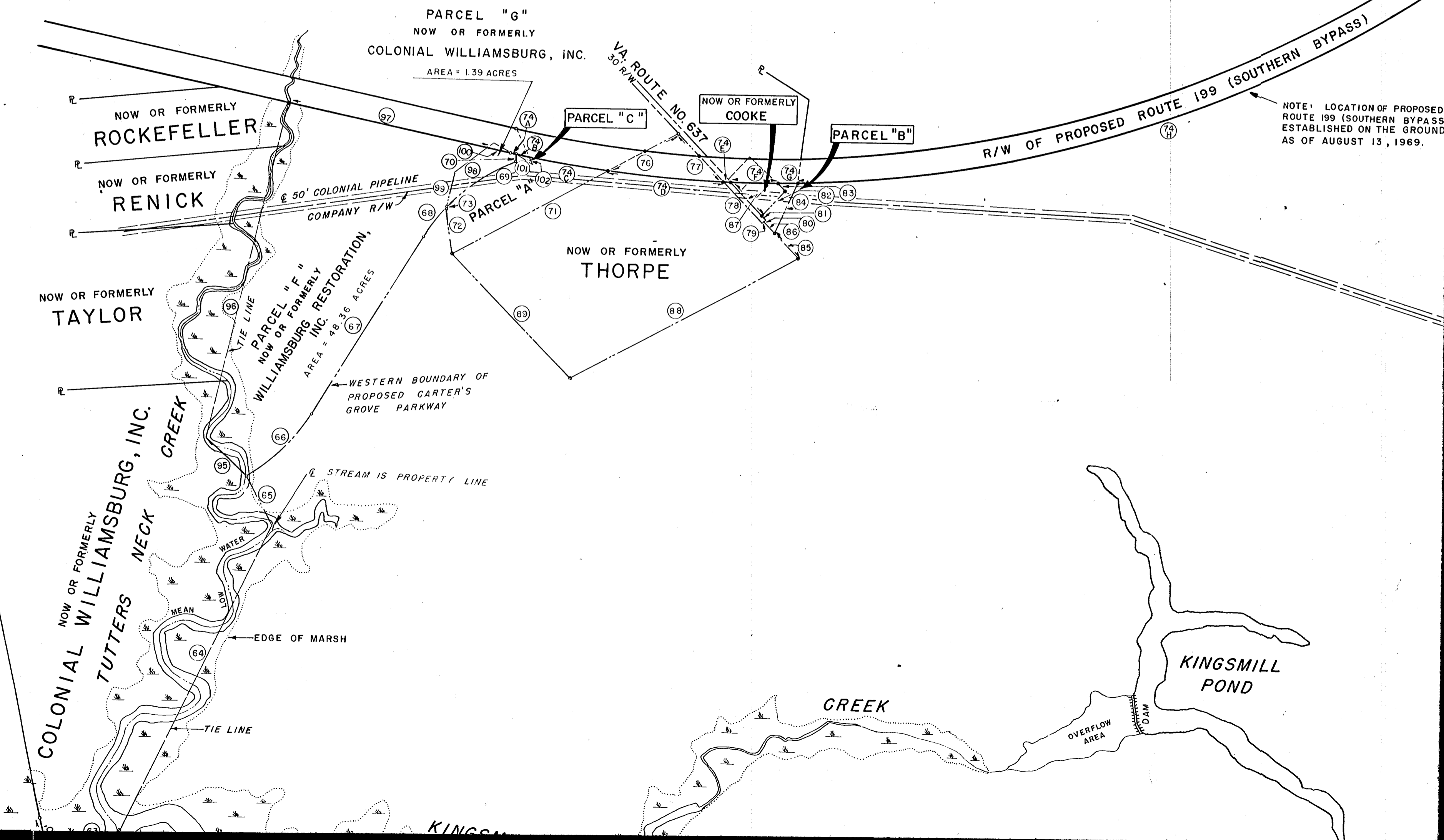

NOTE: LOCATION OF PROPOSED ROUTE 199 (SOUTHERN BYPASS) ESTABLISHED ON THE GROUND AS OF AUGUST 13, 1969.

COLONIAL WILLIAMSBURG, INC.
TUTTERS NECK

KINGSMILL POND

CREEK

KINGSMILL