

Recorded 1/5/70
See
DB 124 Page 679

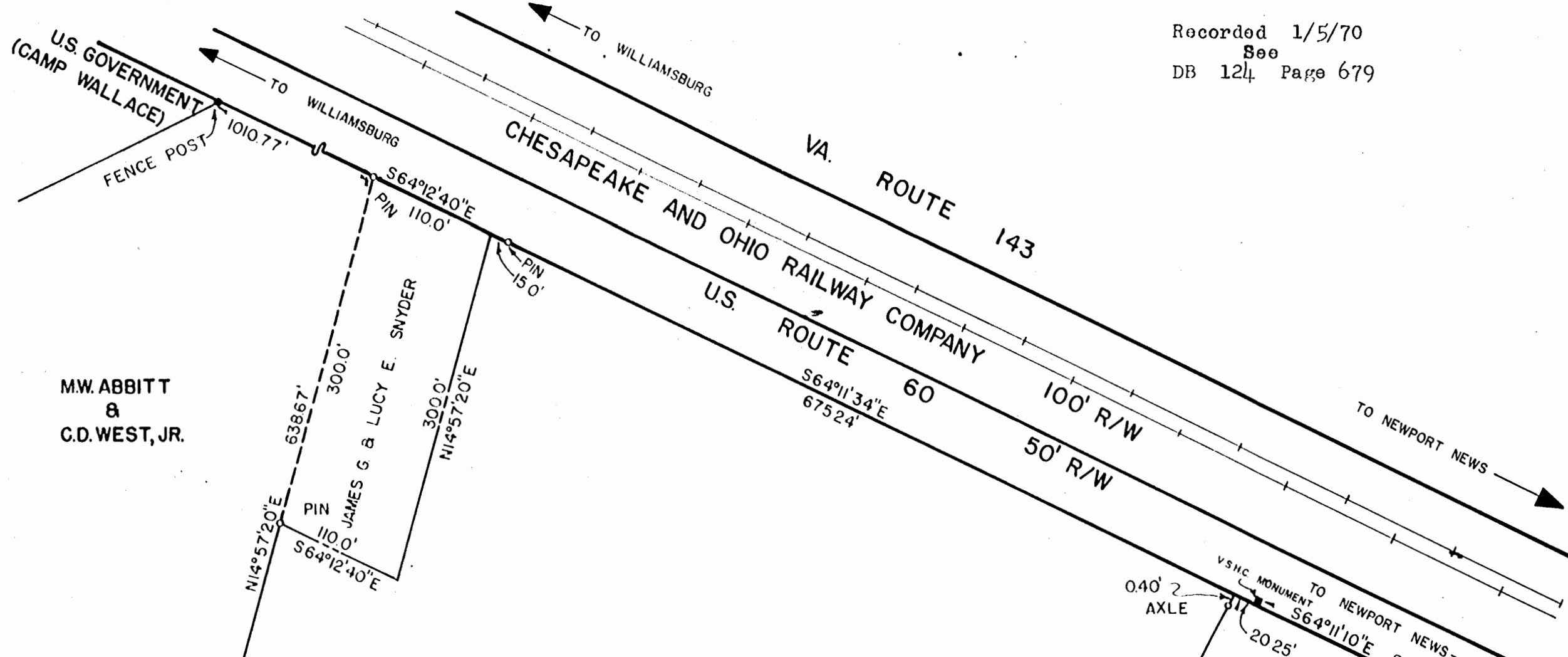

M.W. ABBITT & C.D. WEST, JR.

JAMES G & LUCY E. SNYDER
PIN 110.0'
PIN 150'
PIN 110.0'

AREA = 10.059 Acres

M.W. ABBITT & C.D. WEST, JR.

NOTE
APPROXIMATELY 24 GRAVES
ARE LOCATED IN THIS AREA
BY FIELD MEASUREMENT (NO
FENCING.)



M.W. ABBITT & C.D. WEST, JR.

PLAT OF PROPERTY OF
W. AUBREY AND VIRGINIA SKILLMAN
 JAMESTOWN DISTRICT
 JAMES CITY COUNTY, VIRGINIA
 TO BE CONVEYED TO
ANHEUSER-BUSCH, INC.

SCALE: 1" = 100' NOVEMBER 17, 1969

BALDWIN AND GREGG
ENGINEERS • SURVEYORS • PLANNERS
NORFOLK, VIRGINIA