

Recorded 11/14/69
See
D B 124 Page 153

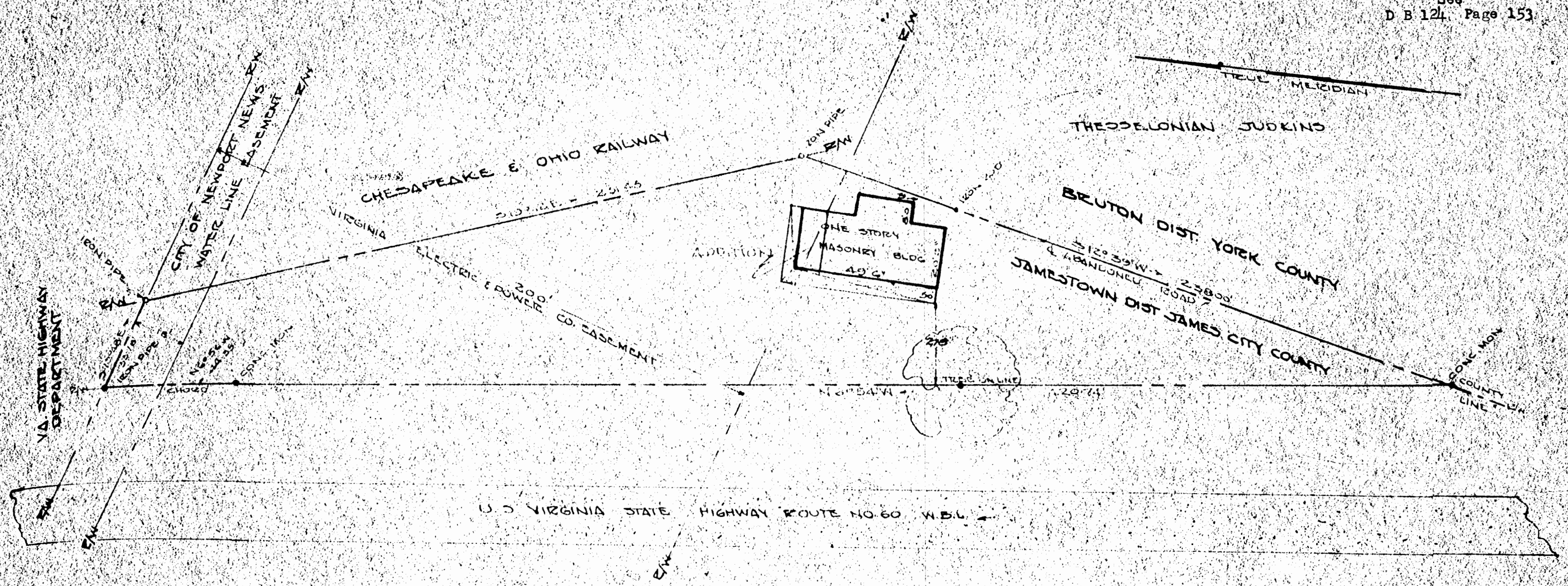

JAMESTOWN DIST. JAMES CITY COUNTY VIRGINIA
 PLAT SHOWING BOUNDARY SURVEY AND LOCATION
 OF IMPROVEMENTS PROPERTY STANDING IN THE
 NAME OF
 RALPH E. & MARJORIE B. JUMP
 JUNE 25, 1964 SCALE 1" = 30'
 AREA 0.495 ACRE

BY: J. M. WARD
 SURVEYOR, VIRGINIA
 LAND SURVEYOR NO. 100
 COMM. EXPIRES 1974

623