

Power Poles property of VEPCO
Telephone Poles property of C&P Telephone Co.

Recorded October 27, 1969
See D B 123 Page 689

PUB. ROAD REGION	STATE	ROUTE	FEDERAL AID		ROUTE	STATE PROJECT	SHEET NO.	TOTAL SHEETS
			PROJECT	PERCENT				
2	VA.	60	5-56-1013(7)		60	0060-047-102 C-501	13B	33

Rev. 12-26-67
Rev. 1-15-68
Rev. 2-21-69

SUFFOLK DISTRICT DESIGN UNIT

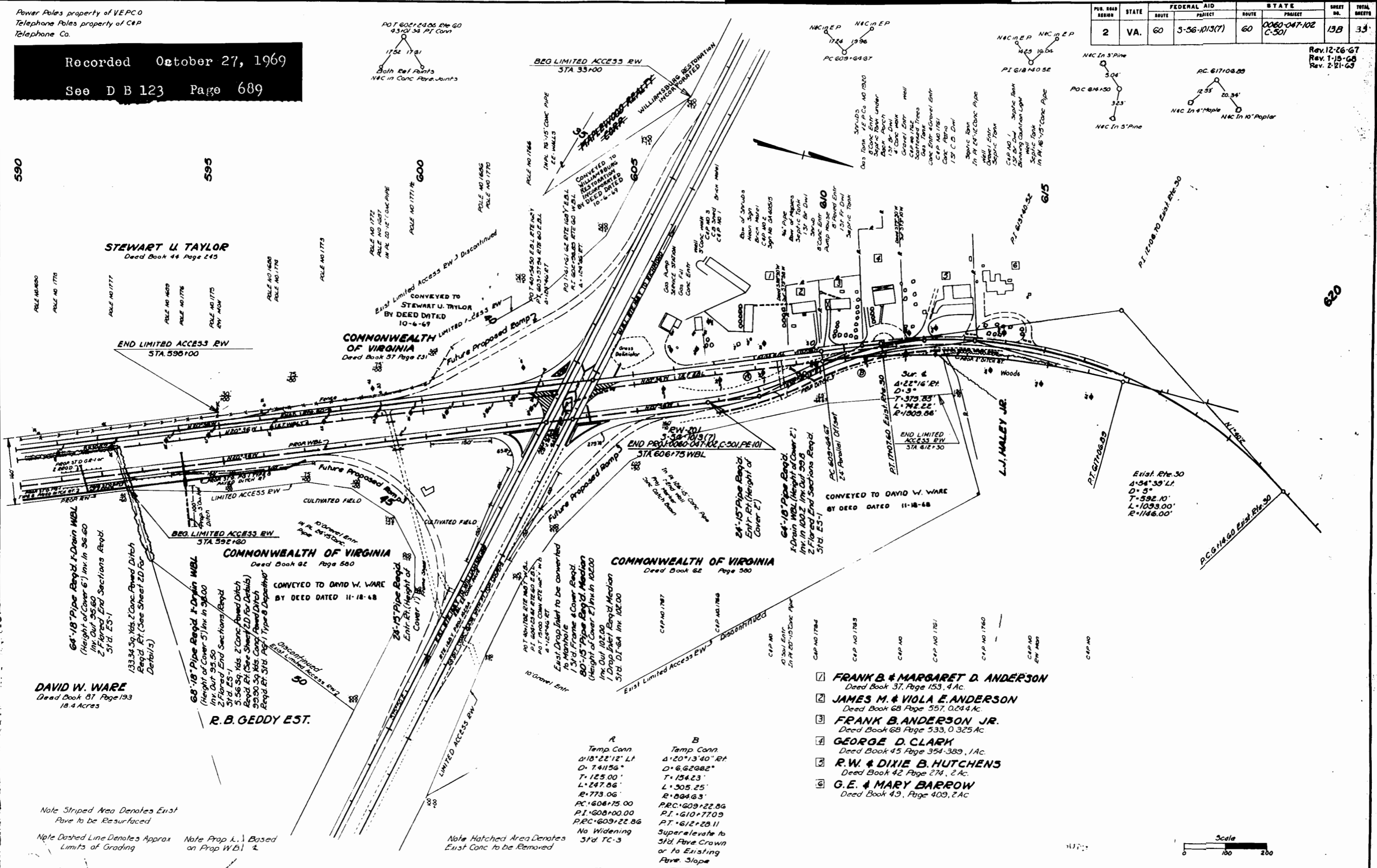

DAVID W. WARE
Deed Book 87 Page 193
18.4 Acres

COMMONWEALTH OF VIRGINIA
Deed Book 82 Page 580

R. B. GEDDY EST.

COMMONWEALTH OF VIRGINIA
Deed Book 82 Page 580

- 1 **FRANK B. & MARGARET D. ANDERSON**
Deed Book 37, Page 153, 4 Ac.
- 2 **JAMES M. & VIOLA E. ANDERSON**
Deed Book 68 Page 557, 0.244 Ac.
- 3 **FRANK B. ANDERSON JR.**
Deed Book 68 Page 533, 0.325 Ac.
- 4 **GEORGE D. CLARK**
Deed Book 45 Page 354-389, 1 Ac.
- 5 **R. W. & DIXIE B. HUTCHENS**
Deed Book 42 Page 274, 2 Ac.
- 6 **G. E. & MARY BARROW**
Deed Book 49, Page 409, 2 Ac.

A
Temp. Conn.
Δ 18° 22' 12" LT
D = 741156"
T = 125.00'
L = 247.86'
R = 773.06'
P.C. = 606+75.00
P.T. = 608+00.00
P.R.C. = 609+22.86
No Widening
5th TC-3

B
Temp. Conn.
Δ 20° 13' 40" RT
D = 6,62882"
T = 154.23'
L = 505.25'
R = 804.63'
P.C. = 609+22.86
P.T. = 610+77.09
P.T. = 612+28.11
Superelevate to
5th Pave. Crown
or to Existing
Pave. Slope

Note Striped Area Denotes Exist Pave to be Resurfaced
Note Dashed Line Denotes Approx Limits of Grading
Note Prop L. Based on Prop W.B. 1

Note Hatched Area Denotes Exist Conc to be Removed

