

FEDERAL AID	STATE	PROJECT		SHEET NO.	TOTAL SHEETS
		ROUTE	PROJECT		
60	VA.	60	3-56-1013(7)	60	0060-047-102 C-501

Rev. 12-26-67
Rev. 1-15-68
Rev. 2-21-69

Power Poles property of VEPCO
Telephone Poles property of CEP
Telephone Co.

Recorded 10/16/69
See
D B 123 Page 585

SUFFOLK DISTRICT DESIGN UNIT

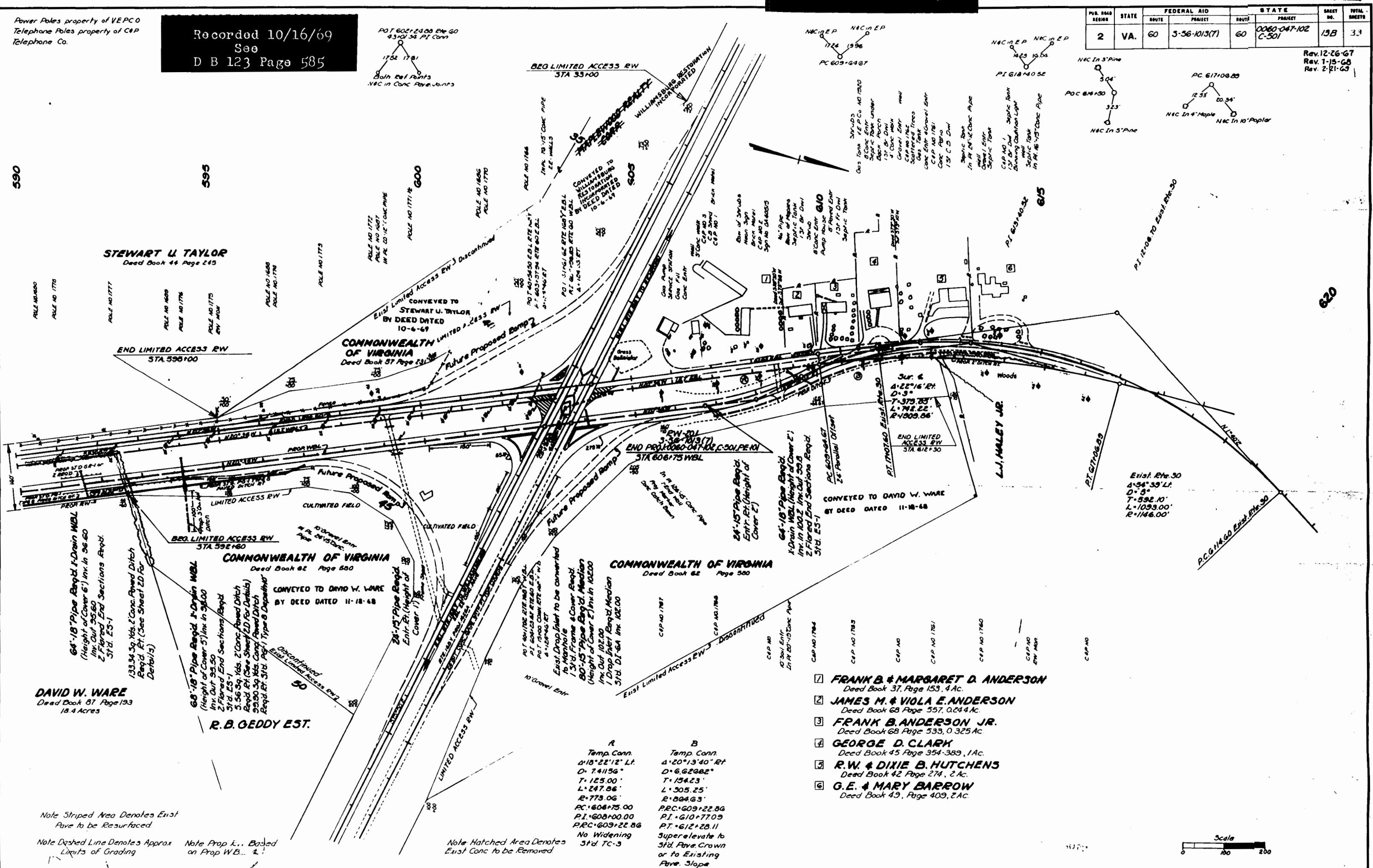

DAVID W. WARE
Deed Book 87 Page 133
18.4 Acres

R. B. GEDDY EST.

COMMONWEALTH OF VIRGINIA
Deed Book 62 Page 500

- 7 **FRANK B. & MARGARET D. ANDERSON**
Deed Book 37, Page 153, 4 Ac.
- 2 **JAMES M. & VIOLA E. ANDERSON**
Deed Book 68 Page 557, 0.244 Ac.
- 3 **FRANK B. ANDERSON JR.**
Deed Book 68 Page 533, 0.325 Ac.
- 4 **GEORGE D. CLARK**
Deed Book 45 Page 354-389, 1 Ac.
- 5 **R. W. & DIXIE B. HUTCHENS**
Deed Book 42 Page 274, 2 Ac.
- 6 **G. E. & MARY BARROW**
Deed Book 49, Page 409, 2 Ac.

A
Temp. Conn.
4'18" 22'12" LT.
D=741156"
T=125.00'
L=247.86'
R=773.06'
P.C.=606+75.00
P.T.=608+00.00
P.R.C.=609+22.86
No Widening
Std. TC-3

B
Temp. Conn.
4'20" 13'40" RT.
D=662882"
T=134.23'
L=305.25'
R=804.63'
P.C.=609+22.86
P.T.=610+77.09
P.T.=612+28.11
Superelevate to
Std. Pav. Crown
or to Existing
Pave Slope

Note Striped Area Denotes Exist
Pave to be Resurfaced

Note Dashed Line Denotes Approx
Limits of Grading

Note Prop. L... Based
on Prop. W.B....

Note Hatched Area Denotes
Exist Conc. to be Removed

