

Recorded Aug 26, 1964  
in  
D. B. 97 page 175.  
Virginia Blanchard, Clerk

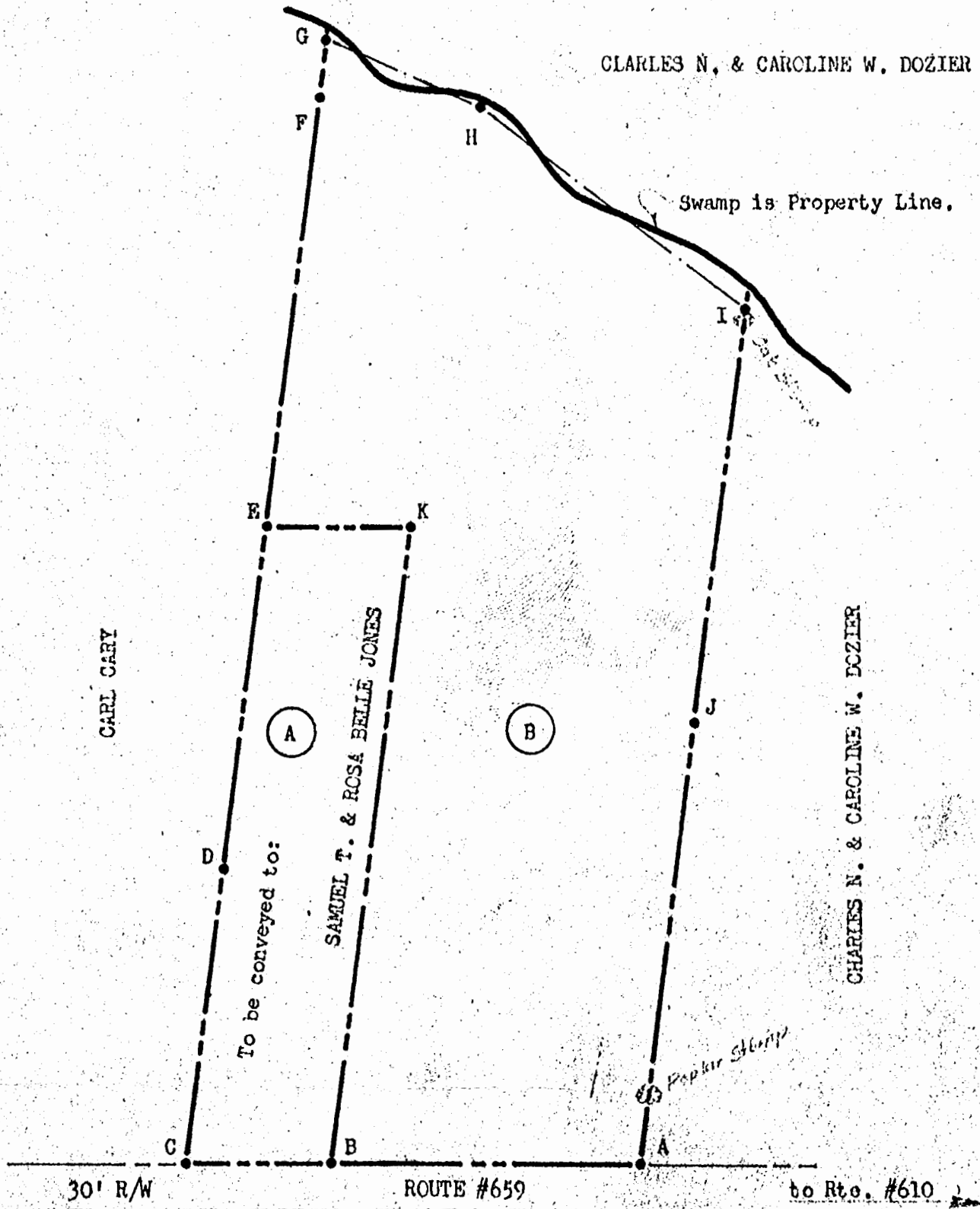
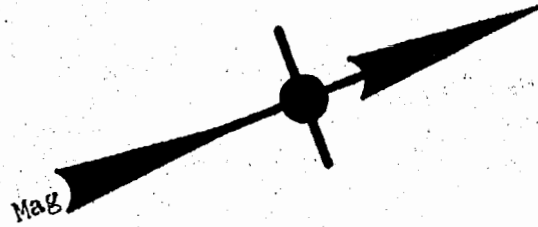

LINE DATA			
MARKER	CORNER	CHORD	BEARING
PIPE	A		
"	B	216.58	S 20° 15' 00" W
"	C	100.00	S 20° 15' 00" W
"	D	201.73	N 62° 47' 30" W
"	E	237.12	N 62° 47' 30" W
"	F	297.70	N 62° 47' 30" W
"	G	40.00	N 62° 47' 30" W
"	H	121.62	N 43° 30' 25" E
"	I	229.10	N 57° 39' 15" E
"	J	283.92	S 62° 47' 30" E
"	K	304.06	S 63° 47' 30" E
"	E	100.00	N 20° 15' 00" E
"	K	138.85	S 62° 47' 30" E
"	B		

This is to certify that the property lines "G", "H", "I", "J", "A" as shown is as agreed upon by the undersigned adjoining land owners.

*Charles N. Dozier*  
Charles N. Dozier  
*Caroline W. Dozier*  
Caroline W. Dozier  
*Floyd L. Cary*  
Floyd L. Cary  
*Henrietta Cary*  
Henrietta Cary

I, *B. L. Moody*, a Notary Public in and for the State of Virginia, city/county of *James City* do certify that the above named persons whose names are signed to the foregoing writing have acknowledged the same before me in State and city/county aforesaid.

Given under my hand this 26 day July 1963  
My commission expires 5 day Jan 1966  
*B. L. Moody*  
Notary Public

Area of Parcel (A) = 1,000 Acre  
Area of Parcel (B) = 4,000 Acres  
Total Area = 5,000 Acres

STEPHEN STEPHENS  
CERTIFIED LAND SURVEYOR  
133 WINSTON DRIVE  
PHONE: CA 9-5462 - WILLIAMSBURG, VA.

PLAT of Part of PEACHY PARK  
Property of:  
FLOYD L. & HENREITTA GARY  
Scale: 1" = 100' June 1963  
POWATAN DISTRICT, JAMES CITY COUNTY, VIRGINIA