

Power Poles: K.E.G.R.Co.
Tel. Poles: Peninsula Tel. Co.

FED. ROAD DIST. No.	STATE	B. P. R. ROUTE	PROJECT	STATE ROUTE	PROJECT	SHEET No.	TOTAL SHEETS
14	VA.			168	1177-D	6	21

R/W AS SHOWN
POSTED 11/27

DATE	BY	REVISION
11/27/62	L. J. J.	1. PREPARED
12/23/62	L. J. J.	2. CHECKED
1/10/63	L. J. J.	3. REVISED

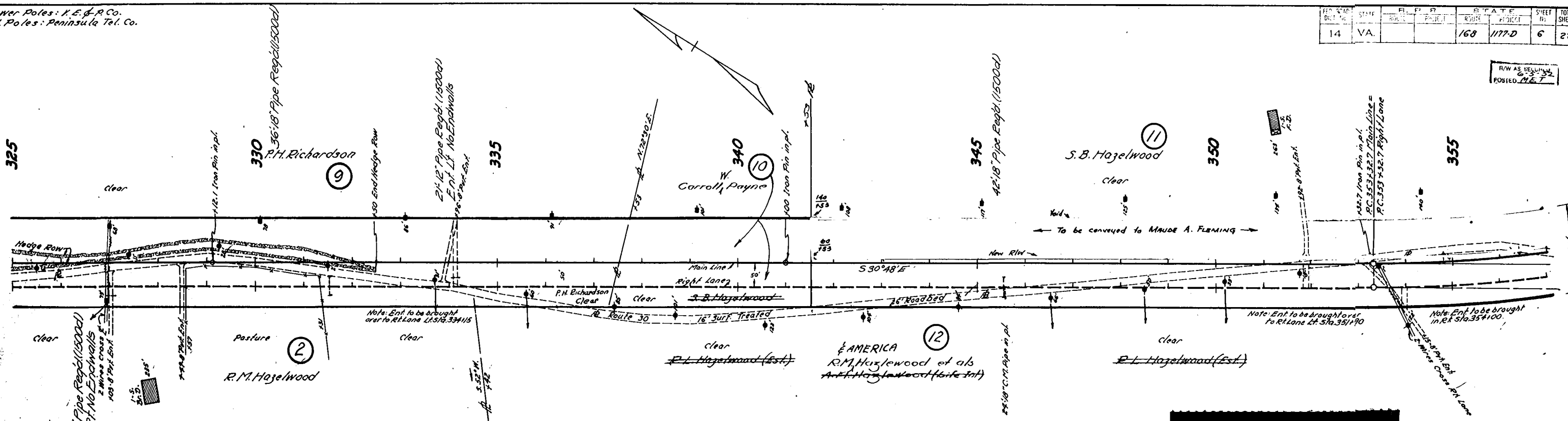

Road Ramps

Sta.	Side	Cu.Yds.
327+03	Rt.	10
329+49	Rt.	15
351+90	Lt.	25
354+00	Rt.	10
Total		60

Recorded June 11, 1963
see
D. B. 91, page 60

Power Poles: K.E.G.R.Co.
Tel. Poles: Peninsula Tel. Co.

FED. ROAD DIST. No.	STATE	B. P. R. ROUTE	PROJECT	STATE ROUTE	PROJECT	SHEET No.	TOTAL SHEETS
14	VA.			168	1177-D	7	21

R/W AS SHOWN
POSTED 11/27

DATE	BY	REVISION
11/27/62	L. J. J.	1. PREPARED
12/23/62	L. J. J.	2. CHECKED
1/10/63	L. J. J.	3. REVISED

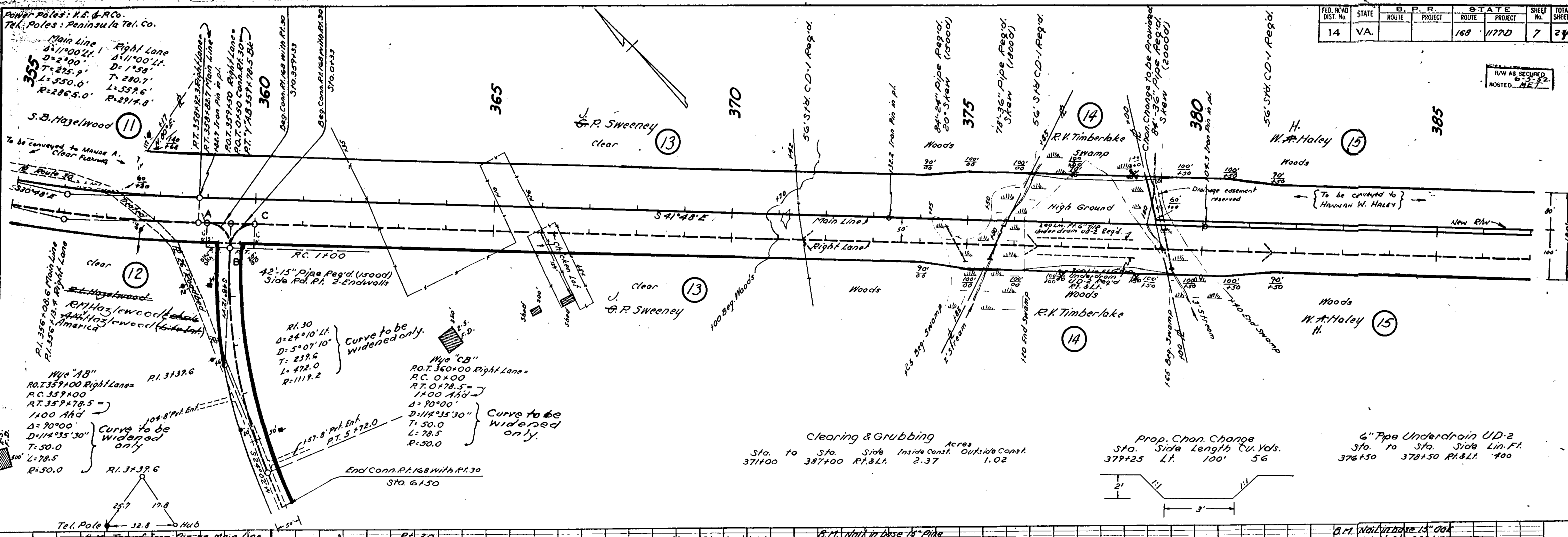

Clearing & Grubbing

Sta. to	Sta.	Side	Inside Const.	Outside Const.	Acres
371+00	387+00	Rt. & Lt.	2.37	1.02	

Prop. Chan. Change

Sta.	Side Length	Cu. Yds.
379+25	Lt. 100'	56

6" Pipe Underdrain UD-2

Sta. to	Sta.	Side	Lin. Ft.
376+50	378+50	Rt. & Lt.	400

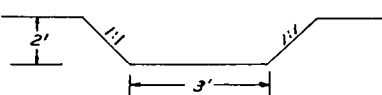

Rt. Vail in base 15' dia
at Sta. 387+55