

Note: All Telephone Poles Property of Chesapeake Potomac Tele Co of Virginia

All Power Poles Property of VE POCO of Richmond Virginia

Note: This project is planned for as a part of the Interstate System. The cross-overs shown on these plans are temporary only. When service roads are constructed, a cross-over, except those at points where utility grade separation structures are shown, may be closed. When grade separation structures are built, all cross-overs are to be closed and no direct connection between the service roads and the main line pavement may exist, except through the interchanges.

BEG IN 04-5(2)
BEG PROJ 4841-01 RTE 168T
STA. 42+00

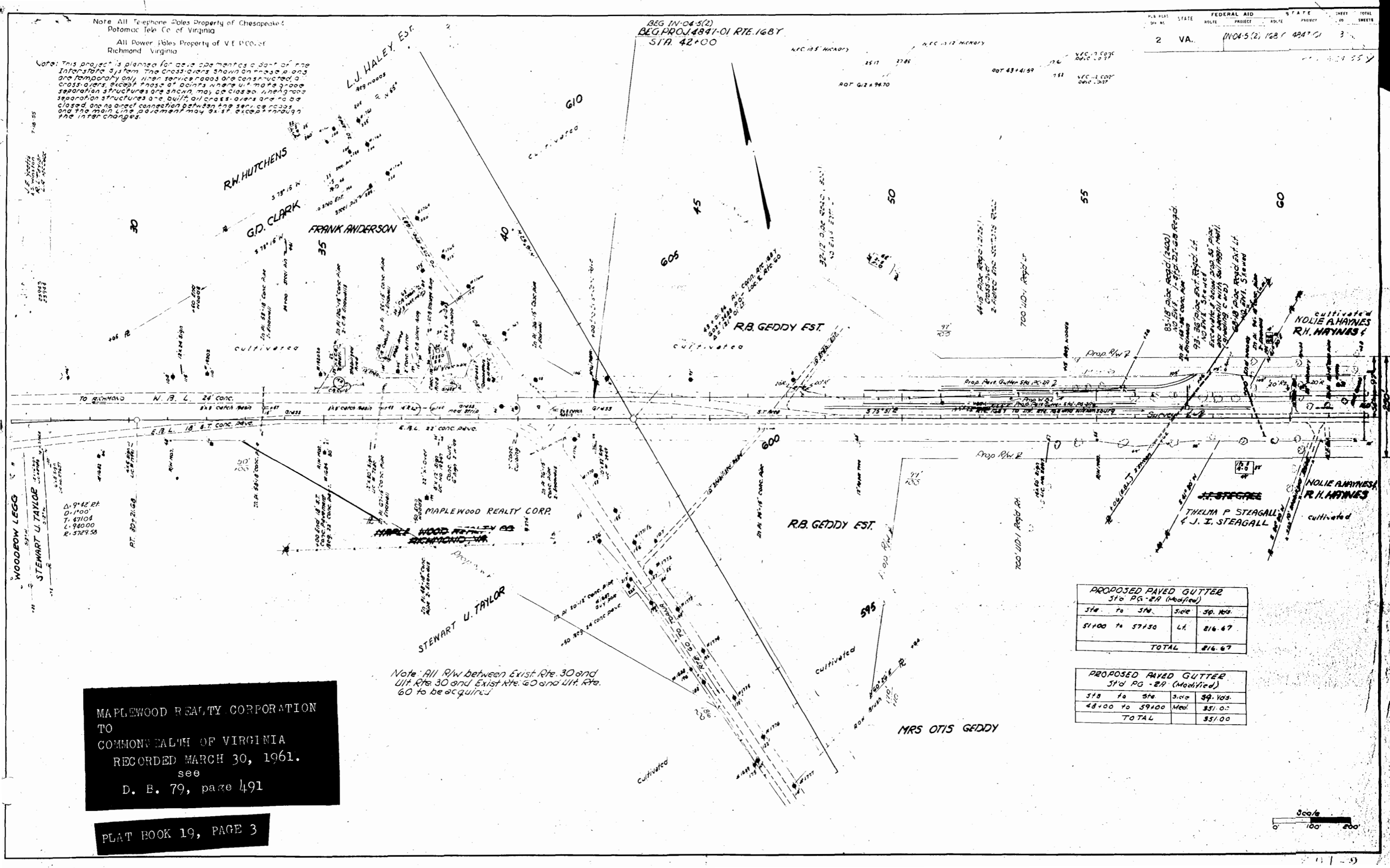

Note: All R/W between Exist. Rte. 30 and Ut. Rte. 30 and Exist. Rte. 60 and Ut. Rte. 60 to be acquired

MAPLEWOOD REALTY CORPORATION
TO
COMMONWEALTH OF VIRGINIA
RECORDED MARCH 30, 1961.
see
D. B. 79, page 491

PROPOSED PAVED GUTTER Std PG-2A (Modified)				
Sta.	To Sta.	Side	Sp. Nos.	
51100	To 57150	Lt.		816.67
TOTAL				816.67

PROPOSED PAVED GUTTER Std PG-2A (Modified)				
Sta.	To Sta.	Side	Sp. Nos.	
48+00	To 59+00	Med.		351.00
TOTAL				351.00

