

Part of a tract of Wood Land situated in James  
 District, James City County, Virginia, belonging to Kings  
 Mill Farm and separated from said Farm by the lands  
 of A. G. Harwood and David Collins, and the  
 Survey of J. M. P. W. Philadelphia, Pa.  
 Surveyed Dec. 12th 1813, by Spangy Smith, Surveyor  
 for York County.

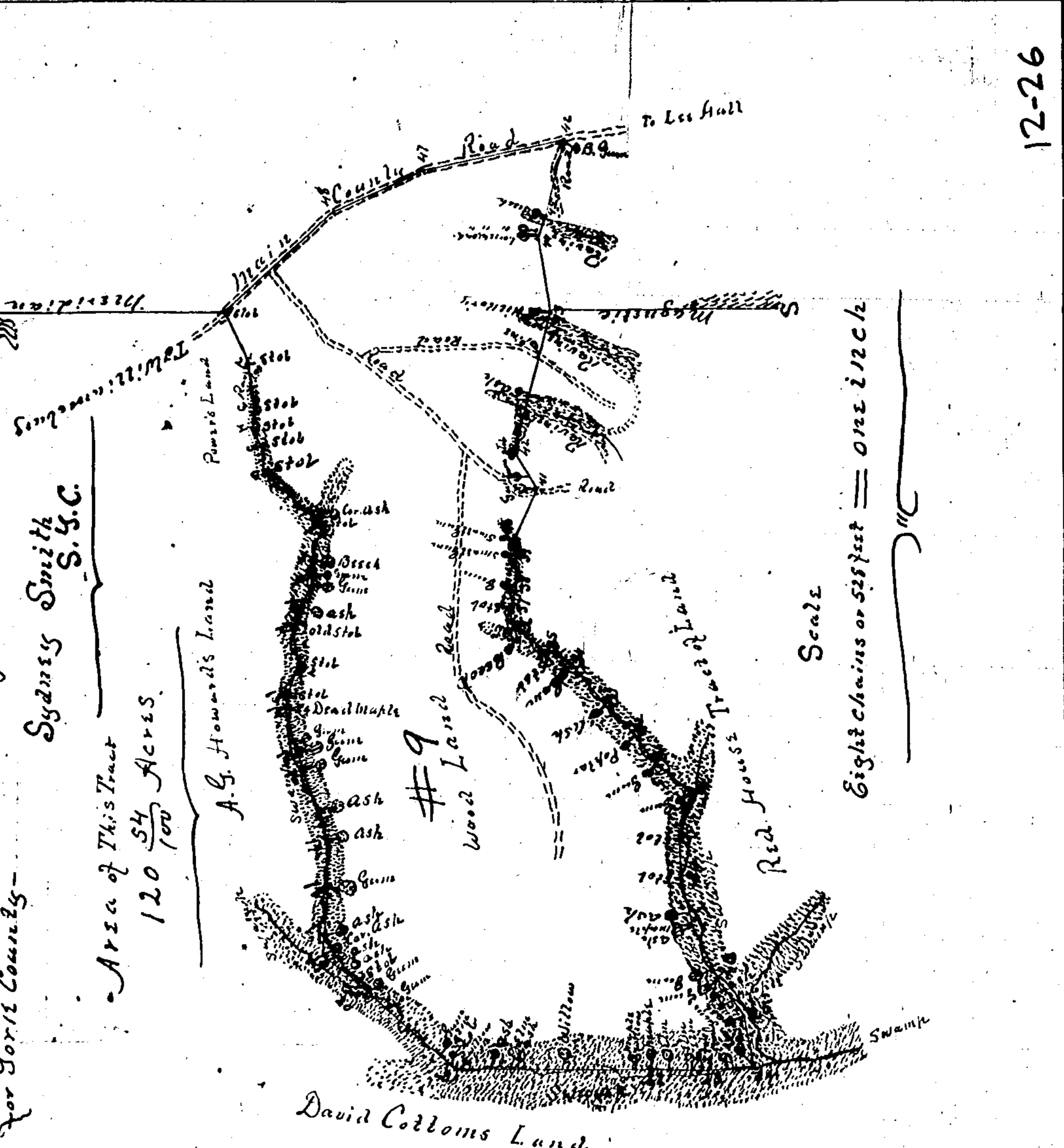

12-26

