

VIRGINIA ELECTRIC & POWER CO.
 MESSER ROAD-LEE HALL
 TRANSMISSION LINE
 PLAT TO ACCOMPANY RIGHT-OF-WAY AGREEMENT
 WITH
 L. E. & T. STEWART
 DISTRICT COUNTY STATE
 POWHATAN JAMES CITY VA.
 SCALE: 1 INCH = 100 FT. NO. 136
 SURVEYED BY
 AUG. 1940 STONE & WEBSTER ENG. CORP.

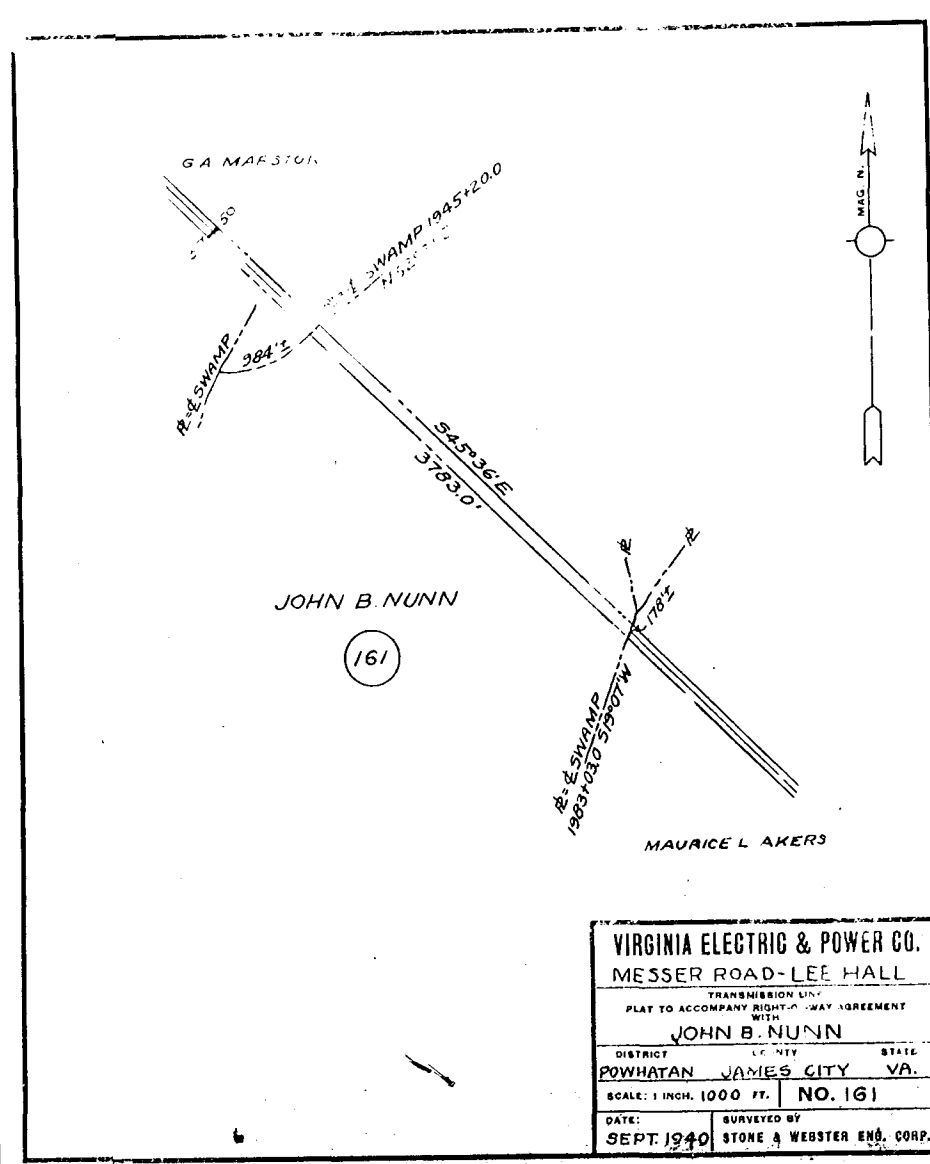

VIRGINIA ELECTRIC & POWER CO.
 MESSER ROAD-LEE HALL
 TRANSMISSION LINE
 PLAT TO ACCOMPANY RIGHT-OF-WAY AGREEMENT
 WITH
 JOHN B. NUNN
 DISTRICT COUNTY STATE
 POWHATAN JAMES CITY VA.
 SCALE: 1 INCH = 100 FT. NO. 161
 SURVEYED BY
 SEPT. 1940 STONE & WEBSTER ENG. CORP.

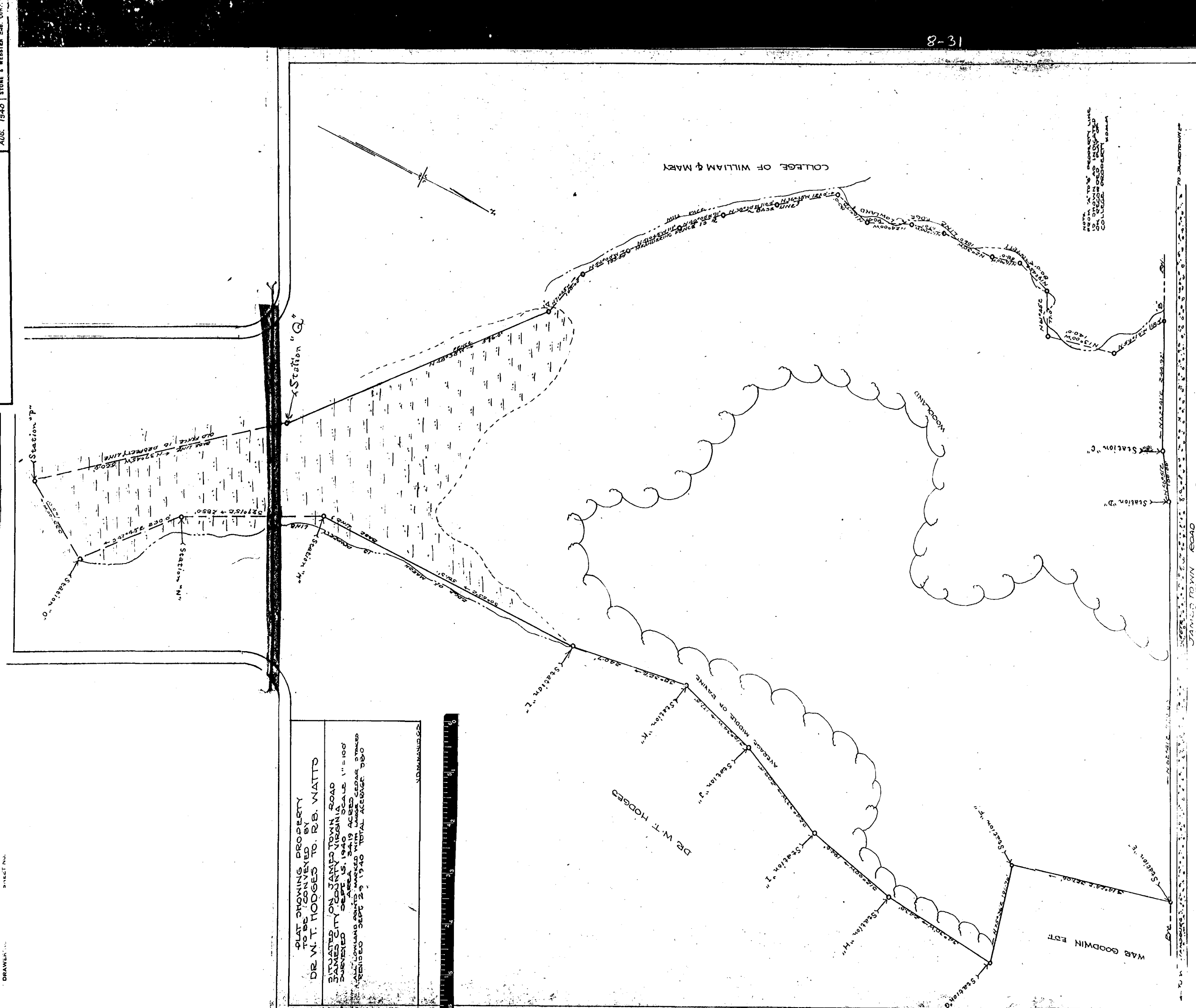

PLAT SHOWING PROPERTY
 TO BE ACQUIRED BY
 DR. W. T. HODGES TO R.S. WATTS
 SITUATED ON JAMES TOWN ROAD
 JAMES CITY COUNTY VIRGINIA
 SURVEYED SEPT. 15, 1940 SCALE 1" = 100'
 ALL LOWLAND POINTS MARKED 34.19 ACRES
 REMOVED SEPT. 29, 1940 TOTAL AVERAGE 28.0

NOTE: A 10' PROPERTY LINE
 WAS LOCATED BY SURVEY
 OF COLLEGE PROPERTY MAPS

JAMES TOWN ROAD
 VIRGINIA STATE HIGHWAY ROUTE 51