

Note: All property owned by M. Leah Jones unless otherwise shown.

VIRGINIA ELECTRIC & POWER CO
 WILLIAMSBURG DISTRIBUTION
 PLAT TO ACCOMPANY RIGHT-OF-WAY AGREEMENT WITH AS SHOWN
 DISTRICT ASHOUN COUNTY STATE JAMESTOWN JAMES CITY VIRGINIA
 DRAWN BY C.S. [Signature] WMBG # 1561

Recorded Aug. 22, 1940
 in D. B. 32 page
 Va. Blanchard Clerk

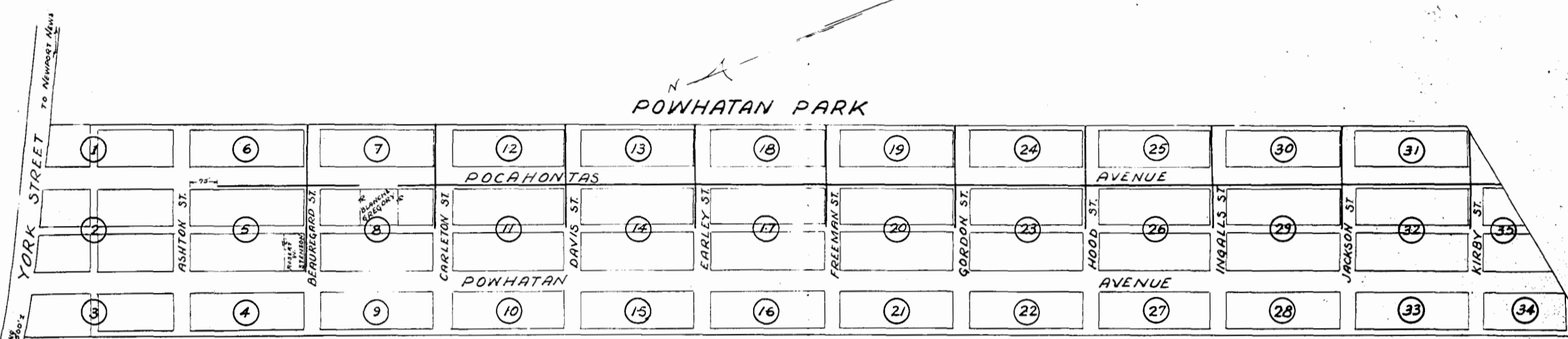

Note: All property owned by M. Leah Jones unless otherwise shown.

VIRGINIA ELECTRIC & POWER CO
 WILLIAMSBURG DISTRIBUTION
 PLAT TO ACCOMPANY RIGHT-OF-WAY AGREEMENT WITH AS SHOWN
 DISTRICT ASHOUN COUNTY STATE JAMESTOWN JAMES CITY VIRGINIA
 DRAWN BY C.S. [Signature] WMBG # 1561

Recorded Aug. 22, 1940
 in D. B. 32 page
 Va. Blanchard Clerk

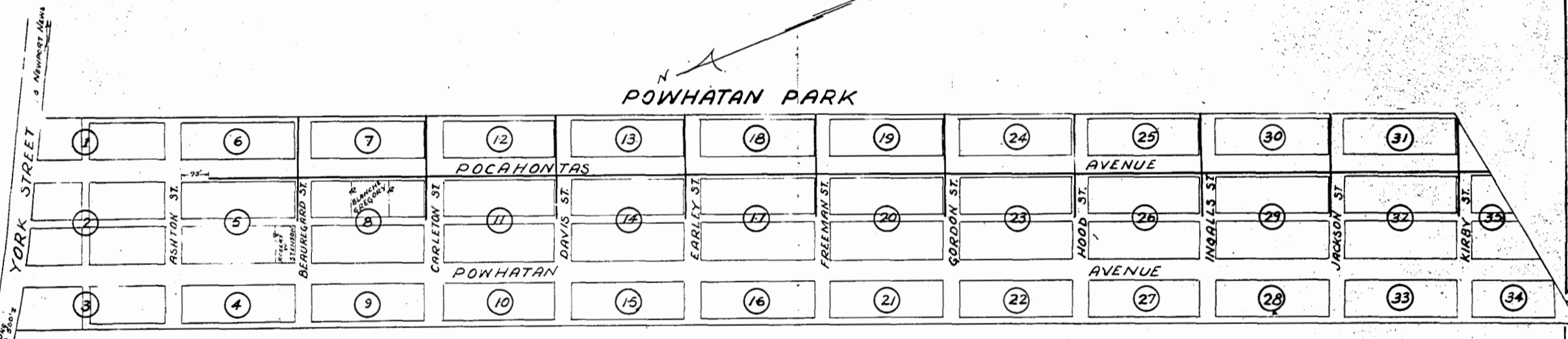

Note: All property owned by M. Leah Jones unless otherwise shown.

VIRGINIA ELECTRIC & POWER CO
 WILLIAMSBURG DISTRIBUTION
 PLAT TO ACCOMPANY RIGHT-OF-WAY AGREEMENT WITH AS SHOWN
 DISTRICT ASHOUN COUNTY STATE JAMESTOWN JAMES CITY VIRGINIA
 DRAWN BY C.S. [Signature] WMBG # 1561

Recorded Aug. 22, 1940
 in D. B. 32 page
 Va. Blanchard Clerk

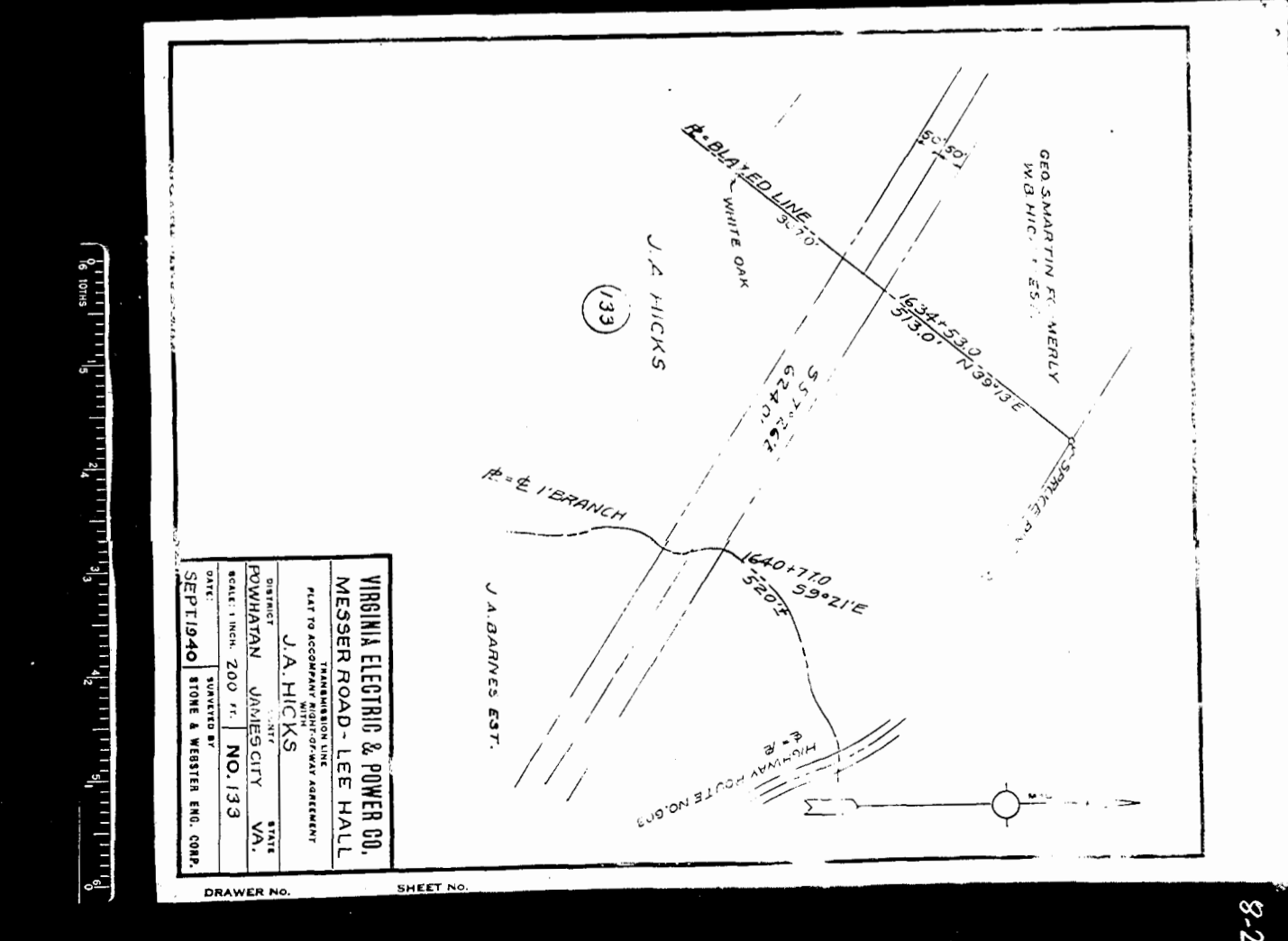

VIRGINIA ELECTRIC & POWER CO.
 MESSER ROAD - LEE HALL
 J.A. HICKS
 DISTRICT POWHATAN COUNTY STATE JAMESTOWN JAMES CITY VA.
 DATE: SEPT 1940
 DRAWN BY: STONE & REISTER ENG. CORP.
 SCALE: 1" = 200 FT.
 NO. 133

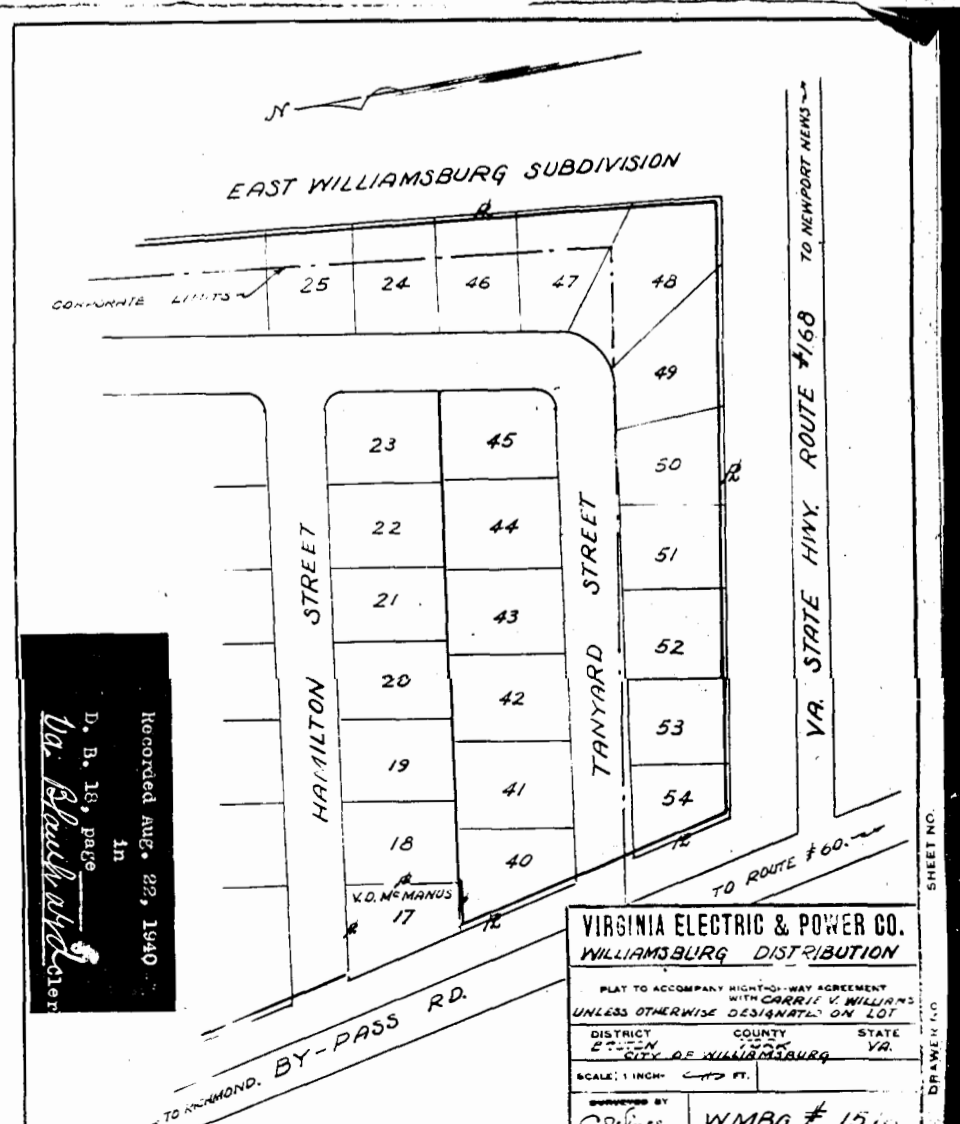

Recorded Aug. 22, 1940
 in D. B. 32 page
 Va. Blanchard Clerk

VIRGINIA ELECTRIC & POWER CO.
 WILLIAMSBURG DISTRIBUTION
 PLAT TO ACCOMPANY RIGHT-OF-WAY AGREEMENT WITH CONRUL & WILLIAMS UNLESS OTHERWISE DESIGNATED ON LOT
 DISTRICT EASTWICH COUNTY STATE JAMESTOWN JAMES CITY VA.
 SCALE: 1" = 100 FT.
 DRAWN BY C.S. [Signature] WMBG # 1561

18 INCHES