

VIRGINIA ELECTRIC & POWER CO.  
 Toano Distribution  
 PLAT TO ACCOMPANY RIGHT-OF-WAY AGREEMENT  
 WITH  
 C. B. Duer And R. H. Brame  
 DISTRICT COUNTY STATE  
 Powhatan James City Va.  
 SCALE: 1 INCH = 30 FT.  
 C.W.L. WMBG # 1522

DRAWER NO SHEET NO

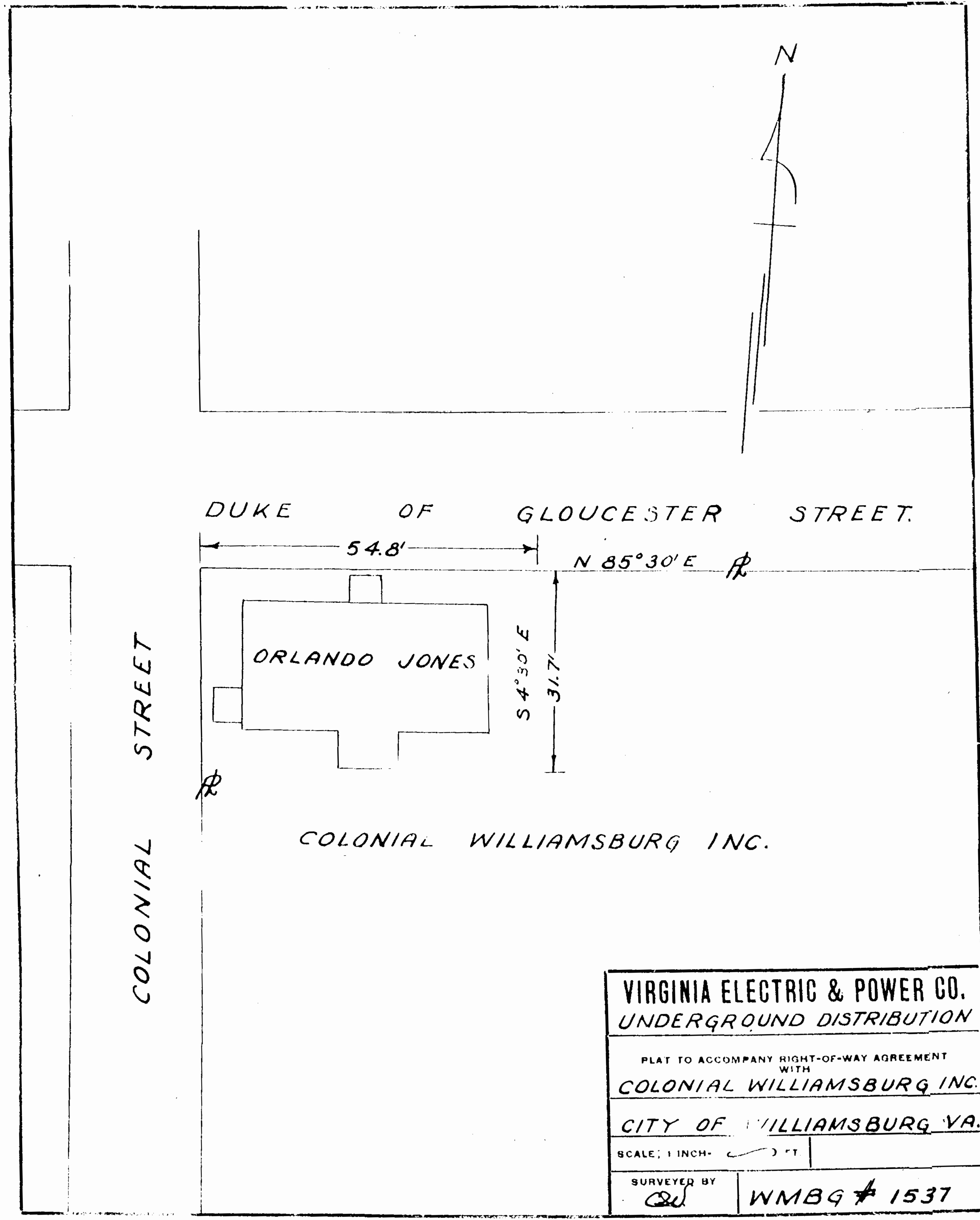

VIRGINIA ELECTRIC & POWER CO.  
 UNDERGROUND DISTRIBUTION  
 PLAT TO ACCOMPANY RIGHT-OF-WAY AGREEMENT  
 WITH  
 COLONIAL WILLIAMSBURG INC.  
 CITY OF WILLIAMSBURG VA.  
 SCALE: 1 INCH = 30 FT.  
 SURVEYED BY  
 WMBG # 1537

DRAWER NO SHEET NO