

Recorded June 15, 1938  
in  
D. B. 30 page 96  
*W. A. Blauhaard* Clerk

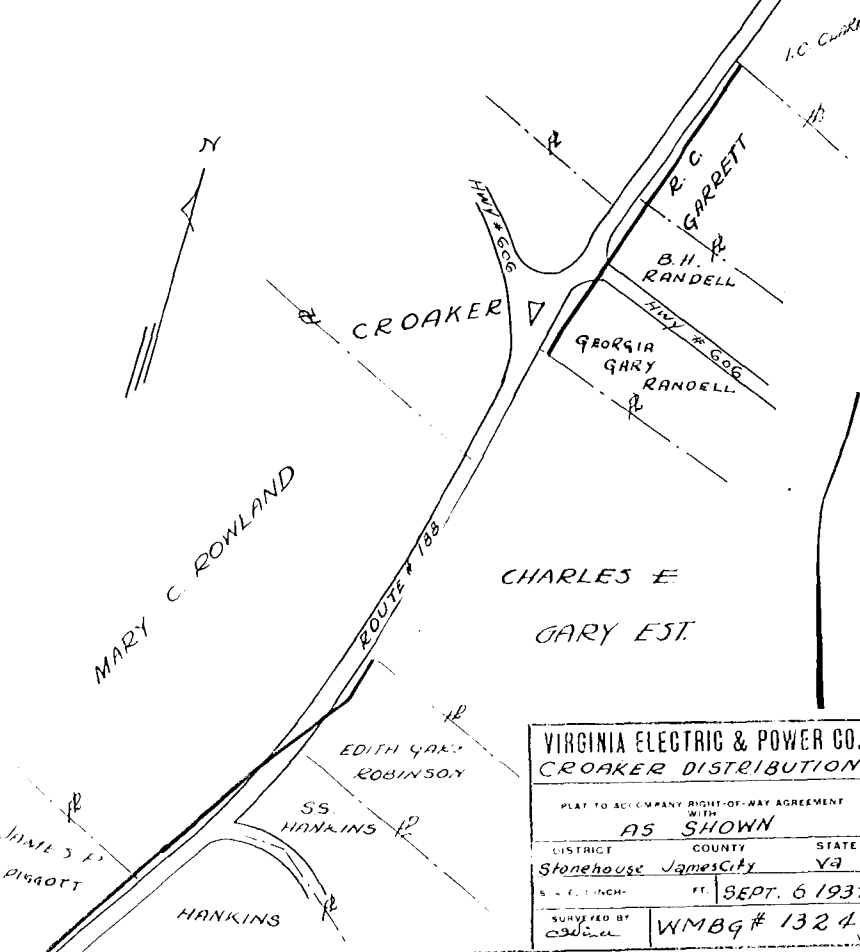

VIRGINIA ELECTRIC & POWER CO.  
CROAKER DISTRIBUTION  
PLAT TO ACCOMPANY RIGHT-OF-WAY AGREEMENT  
WITH  
**AS SHOWN**  
DISTRICT COUNTY STATE  
Stonehouse James City Va  
SCALE: 1 INCH = 100 FT. SEPT. 6 1937  
SURVEYED BY  
WMBG # 1324

Recorded June 15, 1938  
in  
D. B. 30 page 92  
*W. A. Blauhaard* Clerk

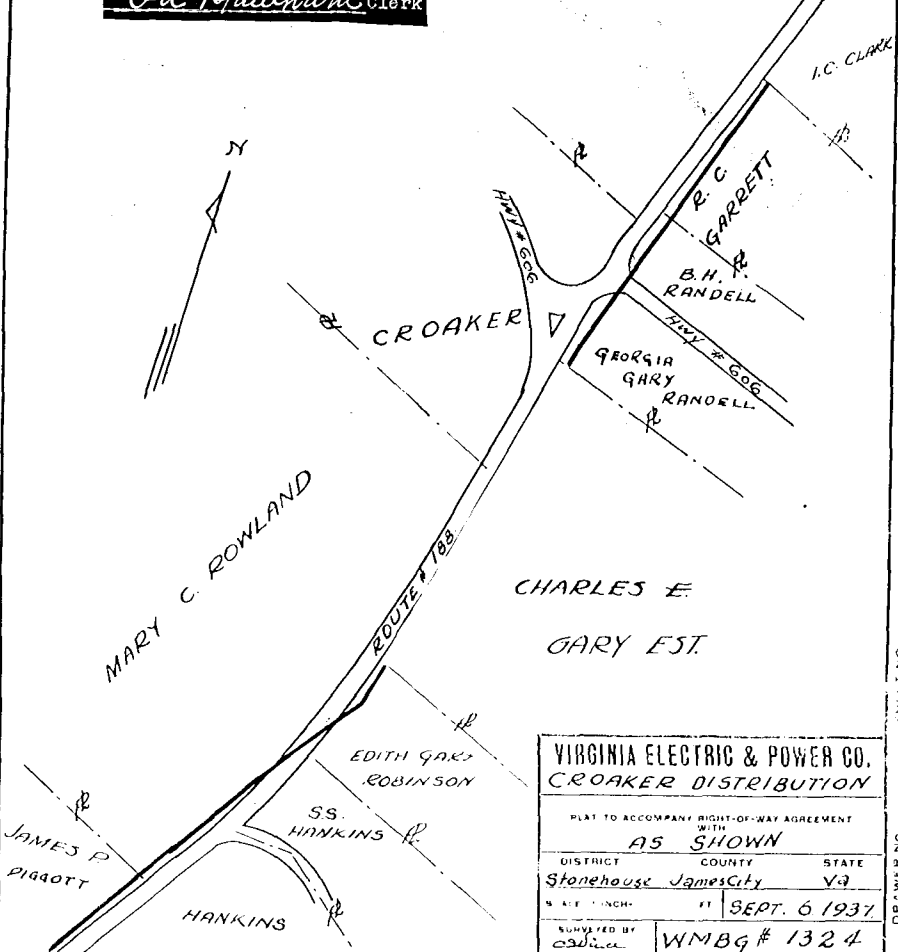

VIRGINIA ELECTRIC & POWER CO.  
CROAKER DISTRIBUTION  
PLAT TO ACCOMPANY RIGHT-OF-WAY AGREEMENT  
WITH  
**AS SHOWN**  
DISTRICT COUNTY STATE  
Stonehouse James City Va  
SCALE: 1 INCH = 100 FT. SEPT. 6 1937  
SURVEYED BY  
WMBG # 1324

Recorded June 15, 1938,  
in  
D. B. 30, page 102  
*W. A. Blauhaard* Clerk

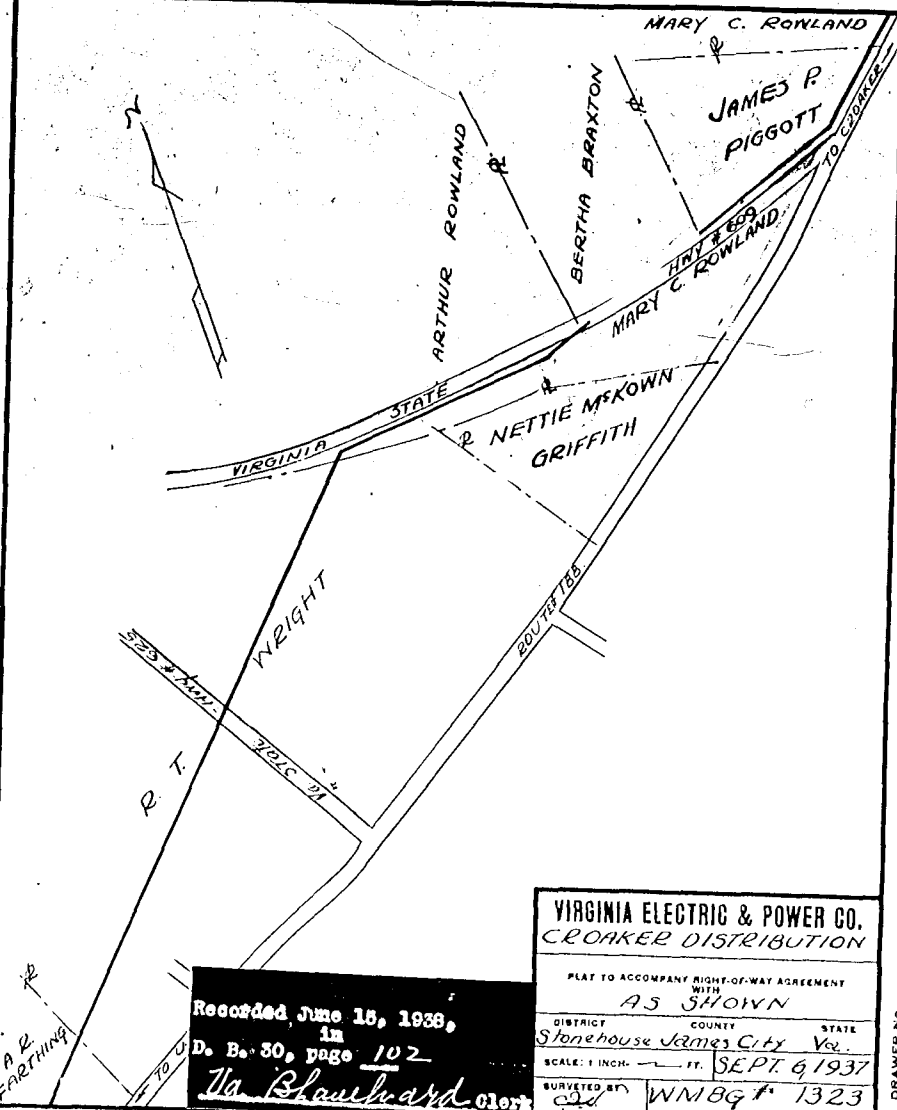

VIRGINIA ELECTRIC & POWER CO.  
CROAKER DISTRIBUTION  
PLAT TO ACCOMPANY RIGHT-OF-WAY AGREEMENT  
WITH  
**AS SHOWN**  
DISTRICT COUNTY STATE  
Stonehouse James City Va  
SCALE: 1 INCH = 100 FT. SEPT. 6 1937  
SURVEYED BY  
WMBG # 1323

Recorded June 15, 1938,  
in  
D. B. No. 30, page 104  
*W. A. Blauhaard* Clerk

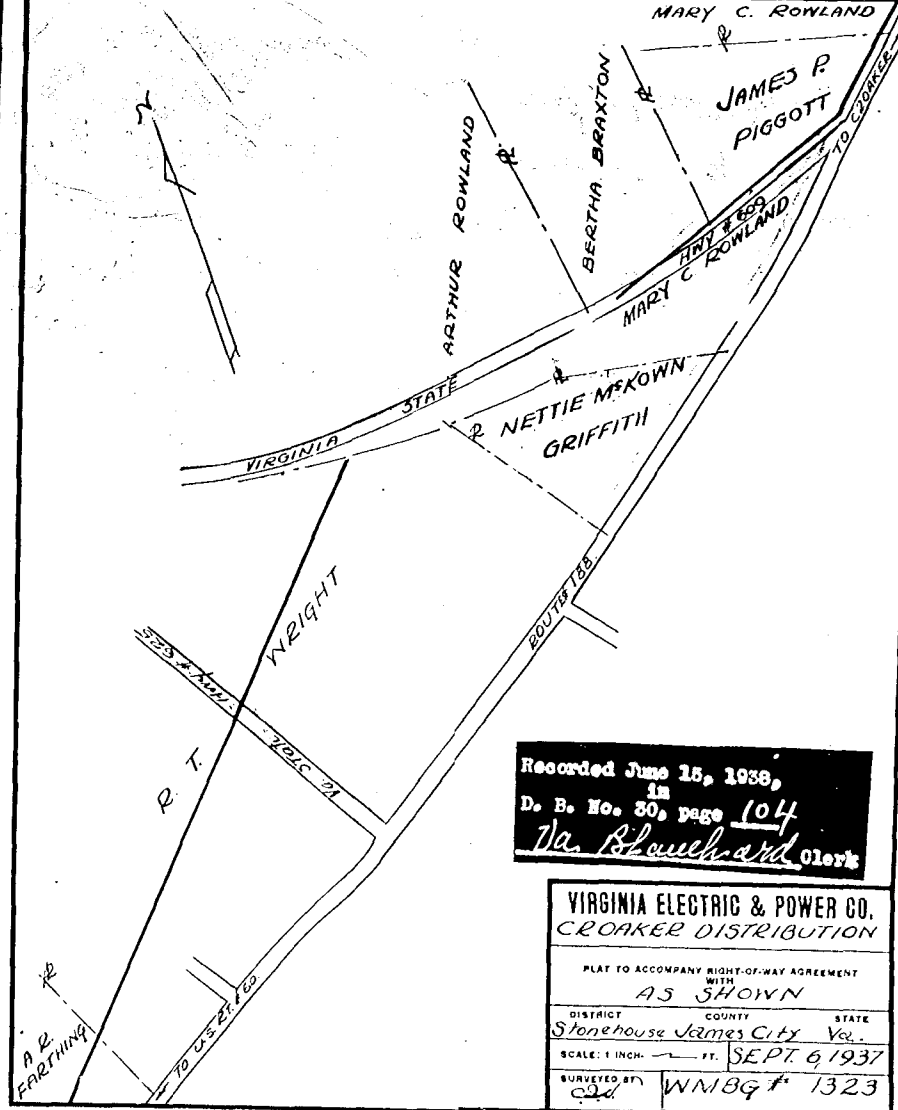

VIRGINIA ELECTRIC & POWER CO.  
CROAKER DISTRIBUTION  
PLAT TO ACCOMPANY RIGHT-OF-WAY AGREEMENT  
WITH  
**AS SHOWN**  
DISTRICT COUNTY STATE  
Stonehouse James City Va  
SCALE: 1 INCH = 100 FT. SEPT. 6 1937  
SURVEYED BY  
WMBG # 1323

Recorded June 15, 1938  
in  
D. B. 30 page 94  
*W. A. Blauhaard* Clerk

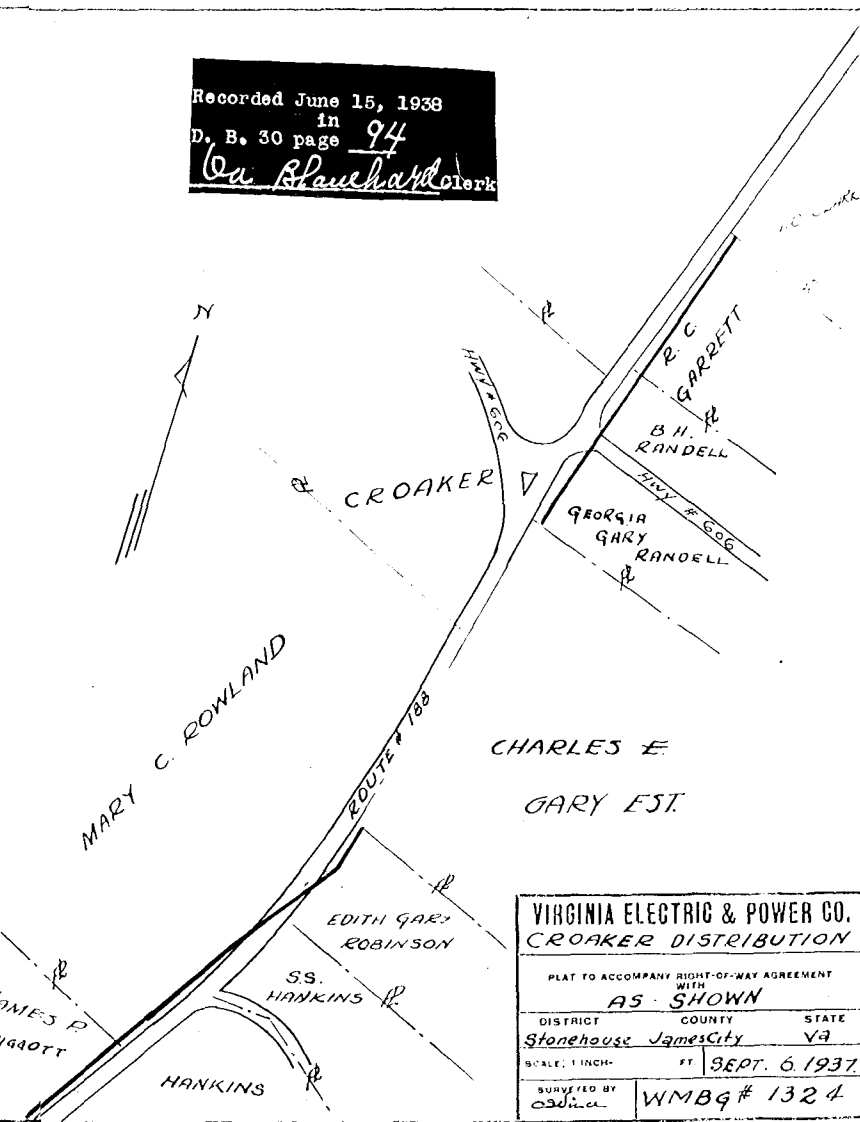

VIRGINIA ELECTRIC & POWER CO.  
CROAKER DISTRIBUTION  
PLAT TO ACCOMPANY RIGHT-OF-WAY AGREEMENT  
WITH  
**AS SHOWN**  
DISTRICT COUNTY STATE  
Stonehouse James City Va  
SCALE: 1 INCH = 100 FT. SEPT. 6 1937  
SURVEYED BY  
WMBG # 1324

Recorded June 15, 1938  
in  
D. B. 30 page 91  
*W. A. Blauhaard* Clerk

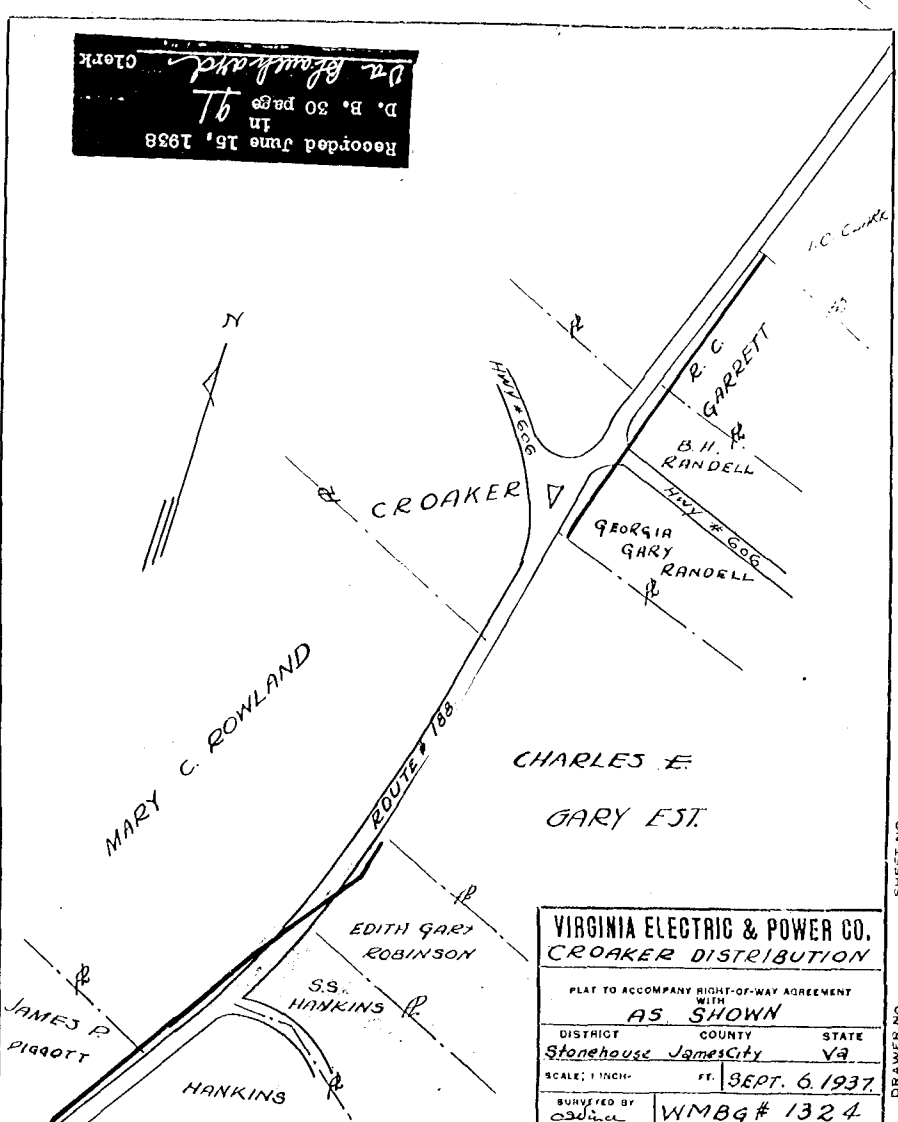

VIRGINIA ELECTRIC & POWER CO.  
CROAKER DISTRIBUTION  
PLAT TO ACCOMPANY RIGHT-OF-WAY AGREEMENT  
WITH  
**AS SHOWN**  
DISTRICT COUNTY STATE  
Stonehouse James City Va  
SCALE: 1 INCH = 100 FT. SEPT. 6 1937  
SURVEYED BY  
WMBG # 1324

Recorded June 15, 1938  
in  
D. B. 30 page 101  
*W. A. Blauhaard* Clerk

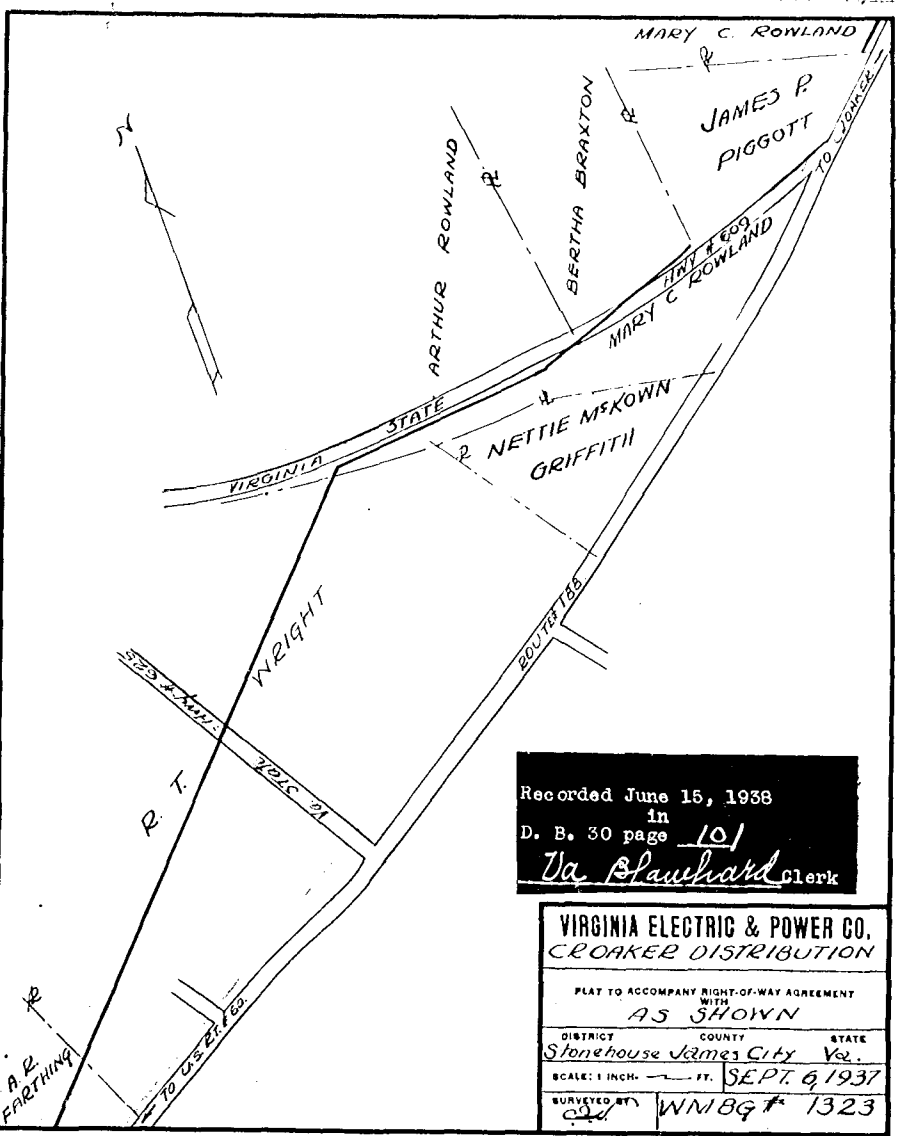

VIRGINIA ELECTRIC & POWER CO.  
CROAKER DISTRIBUTION  
PLAT TO ACCOMPANY RIGHT-OF-WAY AGREEMENT  
WITH  
**AS SHOWN**  
DISTRICT COUNTY STATE  
Stonehouse James City Va  
SCALE: 1 INCH = 100 FT. SEPT. 6 1937  
SURVEYED BY  
WMBG # 1323

Recorded June 15, 1938  
in  
D. B. 30, page 104  
*W. A. Blauhaard* Clerk

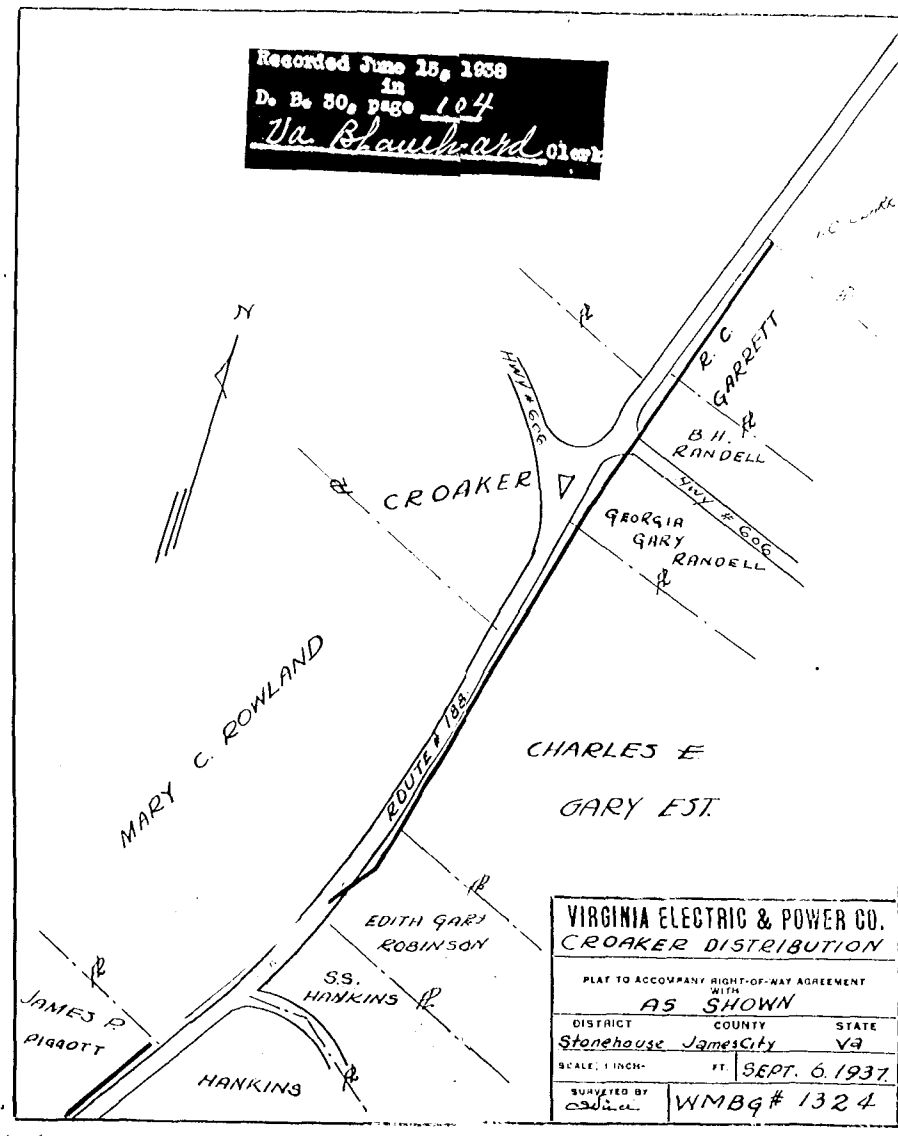

VIRGINIA ELECTRIC & POWER CO.  
CROAKER DISTRIBUTION  
PLAT TO ACCOMPANY RIGHT-OF-WAY AGREEMENT  
WITH  
**AS SHOWN**  
DISTRICT COUNTY STATE  
Stonehouse James City Va  
SCALE: 1 INCH = 100 FT. SEPT. 6 1937  
SURVEYED BY  
WMBG # 1324

