

CAPITOL HEIGHTS WILLIAMSBURG-VA.

PROPERTY OF
POWER CITY INVESTMENT CO., INC.

WILLIAMSBURG OFFICE
ROOM 2-RL SPENCER

OFFICES AT
WILLIAMSBURG VA.
ALBEMARLE, NC.
BADIN-NC

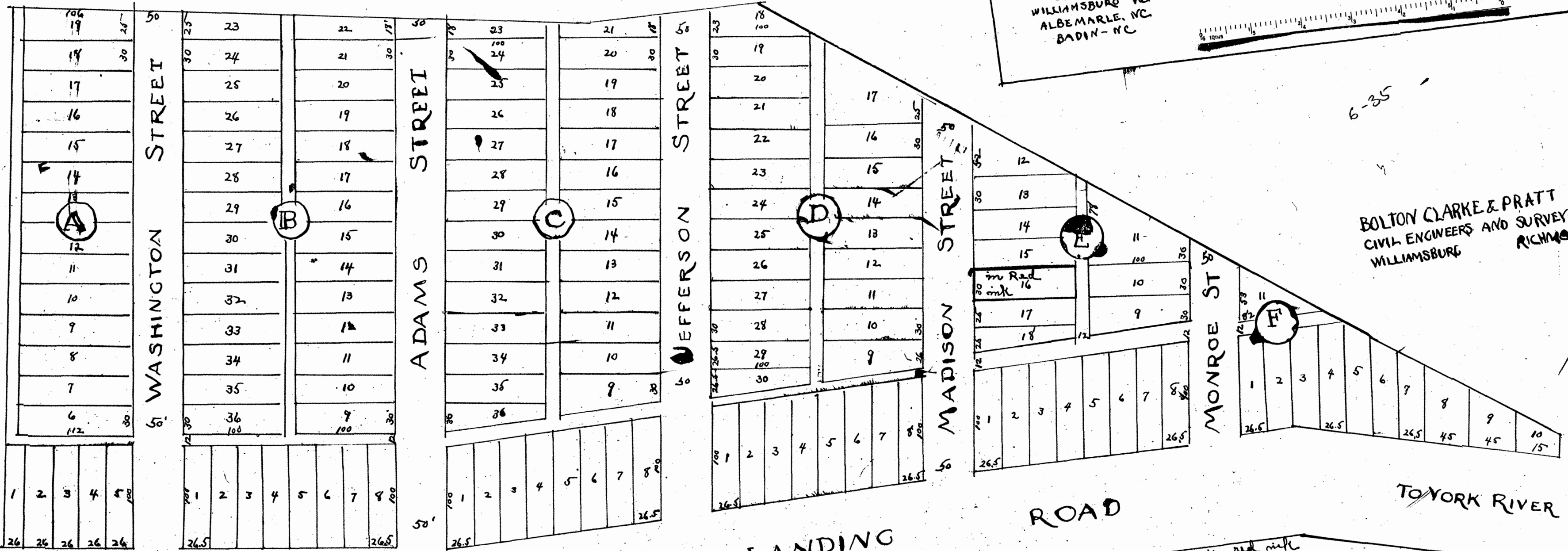
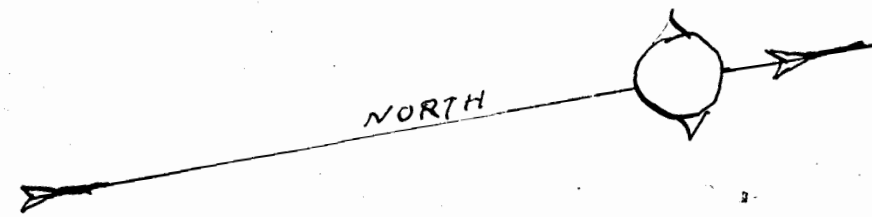
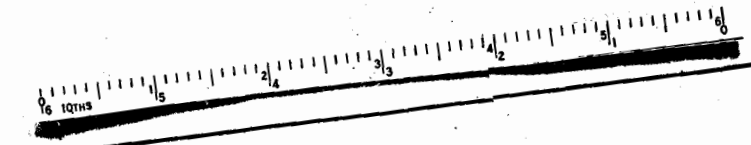

6-35
BOLTON CLARKE & PRATT INC
CIVIL ENGINEERS AND SURVEYORS
WILLIAMSBURG RICHMOND

← TO WILLIAMSBURG

CAPITOL

LANDING

ROAD

→ TO YORK RIVER

area sought to be condemned shown in red ink

NOTE
STREETS ARE 50 FEET WIDE
ALLEYS ARE 12 FEET WIDE

Recorded April 19, 1935
15 B 16, P 166-70

Traced from plat filed in the office of
the Circuit Court of Williamsburg
James City County, Va.
PLAT BOOK-NO 2 - PAGE 31

Traced by JMK-NOV 2 1934
EASTERN DIVISION-BRANCH OF ENGINEERING