

Recorded Feb. 6, 1934,  
in  
D. B. #27, p. 434  
Virginia Blount Clerk

**VIRGINIA ELECTRIC & POWER CO.**  
WILLIAMSBURG-TOANO DISTRIBUTION  
TRANSMISSION LINE  
PLAT TO ACCOMPANY RIGHT-OF-WAY AGREEMENT  
WITH  
**MARSTON & EPPS & OTHERS**  
DISTRICT: JAMESTOWN COUNTY: JAMES CITY STATE: VIRGINIA  
SCALE: 1 INCH = 100 FEET  
DATE: SEPT. 3, 1933  
SURVEYED BY: D.A.H. WMBG # 1090

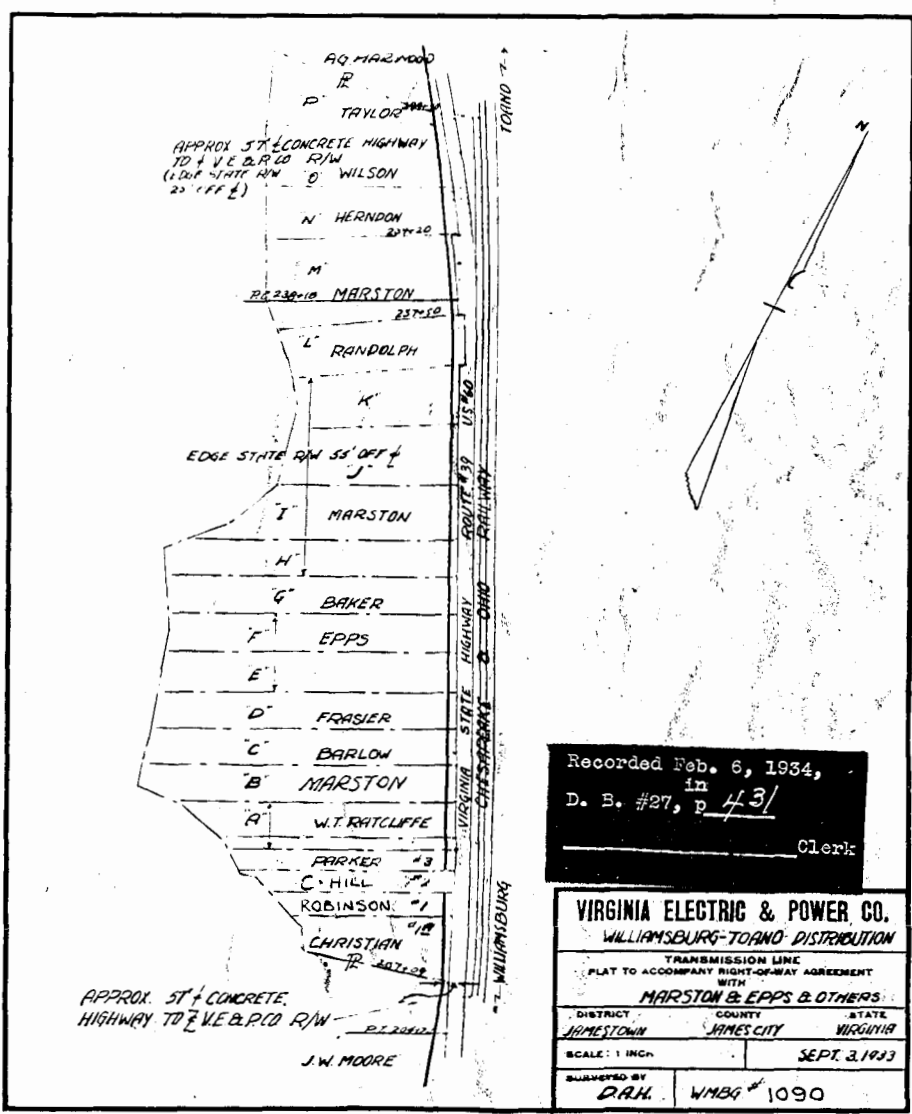

Recorded Feb. 6, 1934,  
in  
D. B. #27, p. 431  
Clerk

**VIRGINIA ELECTRIC & POWER CO.**  
WILLIAMSBURG-TOANO DISTRIBUTION  
TRANSMISSION LINE  
PLAT TO ACCOMPANY RIGHT-OF-WAY AGREEMENT  
WITH  
**MARSTON & EPPS & OTHERS**  
DISTRICT: JAMESTOWN COUNTY: JAMES CITY STATE: VIRGINIA  
SCALE: 1 INCH = 100 FEET  
DATE: SEPT. 3, 1933  
SURVEYED BY: D.A.H. WMBG # 1090

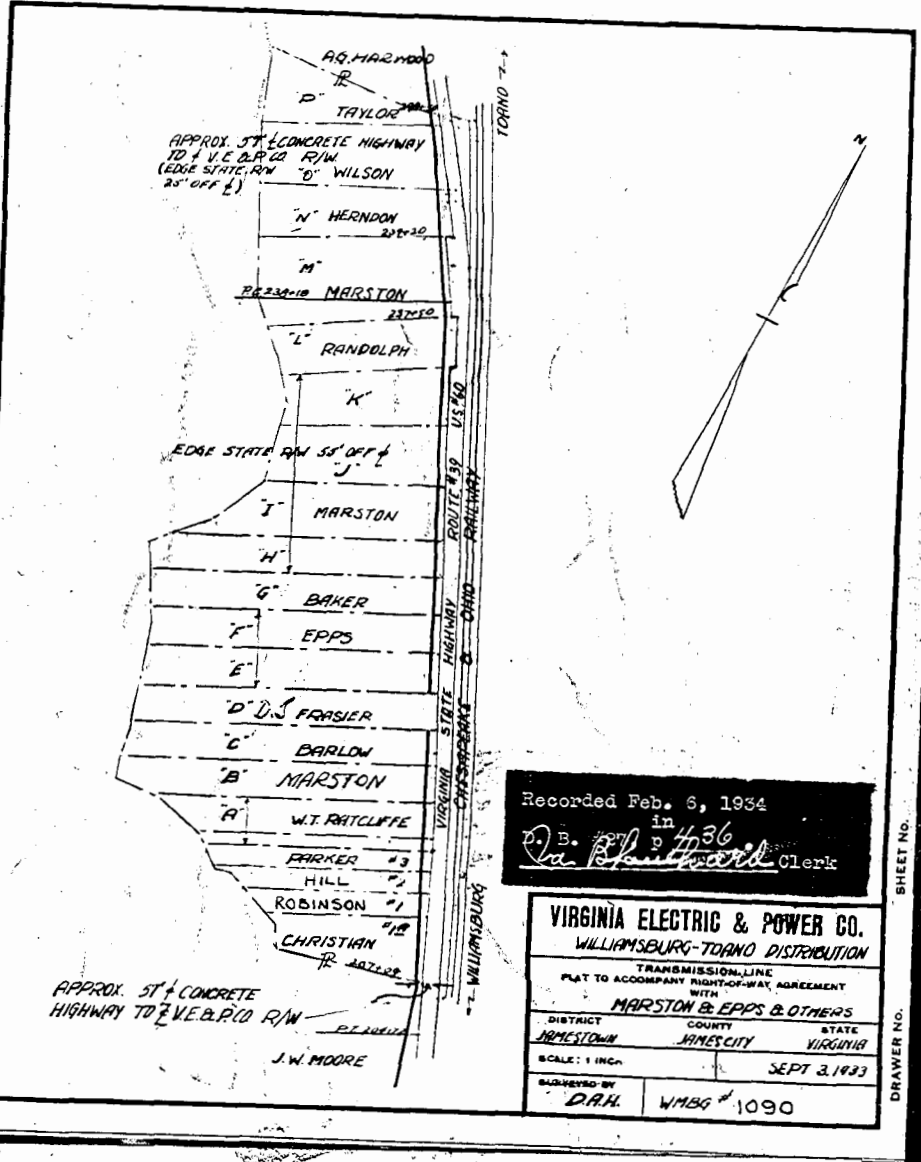

Recorded Feb. 6, 1934,  
in  
D. B. #27, p. 436  
Virginia Blount Clerk

**VIRGINIA ELECTRIC & POWER CO.**  
WILLIAMSBURG-TOANO DISTRIBUTION  
TRANSMISSION LINE  
PLAT TO ACCOMPANY RIGHT-OF-WAY AGREEMENT  
WITH  
**MARSTON & EPPS & OTHERS**  
DISTRICT: JAMESTOWN COUNTY: JAMES CITY STATE: VIRGINIA  
SCALE: 1 INCH = 100 FEET  
DATE: SEPT. 3, 1933  
SURVEYED BY: D.A.H. WMBG # 1090

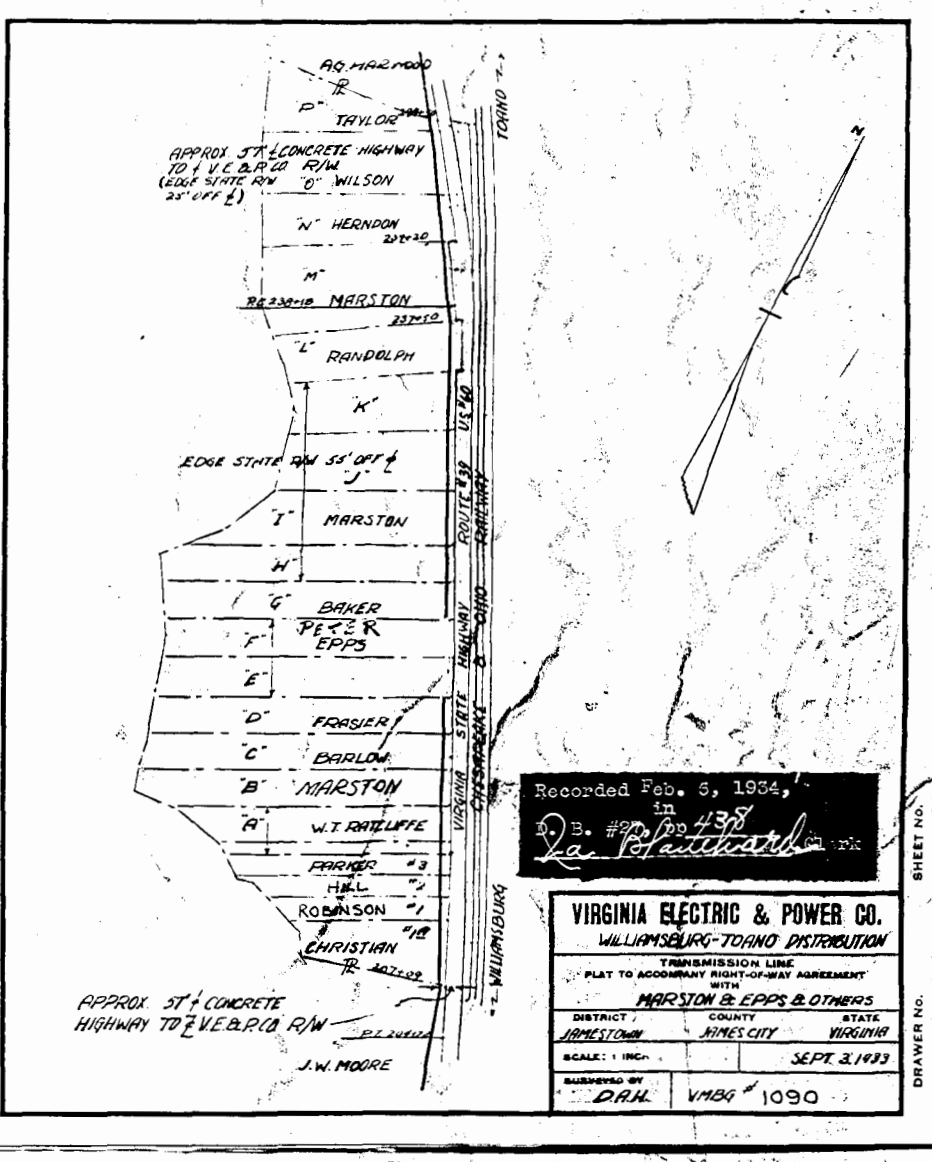

Recorded Feb. 6, 1934,  
in  
D. B. #27, p. 438  
Virginia Blount Clerk

**VIRGINIA ELECTRIC & POWER CO.**  
WILLIAMSBURG-TOANO DISTRIBUTION  
TRANSMISSION LINE  
PLAT TO ACCOMPANY RIGHT-OF-WAY AGREEMENT  
WITH  
**MARSTON & EPPS & OTHERS**  
DISTRICT: JAMESTOWN COUNTY: JAMES CITY STATE: VIRGINIA  
SCALE: 1 INCH = 100 FEET  
DATE: SEPT. 3, 1933  
SURVEYED BY: D.A.H. WMBG # 1090

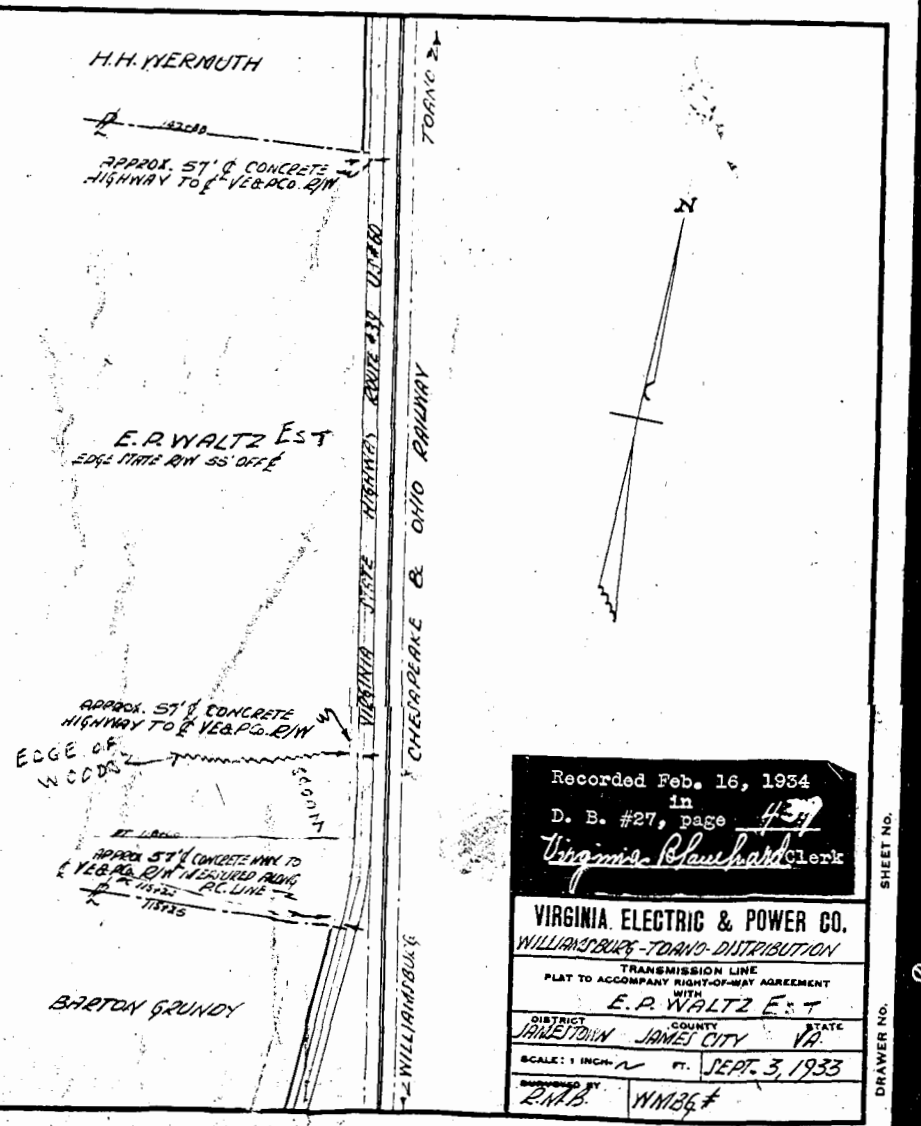

Recorded Feb. 16, 1934,  
in  
D. B. #27, p. 437  
Virginia Blount Clerk

**VIRGINIA ELECTRIC & POWER CO.**  
WILLIAMSBURG-TOANO DISTRIBUTION  
TRANSMISSION LINE  
PLAT TO ACCOMPANY RIGHT-OF-WAY AGREEMENT  
WITH  
**E. P. WALTZ EST**  
DISTRICT: JAMESTOWN COUNTY: JAMES CITY STATE: VA  
SCALE: 1 INCH = 100 FEET  
DATE: SEPT. 3, 1933  
SURVEYED BY: D.A.H. WMBG # 1090

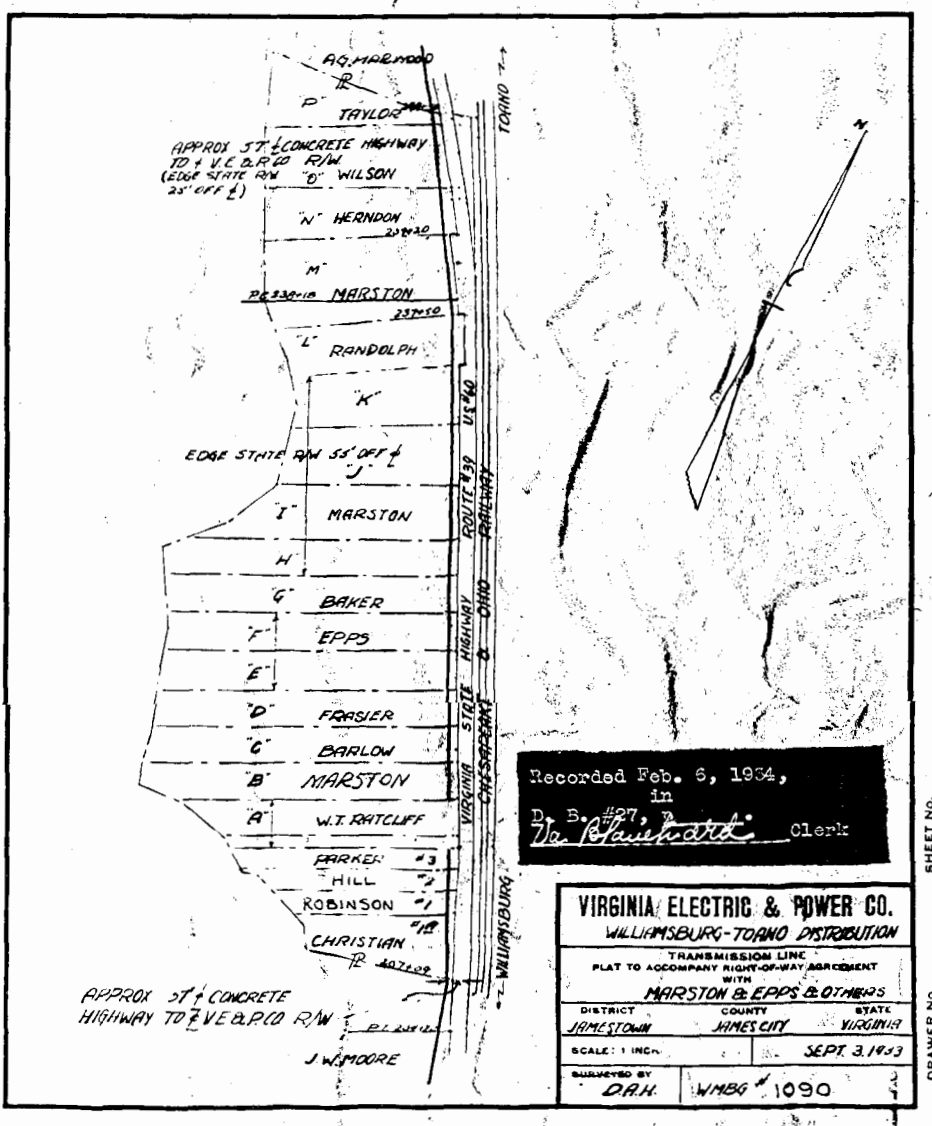

Recorded Feb. 6, 1934,  
in  
D. B. #27, p. 439  
Virginia Blount Clerk

**VIRGINIA ELECTRIC & POWER CO.**  
WILLIAMSBURG-TOANO DISTRIBUTION  
TRANSMISSION LINE  
PLAT TO ACCOMPANY RIGHT-OF-WAY AGREEMENT  
WITH  
**MARSTON & EPPS & OTHERS**  
DISTRICT: JAMESTOWN COUNTY: JAMES CITY STATE: VIRGINIA  
SCALE: 1 INCH = 100 FEET  
DATE: SEPT. 3, 1933  
SURVEYED BY: D.A.H. WMBG # 1090