

Recorded Jany. 29, 1934,
in
D. B. No. 27, pp 380.
Va. Blanchard Clerk

VIRGINIA ELECTRIC & POWER CO. WILLIAMSBURG DISTRIBUTION.		
TRANSMISSION LINE PLAT TO ACCOMPANY RIGHT-OF-WAY AGREEMENT WITH G.E. MAHONE AND ANNIE P. MAHONE		
DISTRICT	COUNTY	STATE
JAMESTOWN	JAMES CITY	VA.
SCALE: 1 INCH = 100' FT. NOV. 18, 1933		
SURVEYED BY A.H.M.		WMSBG. #1069

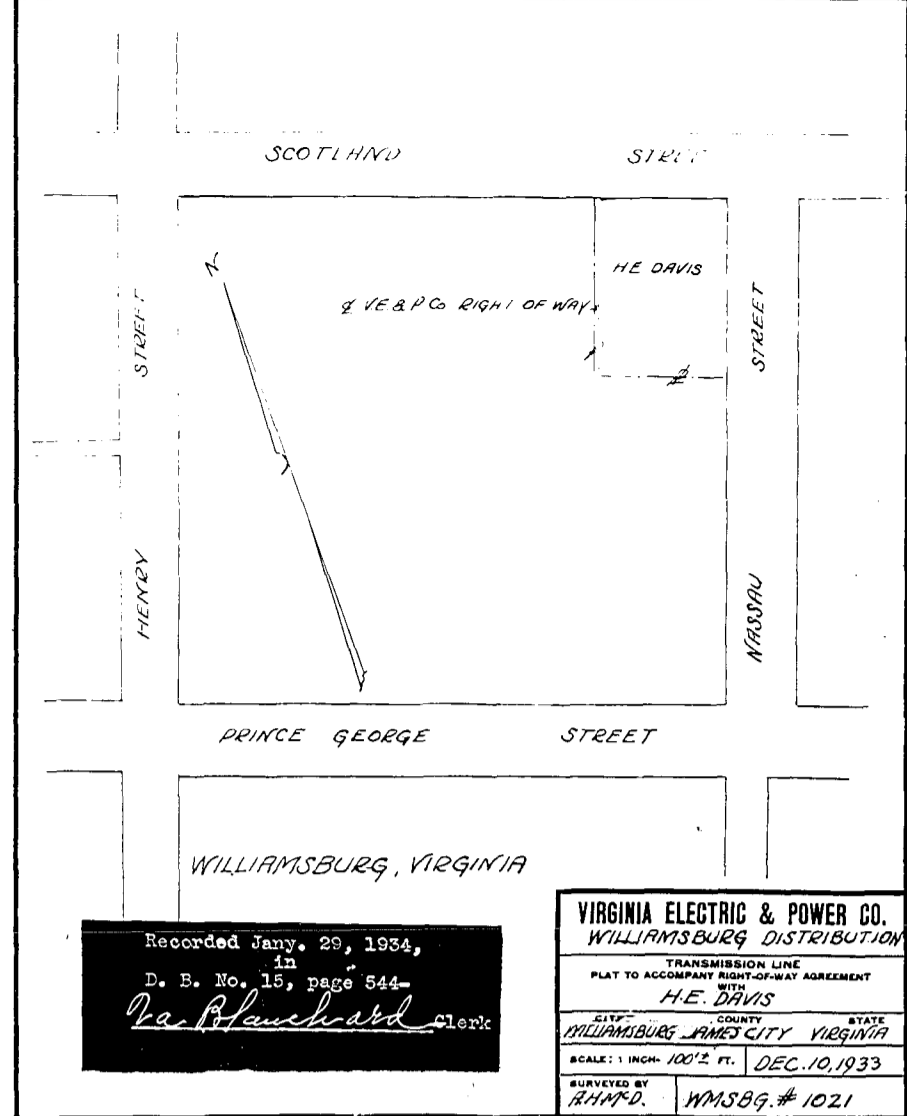

Recorded Jany. 29, 1934,
in
D. B. No. 15, page 544-
Va. Blanchard Clerk

VIRGINIA ELECTRIC & POWER CO. WILLIAMSBURG DISTRIBUTION.		
TRANSMISSION LINE PLAT TO ACCOMPANY RIGHT-OF-WAY AGREEMENT WITH H.E. DAVIS		
DISTRICT	COUNTY	STATE
WILLIAMSBURG	JAMES CITY	VIRGINIA
SCALE: 1 INCH = 100' FT. DEC. 10, 1933		
SURVEYED BY A.H.M.		WMSBG. #1021

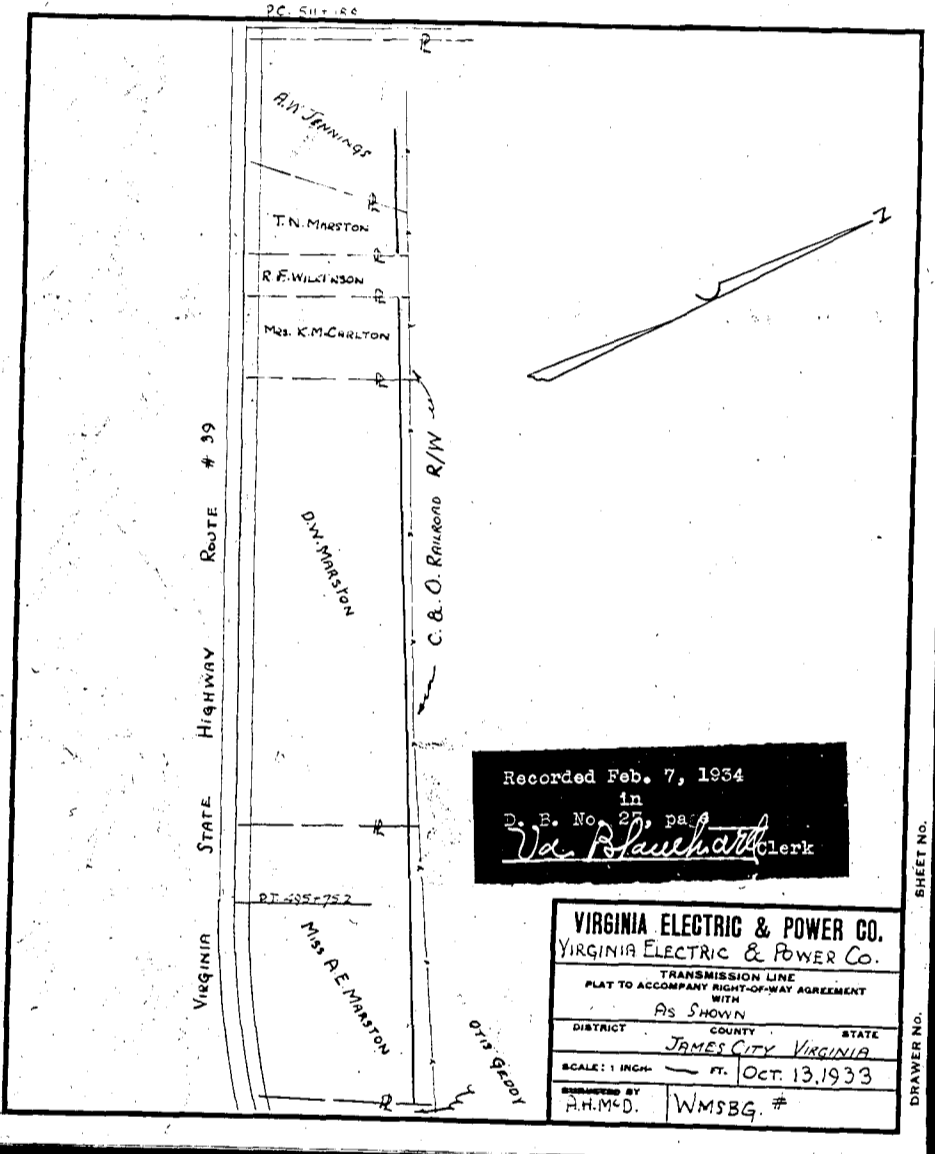

Recorded Feb. 7, 1934,
in
D. B. No. 27, pa.
Va. Blanchard Clerk

VIRGINIA ELECTRIC & POWER CO. VIRGINIA ELECTRIC & POWER CO.		
TRANSMISSION LINE PLAT TO ACCOMPANY RIGHT-OF-WAY AGREEMENT WITH AS SHOWN		
DISTRICT	COUNTY	STATE
JAMES CITY	JAMES CITY	VIRGINIA
SCALE: 1 INCH = 100' FT. OCT. 13, 1933		
SURVEYED BY A.H.M.		WMSBG. #

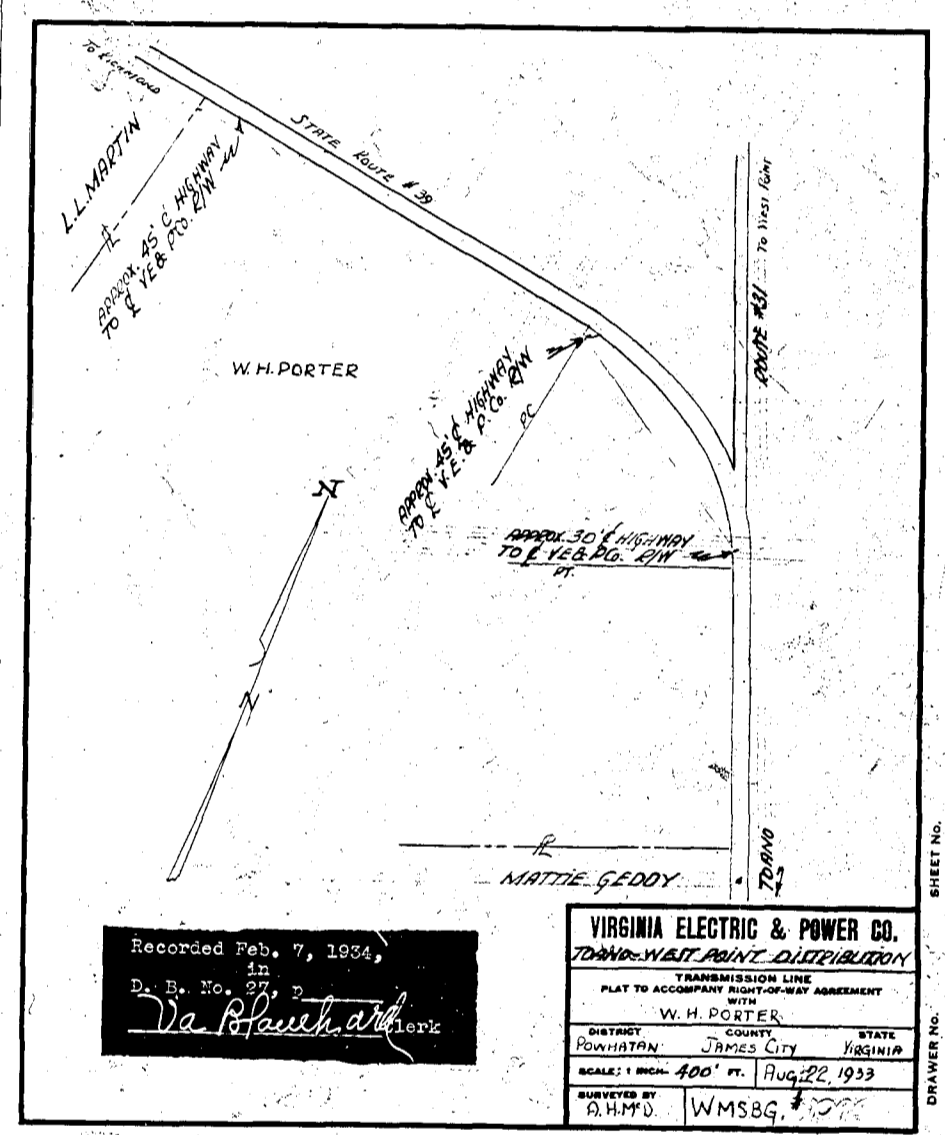

Recorded Feb. 7, 1934,
in
D. B. No. 27, p
Va. Blanchard Clerk

VIRGINIA ELECTRIC & POWER CO. TOWN-WEST POINT DISTRIBUTION		
TRANSMISSION LINE PLAT TO ACCOMPANY RIGHT-OF-WAY AGREEMENT WITH W.H. PORTER		
DISTRICT	COUNTY	STATE
POWhatan	JAMES CITY	VIRGINIA
SCALE: 1 INCH = 400' FT. Aug. 22, 1933		
SURVEYED BY A.H.M.		WMSBG. #

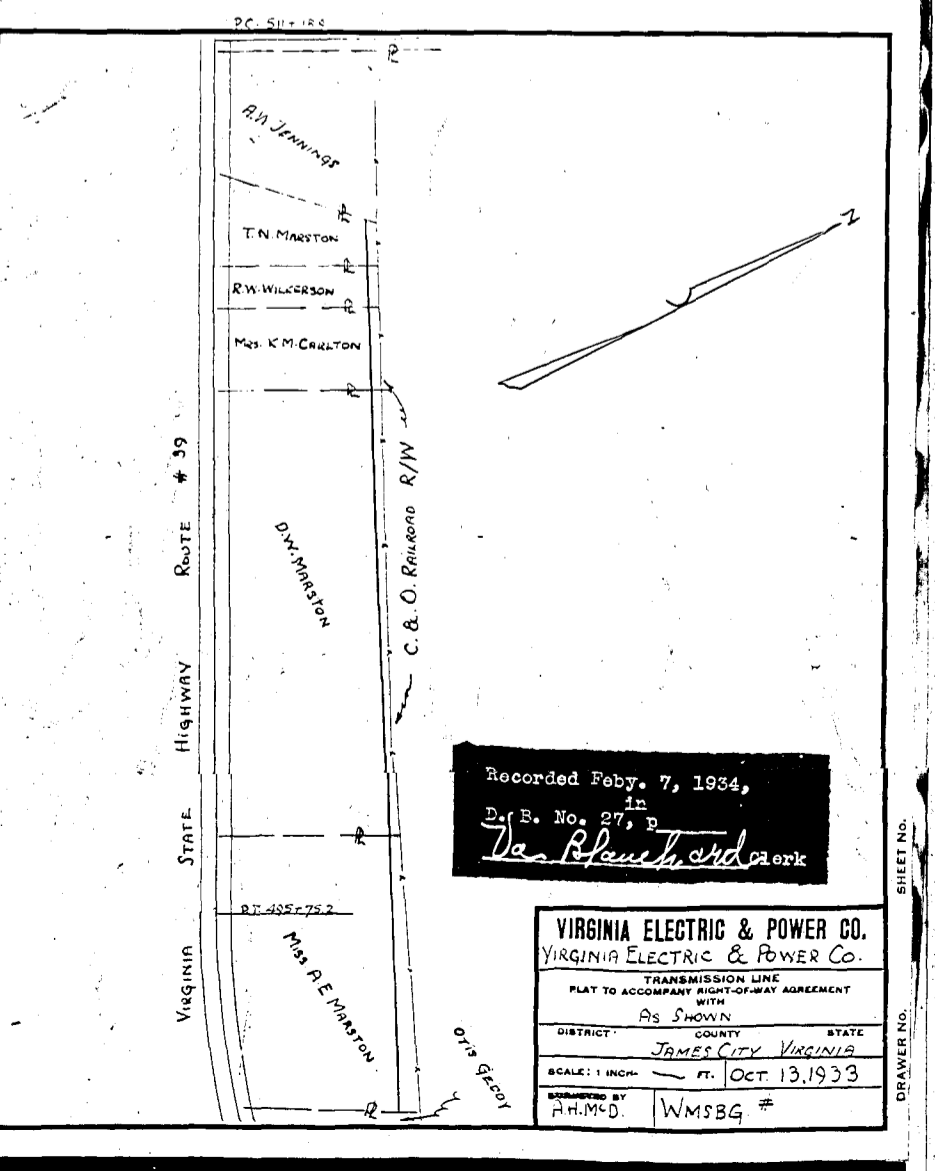

Recorded Feb. 7, 1934,
in
D. B. No. 27, p
Va. Blanchard Clerk

VIRGINIA ELECTRIC & POWER CO. VIRGINIA ELECTRIC & POWER CO.		
TRANSMISSION LINE PLAT TO ACCOMPANY RIGHT-OF-WAY AGREEMENT WITH AS SHOWN		
DISTRICT	COUNTY	STATE
JAMES CITY	JAMES CITY	VIRGINIA
SCALE: 1 INCH = 100' FT. OCT. 13, 1933		
SURVEYED BY A.H.M.		WMSBG. #

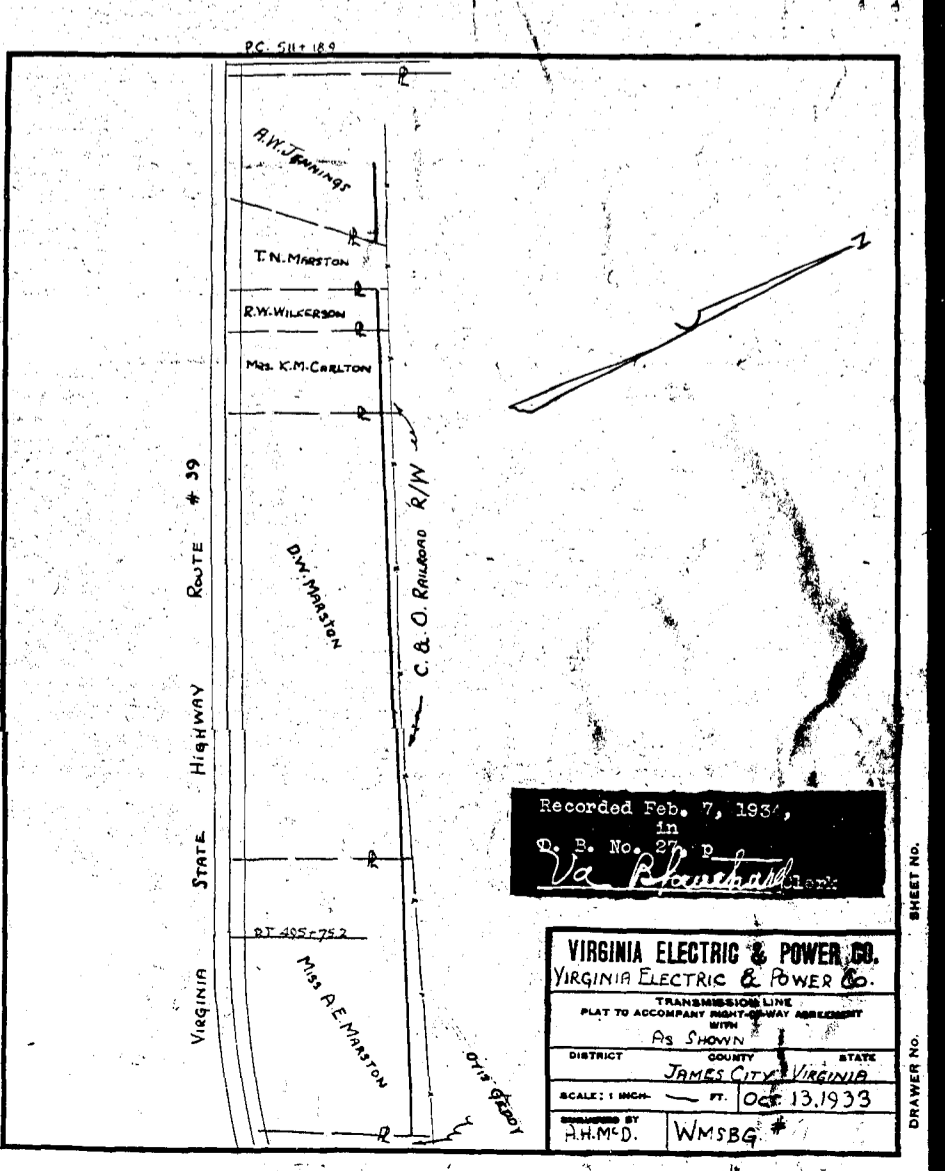

Recorded Feb. 7, 1934,
in
D. B. No. 27, p
Va. Blanchard Clerk

VIRGINIA ELECTRIC & POWER CO. VIRGINIA ELECTRIC & POWER CO.		
TRANSMISSION LINE PLAT TO ACCOMPANY RIGHT-OF-WAY AGREEMENT WITH AS SHOWN		
DISTRICT	COUNTY	STATE
JAMES CITY	JAMES CITY	VIRGINIA
SCALE: 1 INCH = 100' FT. OCT. 13, 1933		
SURVEYED BY A.H.M.		WMSBG. #