

VIRGINIA ELECTRIC & POWER CO.
 Williamsburg Jamesstown Distribu.
 TRANSMISSION LINE
 PLAT TO ACCOMPANY RIGHT-OF-WAY AGREEMENT
 WITH
F. RAYERS & C. FAYERS
 DISTRICT COUNTY STATE
 Jamesstown James City Virginia
 SCALE: 1 INCH = 100 FT. MAY 3, 1932
 SURVEYED BY
E.B.H. WMBG #1008

Recorded May 28, 1932,
 in
 D. B. #26, pages 521-2
Virginia Blanchard, Clerk

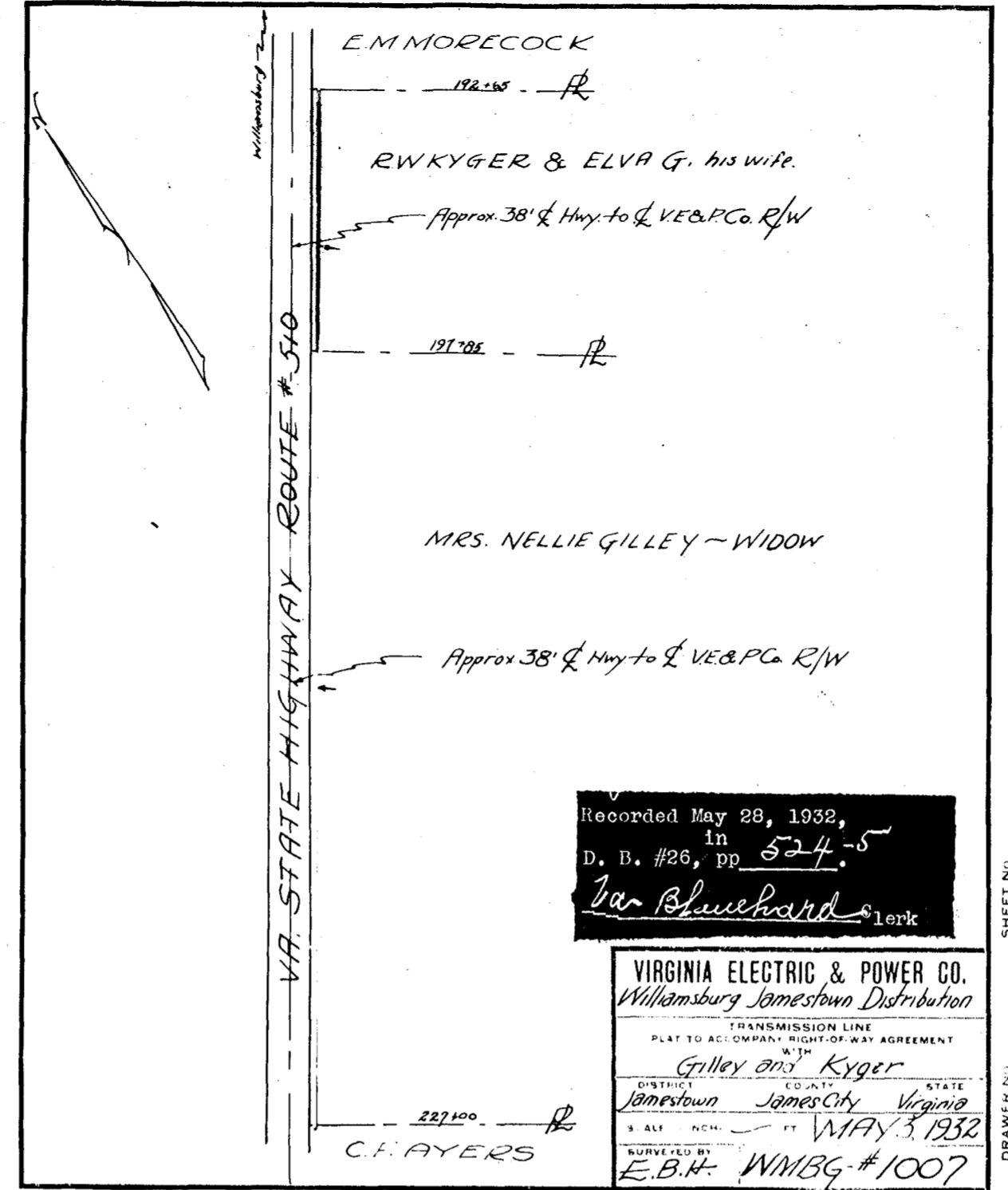

VIRGINIA ELECTRIC & POWER CO.
 Williamsburg Jamesstown Distribution
 TRANSMISSION LINE
 PLAT TO ACCOMPANY RIGHT-OF-WAY AGREEMENT
 WITH
Gilley and Kyger
 DISTRICT COUNTY STATE
 Jamesstown James City Virginia
 SCALE: 1 INCH = 100 FT. MAY 3, 1932
 SURVEYED BY
E.B.H. WMBG #1007

Recorded May 28, 1932,
 in
 D. B. #26, pp 524-5
Van Blanchard, Clerk

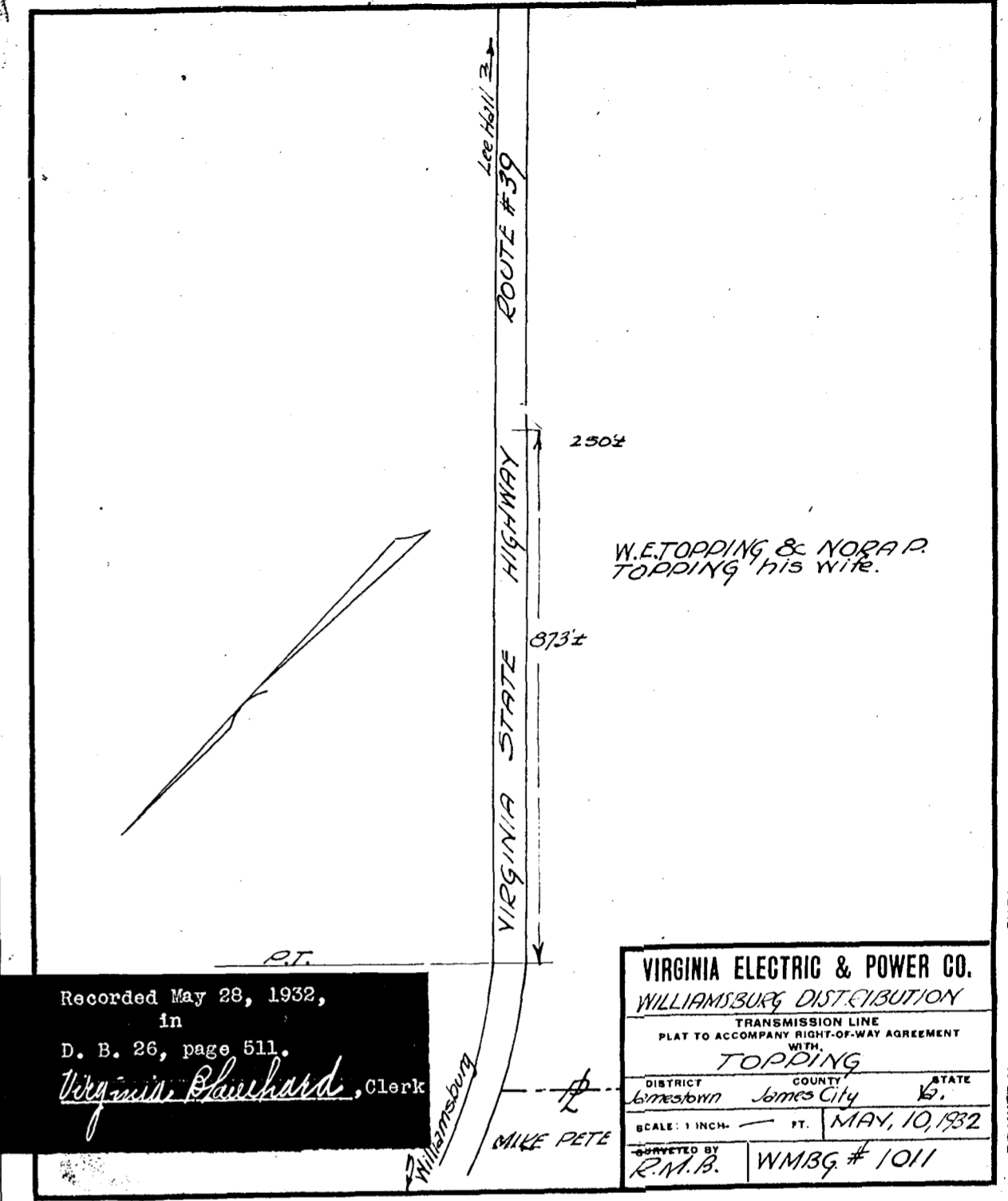

VIRGINIA ELECTRIC & POWER CO.
 WILLIAMSBURG DISTRIBUTION
 TRANSMISSION LINE
 PLAT TO ACCOMPANY RIGHT-OF-WAY AGREEMENT
 WITH
TOPPING
 DISTRICT COUNTY STATE
 Jamesstown James City Va.
 SCALE: 1 INCH = 100 FT. MAY 10, 1932
 SURVEYED BY
R.M.B. WMBG #1011

Recorded May 28, 1932,
 in
 D. B. 26, page 511.
Virginia Blanchard, Clerk

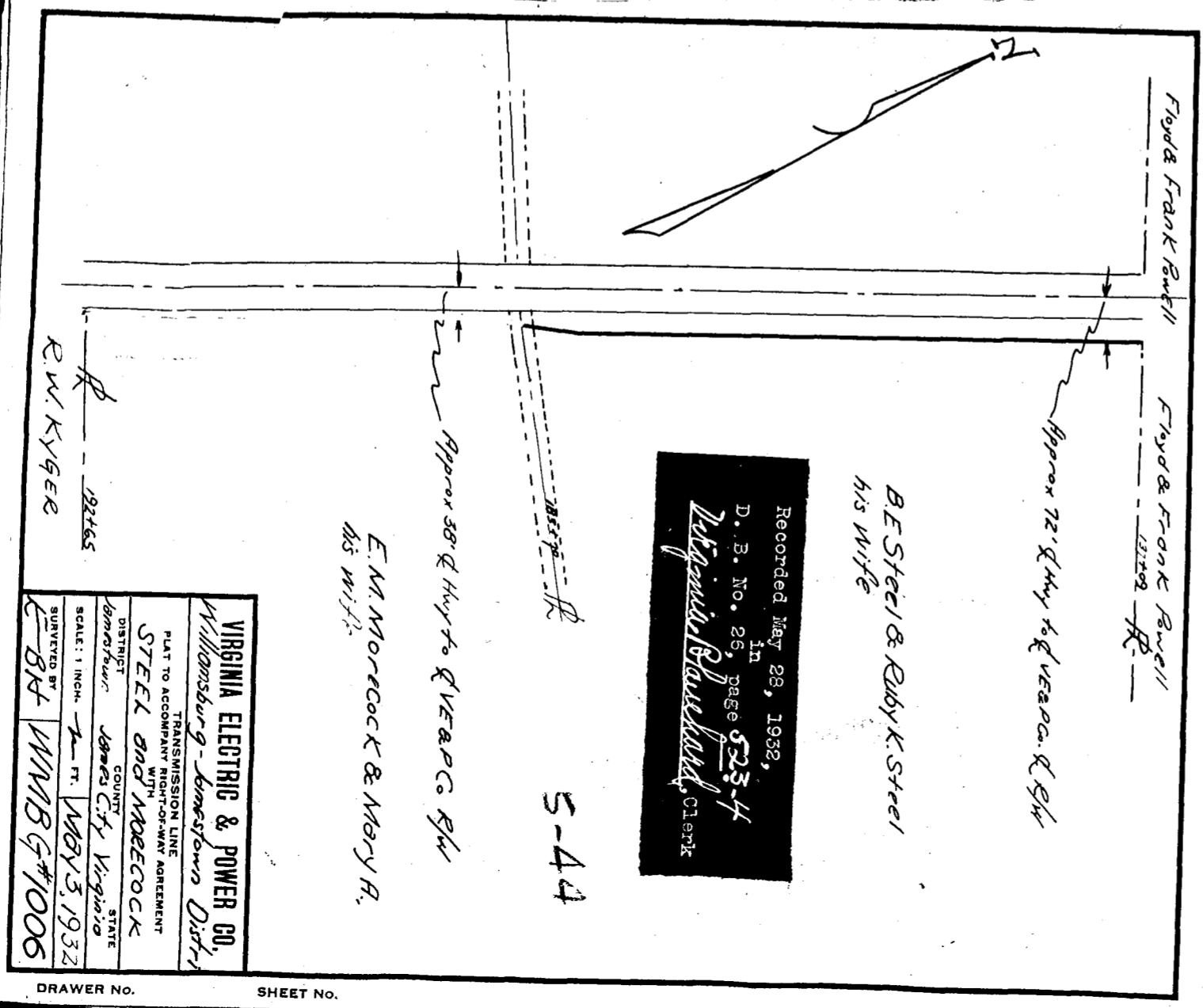

VIRGINIA ELECTRIC & POWER CO.
 Williamsburg Jamesstown Distribu.
 TRANSMISSION LINE
 PLAT TO ACCOMPANY RIGHT-OF-WAY AGREEMENT
 WITH
STEEL AND MORECOCK
 DISTRICT COUNTY STATE
 Jamesstown James City Virginia
 SCALE: 1 INCH = 100 FT. MAY 3, 1932
 SURVEYED BY
E.B.H. WMBG #1006

Recorded May 28, 1932,
 in
 D. B. No. 26, page 533-4
Virginia Blanchard, Clerk

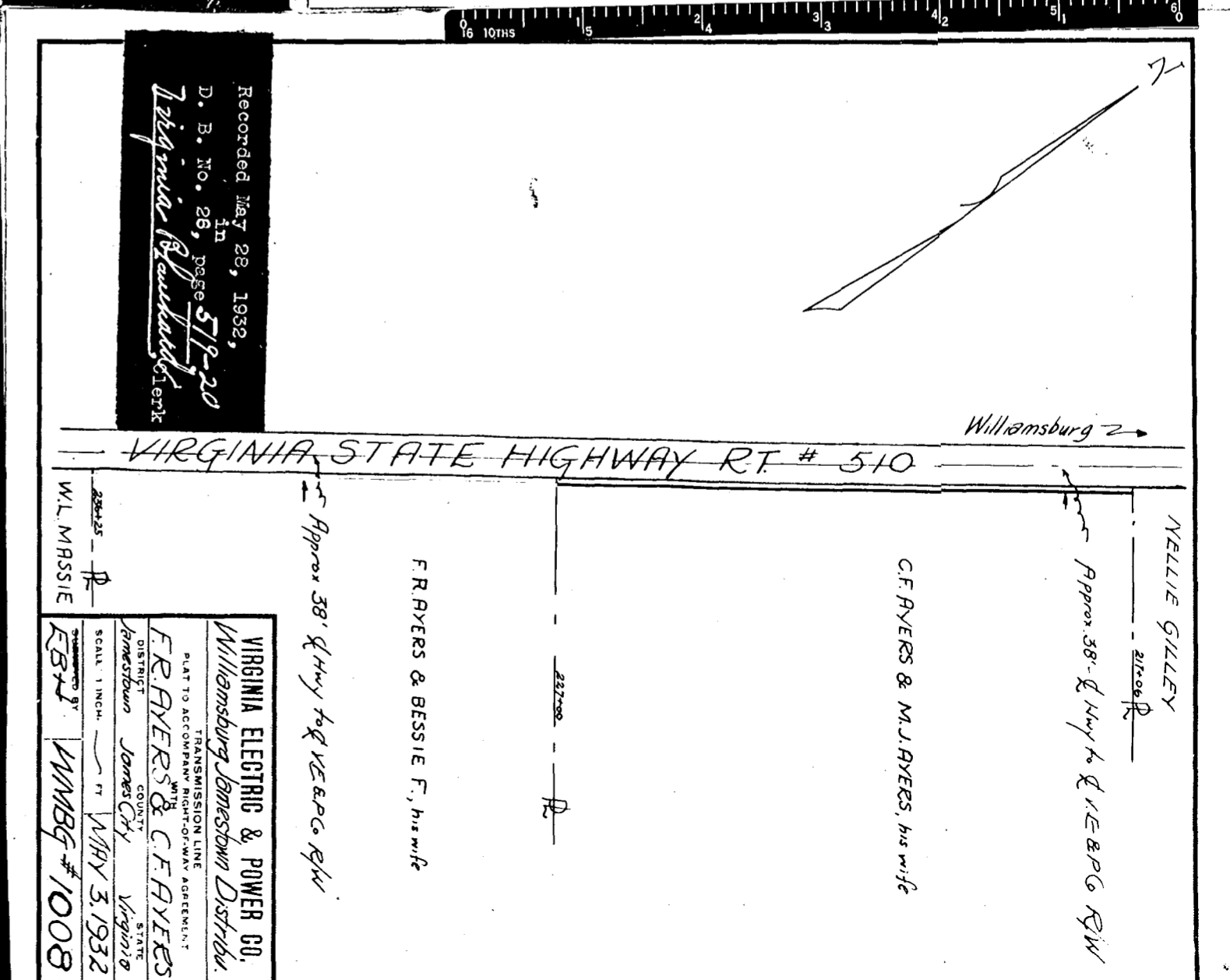

VIRGINIA ELECTRIC & POWER CO.
 Williamsburg Jamesstown Distribu.
 TRANSMISSION LINE
 PLAT TO ACCOMPANY RIGHT-OF-WAY AGREEMENT
 WITH
F. RAYERS & C. FAYERS
 DISTRICT COUNTY STATE
 Jamesstown James City Virginia
 SCALE: 1 INCH = 100 FT. MAY 3, 1932
 SURVEYED BY
E.B.H. WMBG #1008

Recorded May 28, 1932,
 in
 D. B. No. 26, page 519-20
Virginia Blanchard, Clerk