

Recorded Feby. 4, 1932
 in
 D. B. #26, page 370-71-2
Virginia Baukhart, Clerk

MAP OF PARTIAL SUBDIVISION OF PROPERTY
 OF L. T. HANKINS LOCATED IN POWHATAN DIST.,
 JAMES CITY COUNTY, VIRGINIA
 DEC. 20, 1931

V. D. McManus
 Surveying & Mapping
 Williamsburg, Va.

SCALE 1"=40'

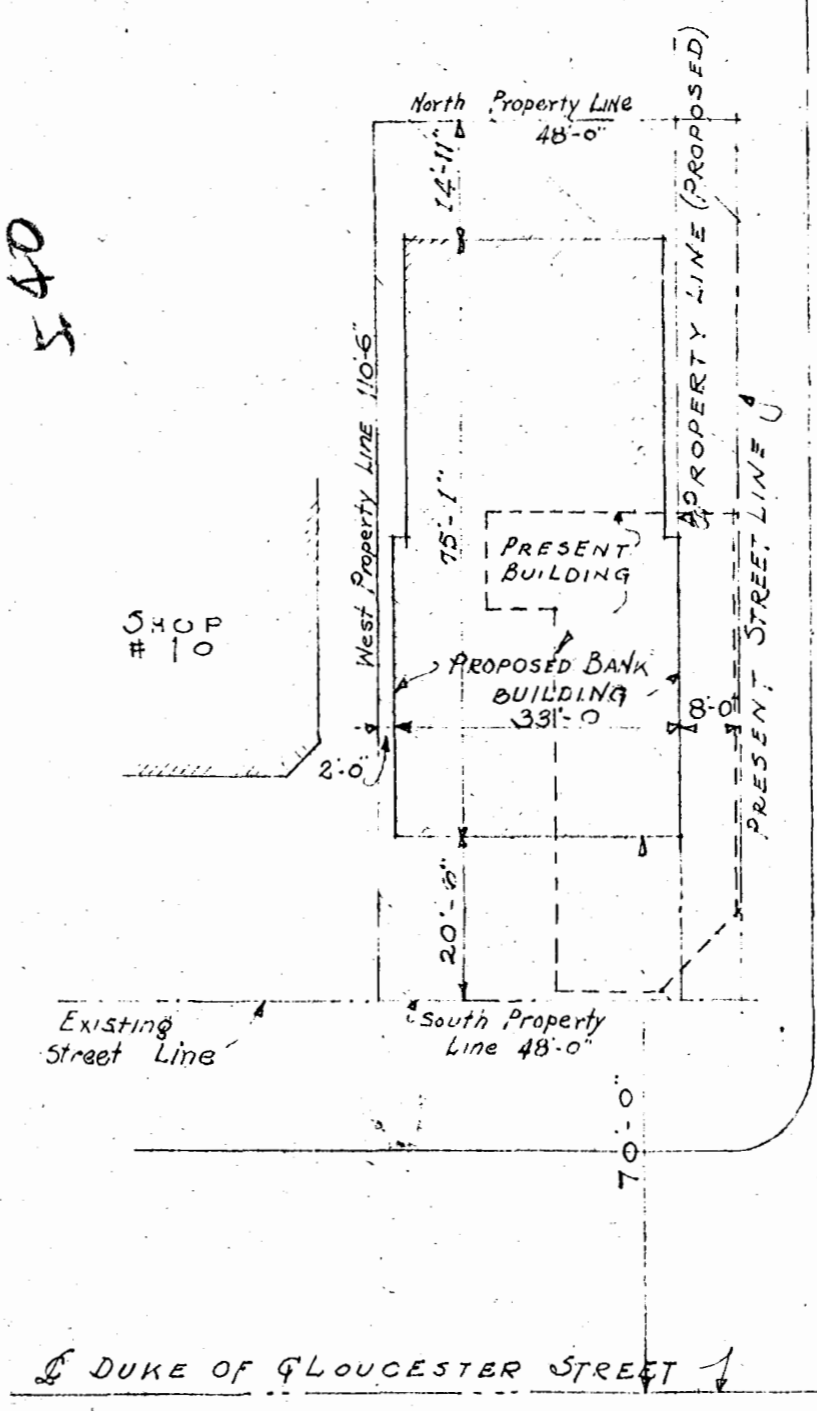

HENRY STREET

Recorded Jan. 26, 1932,
 in
 D. B. No. 15, page 85-
Virginia Baukhart, Clerk

PLOT PLAN OF PENINSULA
 BANK BLOCK 23 BLDG #1A

WILLIAMSBURG RESTORATION FOR THE WILLIAMSBURG HOLDING CO.			
REVISIONS 3-2-31	FERRY, SHAW & HEPBURN, ARCHITECTS 141 MILK ST., EDSTON & WILLIAMSBURG, VA.	BLOCK 23	BLDG. 1A
PENINSULA BANK PLOT PLAN		AUTHOR	NUMBER
SCALE 1"=20'	DATE Nov. 13, 30	MADE BY D.J.H. ADL.M.	Checked by 1A

