

LEGEND

— FULL LINES REPRESENT COURSES PLATTED FROM SURVEY NOTES.

— BROKEN LINES ARE PLATTED FROM DIMENSIONS, INDICATED OR SCALED, TAKEN FROM A PLAT OF LAKESIDE PARK SUBDIVISION, RECORDED IN PLAT BOOK NO. 2 PAGE 36, JAMES CITY COUNTY RECORDS.

THE BEARING OF THE NORTHEAST BOUNDARY OF THE LAKESIDE PARK AREA WAS DETERMINED FROM AN IRON PIPE AND MARKED TREES ON SAID LINE.

PLAT OF
 JAMES CITY COUNTY PROPERTY
 LOCATED IN JAMESTOWN DISTRICT
 JAMES CITY COUNTY, VIRGINIA.

THE LOCATION OF SAID PROPERTY IS ALSO SHOWN IN ITS RELATION TO LAKESIDE PARK SUBDIVISION.
 SCALE 1"=100' Aug. 9, 1930

SURVEY AND PLAT
 BY
 V. D. McMANUS, WILLIAMSBURG, VA.

Recorded Nov. 29, 1930,
 in
 D. B. No. 26, p. 76-7-8-
Virginia Blanchard, Clerk

91-5

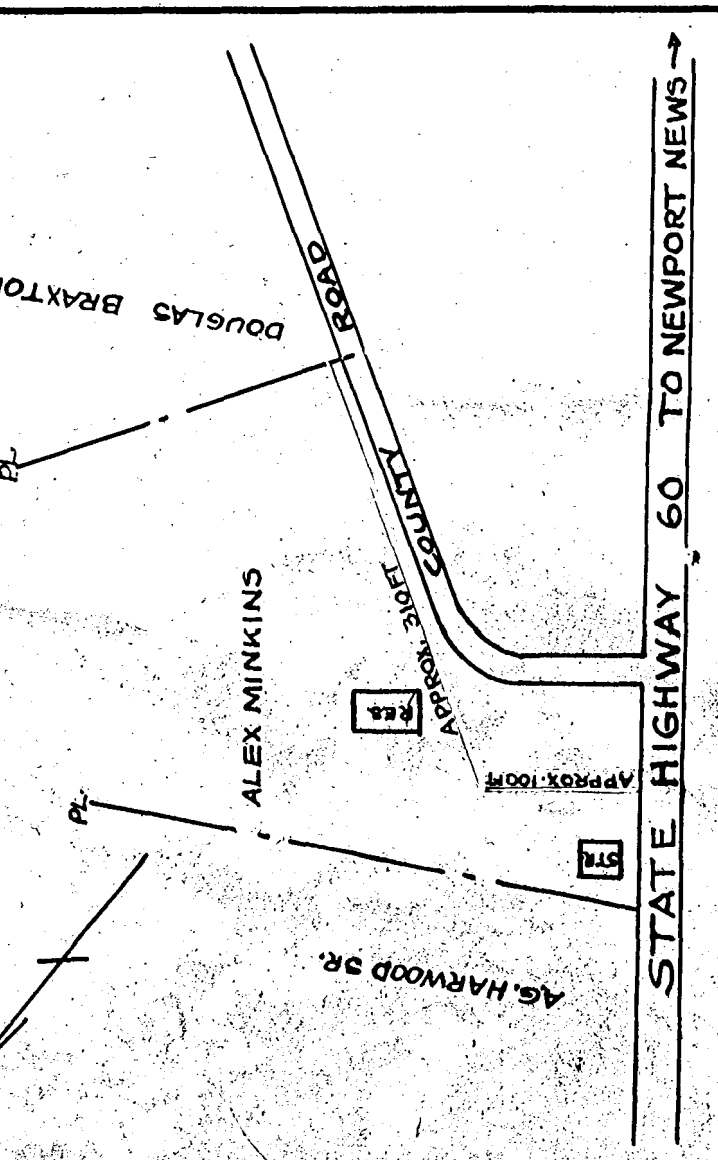

VIRGINIA ELECTRIC & POWER CO.
 PROPOSED LINE
 TRANSMISSION LINE
 PLAT TO ACCOMPANY RIGHT-OF-WAY AGREEMENT
 ALEX MINKINS
 JAMES TOWN, JAMES CITY COUNTY, VA.
 SCALE: 1"=10'-30'-30'
 SURVEYED BY: W.B. WOOD-GROVE NO. 1



Recorded April 16, 1931,
 in
 D. B. No. 26, pp 155-56
Virginia Blanchard, Clerk

Recorded Nov. 29, 1930,
 in
 D. B. No. 26, p. 74-5-
Virginia Blanchard, Clerk

VIRGINIA ELECTRIC & POWER CO.
 Proposed Guy Pole With Anchor
 TRANSMISSION LINE
 PLAT TO ACCOMPANY RIGHT-OF-WAY AGREEMENT
 Vestry of Hickory Neck Church
 DISTRICT COUNTY STATE
 Stonehouse James City VA
 SCALE: 1"=None FT. 11-5-29
 SURVEYED BY: W.B.T.P. No 64 H

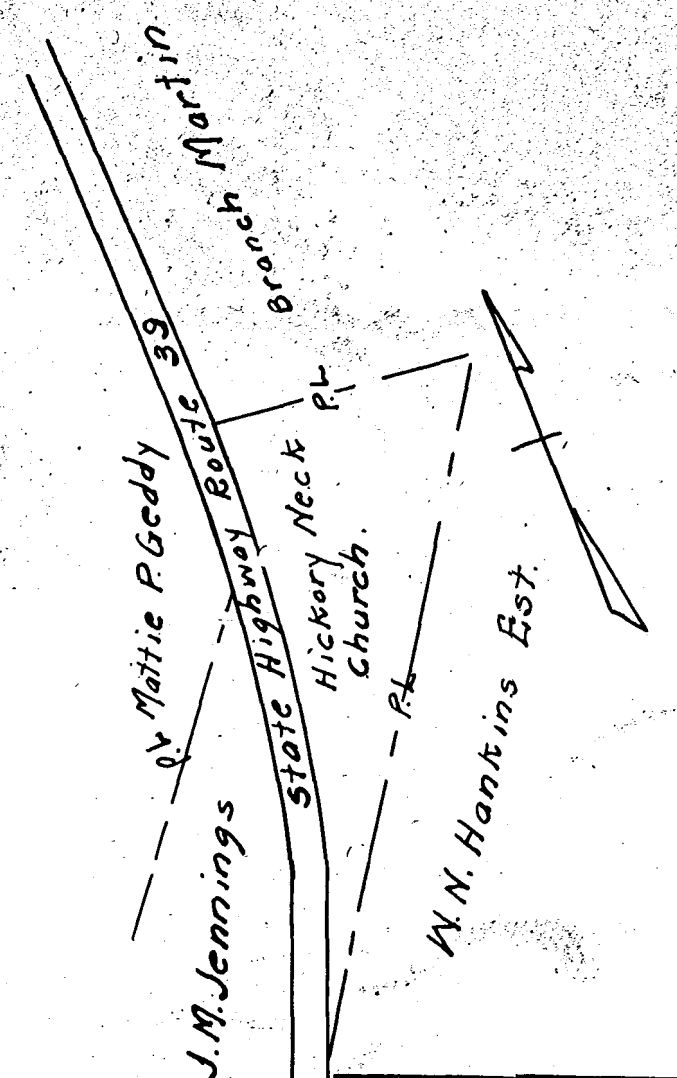

SHEET NO. DRAWER NO.