

Recorded July 21, 1930,  
in  
D. B. #25, page 553  
The Blanchard, Clerk

VIRGINIA ELECTRIC & POWER CO.  
Proposed line

TRANSMISSION LINE  
PLAT TO ACCOMPANY RIGHT-OF-WAY AGREEMENT  
WITH  
Edmund Cowles

DISTRICT COUNTY STATE  
Pamunatan James City Va

SCALE 1 INCH = 6 - 2 - 30 FT

SURVEYED BY Wbg.-Forge No. 15

DRAWER NO SHEET NO

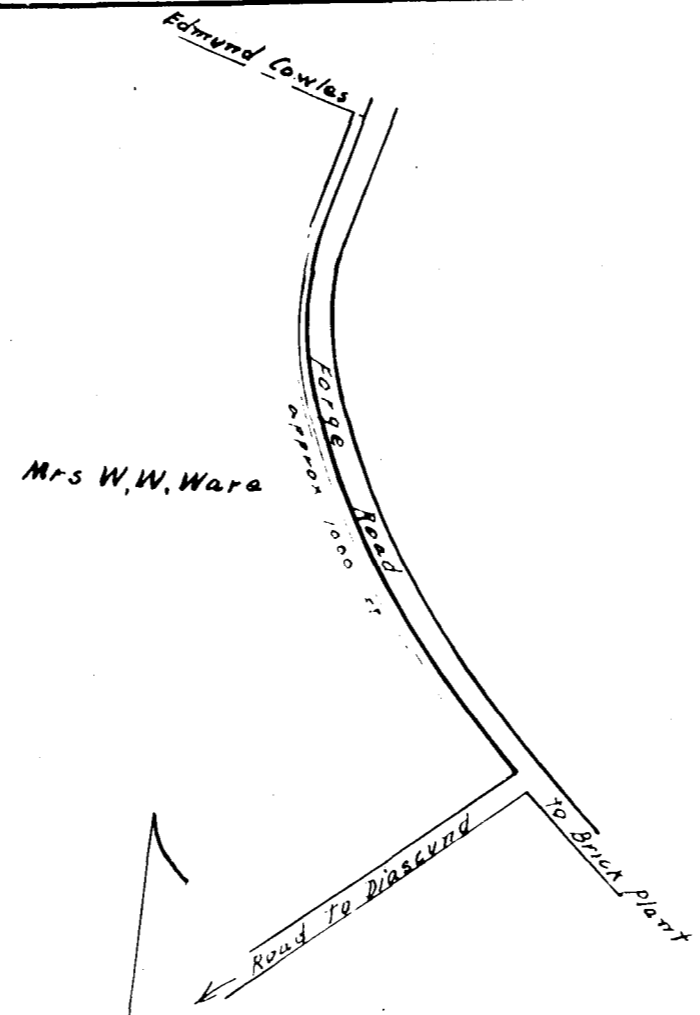

Recorded July 21, 1930,  
in  
D. B. #25, page 554  
The Blanchard, Clerk

VIRGINIA ELECTRIC & POWER CO.  
Proposed line

TRANSMISSION LINE  
PLAT TO ACCOMPANY RIGHT-OF-WAY AGREEMENT  
WITH  
Mrs W.W. Ware

DISTRICT COUNTY STATE  
Pamunatan James City Va

SCALE 1 INCH = 6 - 2 - 30 FT

SURVEYED BY Wbg.-Forge No. 16

DRAWER NO SHEET NO

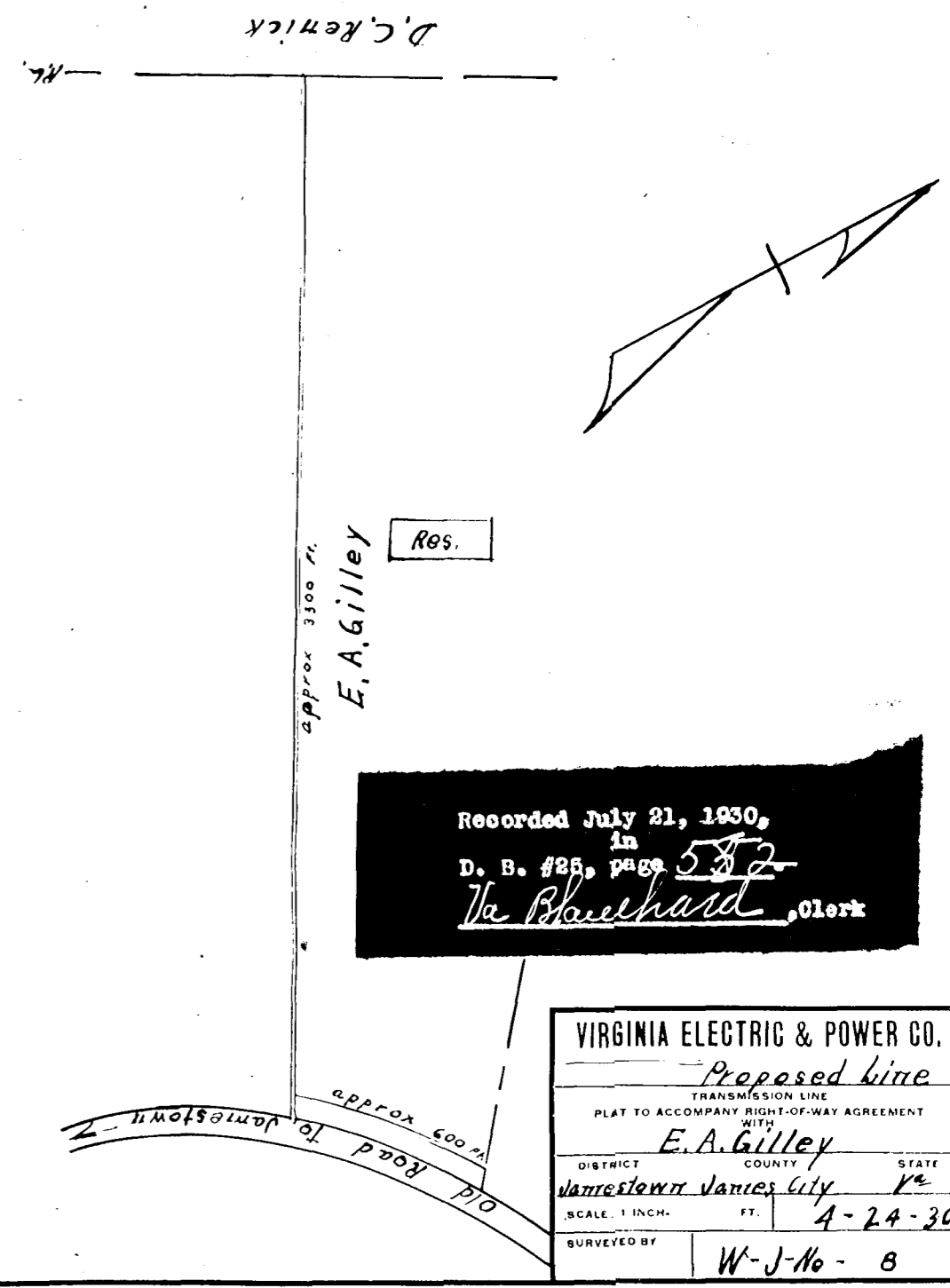

Recorded July 21, 1930,  
in  
D. B. #25, page 552  
The Blanchard, Clerk

VIRGINIA ELECTRIC & POWER CO.  
Proposed line

TRANSMISSION LINE  
PLAT TO ACCOMPANY RIGHT-OF-WAY AGREEMENT  
WITH  
E.A. Gilley

DISTRICT COUNTY STATE  
Jamesstown James City Va

SCALE 1 INCH = 4 - 24 - 30 FT

SURVEYED BY W-J-No - 8

DRAWER NO SHEET NO

Recorded July 21, 1930,  
in  
D. B. #25, page 559  
The Blanchard, Clerk

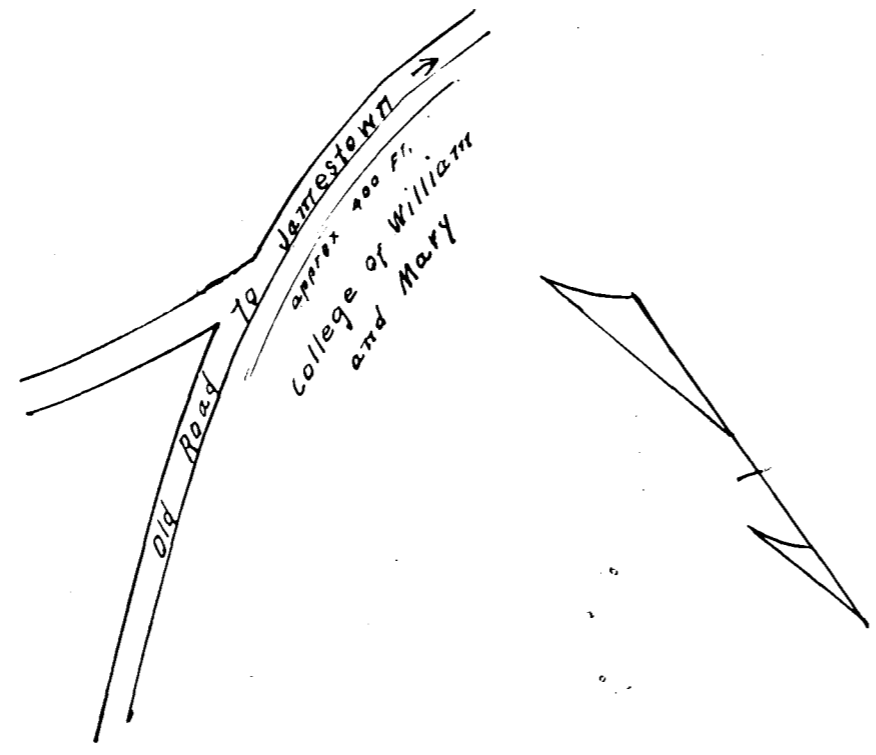

VIRGINIA ELECTRIC & POWER CO.  
Proposed line

TRANSMISSION LINE  
PLAT TO ACCOMPANY RIGHT-OF-WAY AGREEMENT  
WITH  
College of William and Mary

DISTRICT COUNTY STATE  
Jamesstown James City Va

SCALE 1 INCH = 4 - 24 - 30 FT

SURVEYED BY W-J-No. 21

DRAWER NO SHEET NO

Recorded July 21, 1930,  
in  
D. B. #25, page 557  
The Blanchard, Clerk

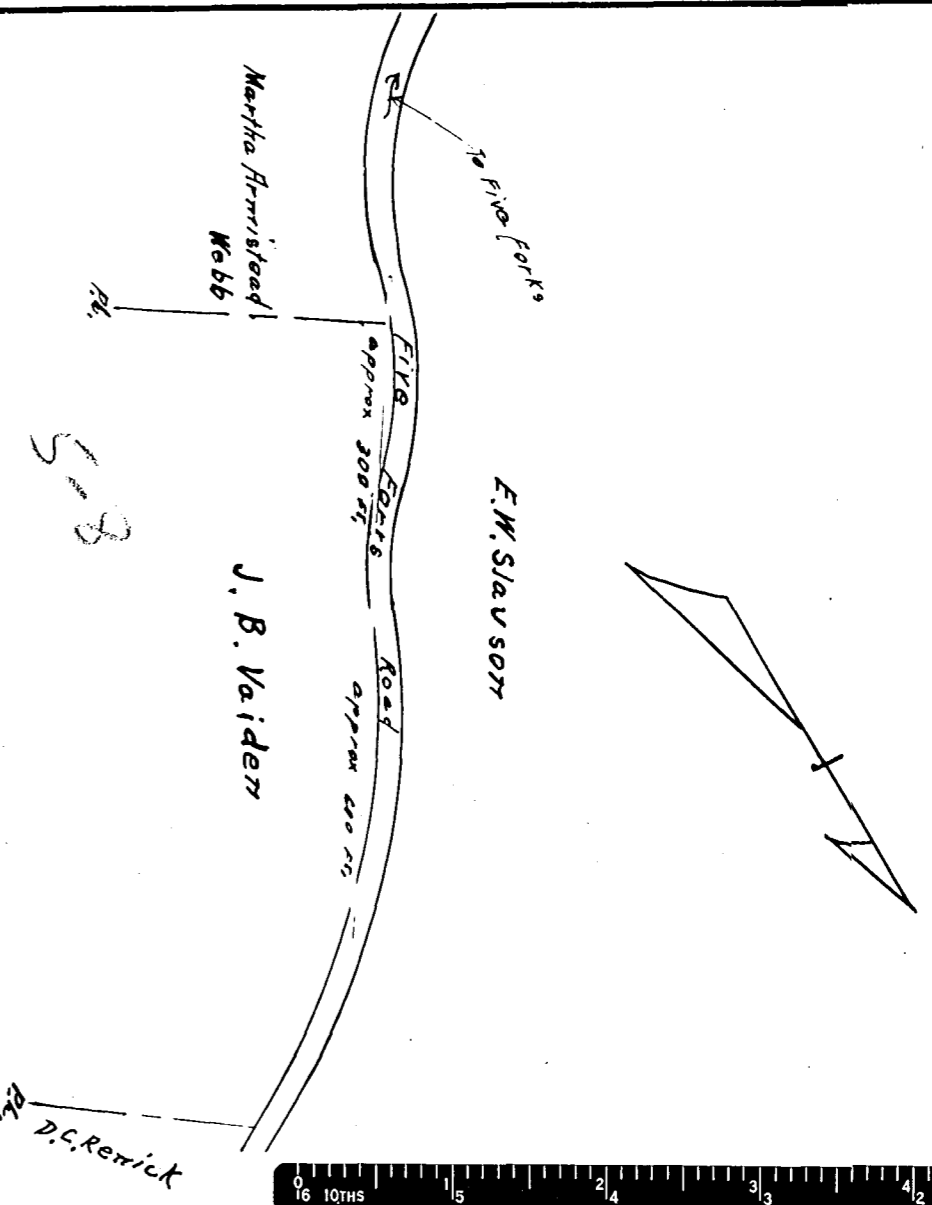

VIRGINIA ELECTRIC & POWER CO.  
Proposed line

TRANSMISSION LINE  
PLAT TO ACCOMPANY RIGHT-OF-WAY AGREEMENT  
WITH  
J.B. Valder

DISTRICT COUNTY STATE  
Jamesstown James City Va

SCALE 1 INCH = 6 - 23 - 30 FT

SURVEYED BY W-J-No. 22

DRAWER NO SHEET NO

