

Recorded July 21, 1930,
in
D. B. #25, page 521.
Virginia Blanchard, Clerk

VIRGINIA ELECTRIC & POWER CO.
Proposed Line
PLAT TO ACCOMPANY RIGHT-OF-WAY AGREEMENT
WITH
C. H. Slater
DISTRICT JAMES CITY COUNTY STATE VA
SCALE 1 INCH = 60 FT
SURVEYED BY Wbg-Forge No. 4

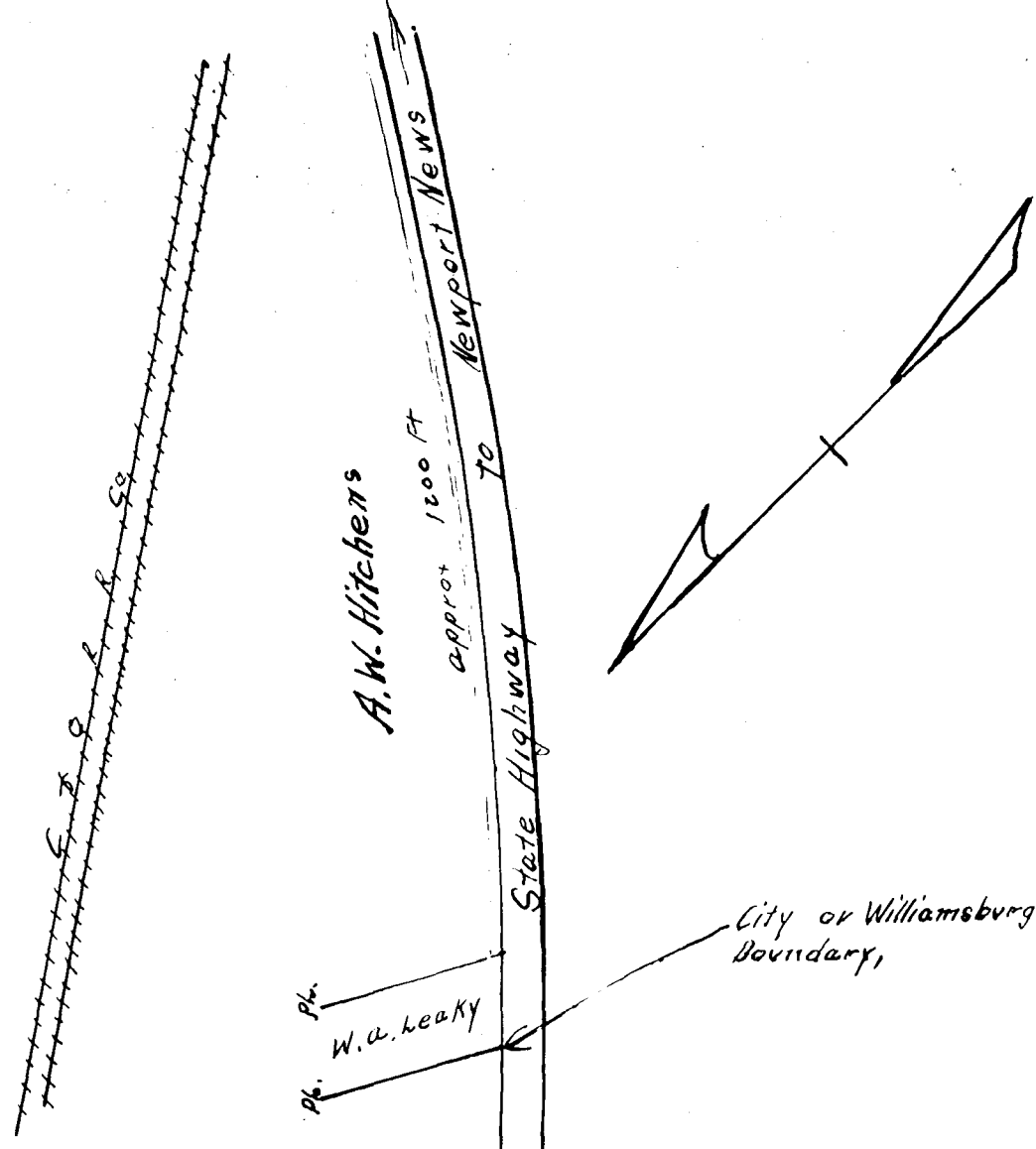

Recorded July 21, 1930,
in
D. B. #25, p. 537
Virginia Blanchard, Clerk

VIRGINIA ELECTRIC & POWER CO.
Proposed Line
TRANSMISSION LINE
PLAT TO ACCOMPANY RIGHT-OF-WAY AGREEMENT
WITH
A. W. Hitchens
DISTRICT JAMES CITY COUNTY STATE VA
SCALE 1 INCH = 50 FT
SURVEYED BY Wbg - 7-1930

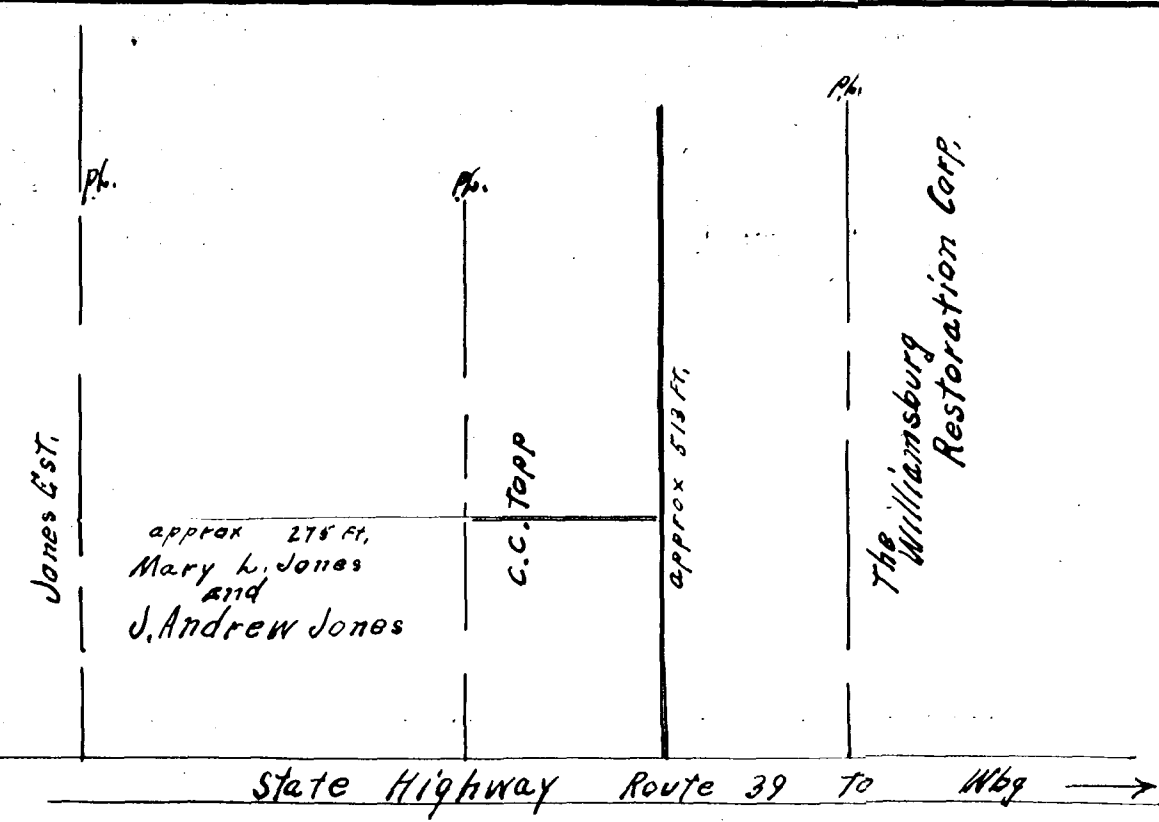

Recorded July 21, 1930,
in
D. B. #25, page 3306
Virginia Blanchard, Clerk

VIRGINIA ELECTRIC & POWER CO.
Proposed Line
TRANSMISSION LINE
PLAT TO ACCOMPANY RIGHT-OF-WAY AGREEMENT
WITH
Mary L. Jones and J. Andrew Jones
DISTRICT JAMES CITY COUNTY STATE VA
SCALE 1 INCH = 100 FT
SURVEYED BY Wbg - 1-1930

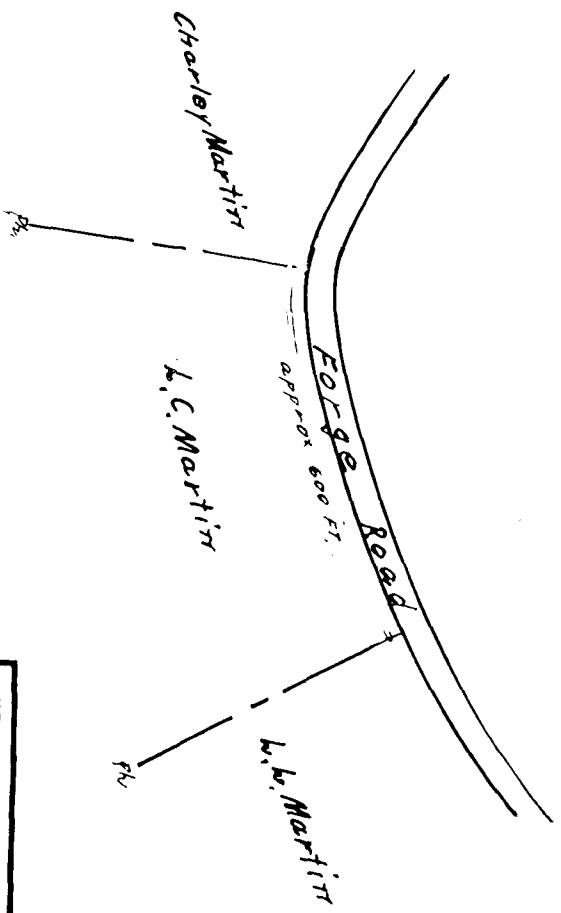

Recorded July 21, 1930,
in
D. B. #25, p. 5715
Virginia Blanchard, Clerk

VIRGINIA ELECTRIC & POWER CO.
Proposed Line
PLAT TO ACCOMPANY RIGHT-OF-WAY AGREEMENT
WITH
L. C. Martin
DISTRICT JAMES CITY COUNTY STATE VA
SCALE 1 INCH = 60 FT
SURVEYED BY Wbg-Forge No. 7

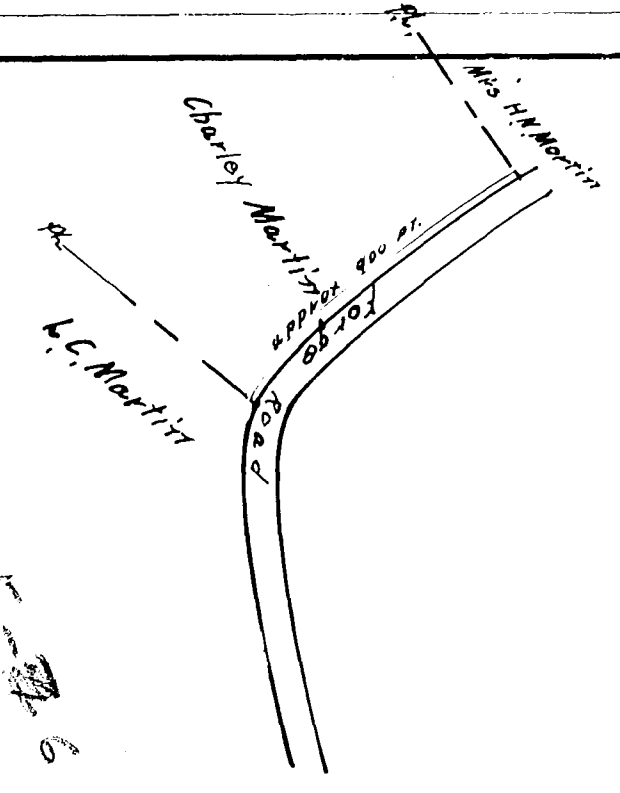

Recorded July 21, 1930,
in
D. B. #25, page 343
Virginia Blanchard, Clerk

VIRGINIA ELECTRIC & POWER CO.
Proposed Line
TRANSMISSION LINE
PLAT TO ACCOMPANY RIGHT-OF-WAY AGREEMENT
WITH
Charley Martin
DISTRICT JAMES CITY COUNTY STATE VA
SCALE 1 INCH = 60 FT
SURVEYED BY Wbg-Forge No. 6

