

4-24

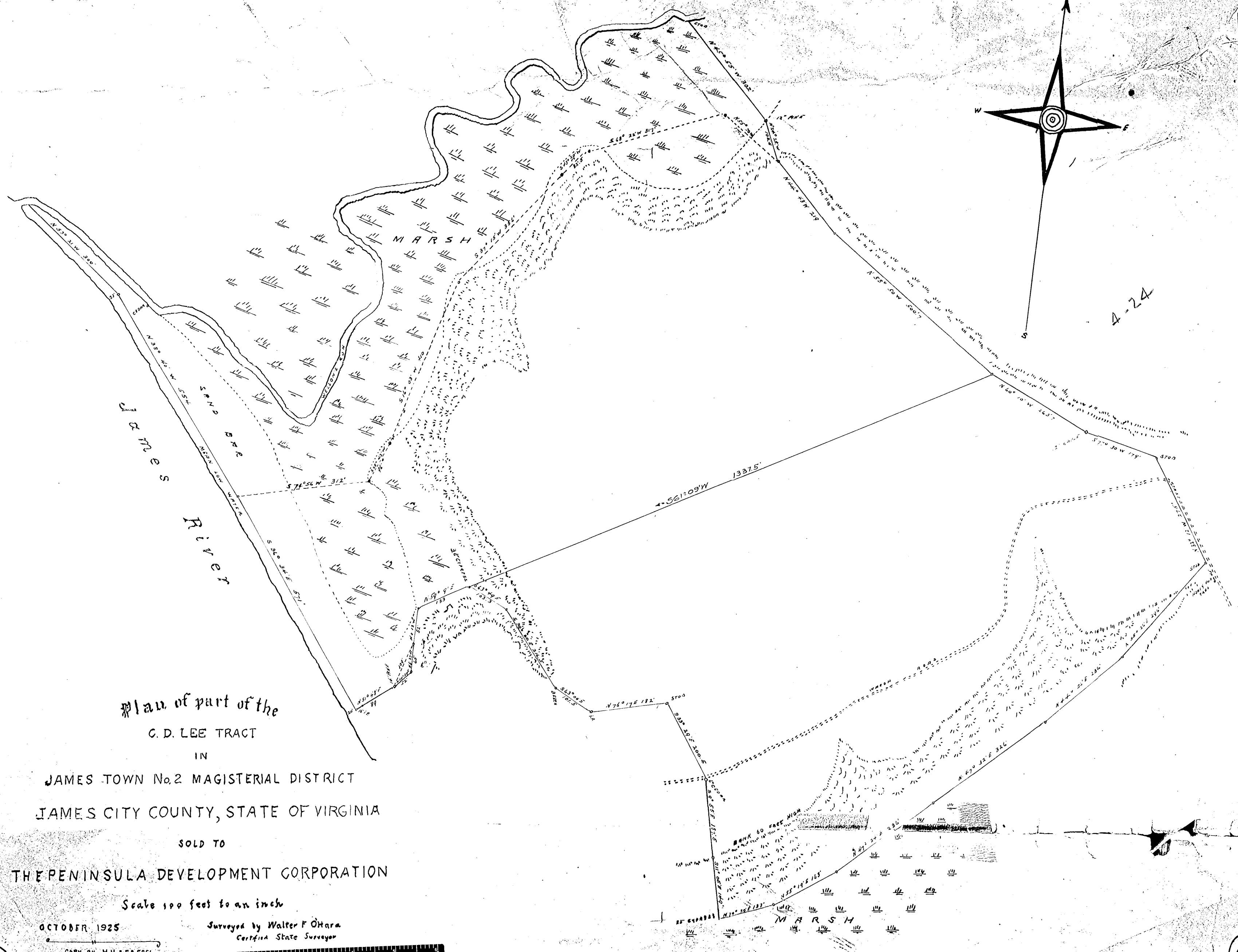

Plan of part of the

C. D. LEE TRACT

IN

JAMES TOWN No. 2 MAGISTERIAL DISTRICT

JAMES CITY COUNTY, STATE OF VIRGINIA

SOLD TO

THE PENINSULA DEVELOPMENT CORPORATION

Scale 100 feet to an inch

OCTOBER 1925

Surveyed by Walter F. O'Hara
Certified State Surveyor

