

Recorded July 2nd 1904.
 With Deed
 See Deed Book No. 9 p. 361.
 Just J. H. Gaddy, Clerk

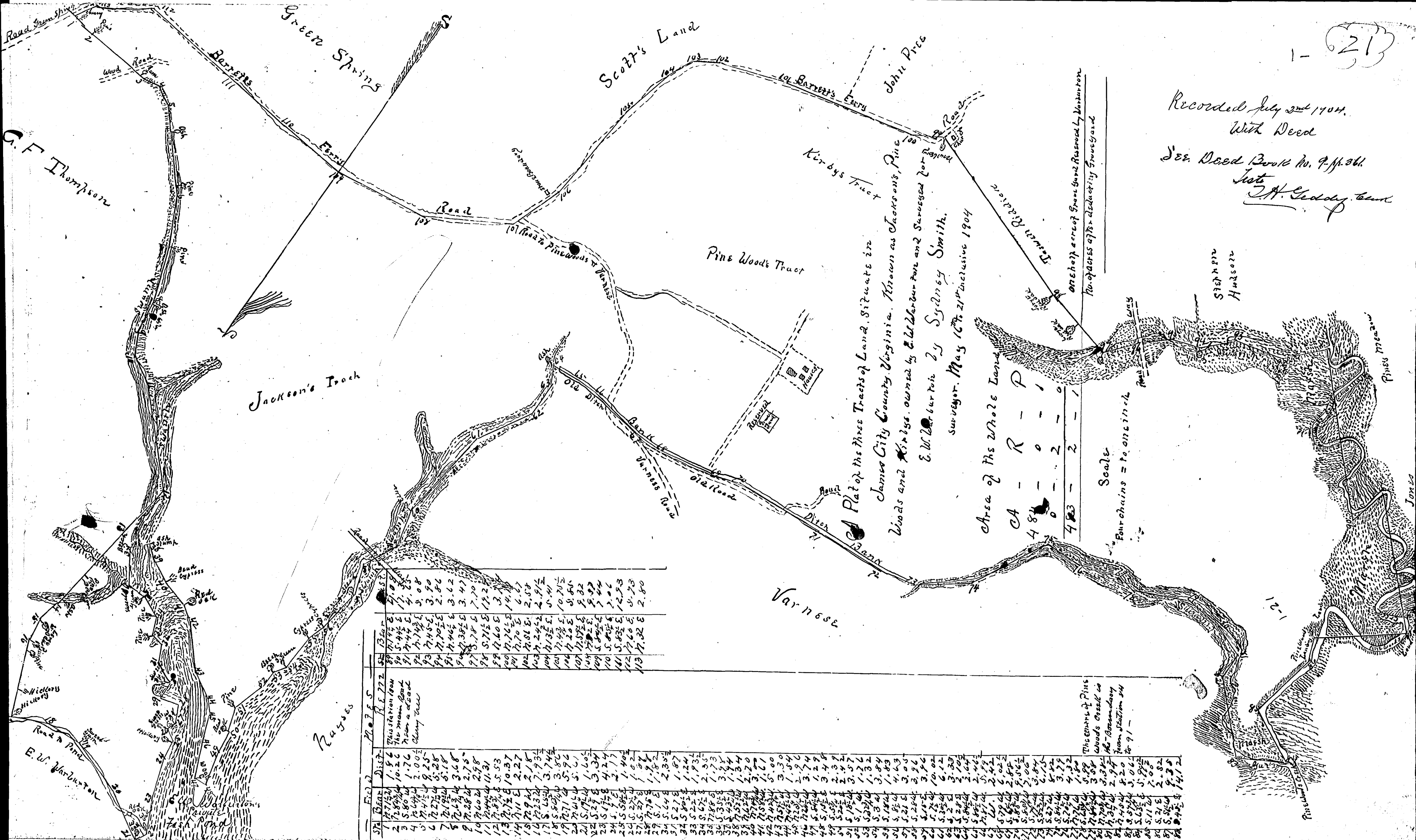

Plat of the Three Tracts of Land, Situate in
 James City County, Virginia. Known as Jackson's, Pine
 Woods and Kirby's, owned by E. W. Warburton and Surveyed for
 him by Sydney Smith,
 Surveyor, May 16th 21st inclusive 1904

Area of the Whole Land

CA	R	P
48	0	0
0	2	0
483	2	1

Scale
 Four chains = 100 links

Sta	Bearing	Dist	Notes
1	N 77° 22' E	13.47	13.47
2	S 71° 45' E	5.44	5.44
3	S 71° 45' E	5.44	5.44
4	N 77° 22' E	13.47	13.47
5	N 77° 22' E	13.47	13.47
6	S 71° 45' E	5.44	5.44
7	S 71° 45' E	5.44	5.44
8	N 77° 22' E	13.47	13.47
9	N 77° 22' E	13.47	13.47
10	S 71° 45' E	5.44	5.44
11	S 71° 45' E	5.44	5.44
12	N 77° 22' E	13.47	13.47
13	N 77° 22' E	13.47	13.47
14	S 71° 45' E	5.44	5.44
15	S 71° 45' E	5.44	5.44
16	N 77° 22' E	13.47	13.47
17	N 77° 22' E	13.47	13.47
18	S 71° 45' E	5.44	5.44
19	S 71° 45' E	5.44	5.44
20	N 77° 22' E	13.47	13.47
21	N 77° 22' E	13.47	13.47
22	S 71° 45' E	5.44	5.44
23	S 71° 45' E	5.44	5.44
24	N 77° 22' E	13.47	13.47
25	N 77° 22' E	13.47	13.47
26	S 71° 45' E	5.44	5.44
27	S 71° 45' E	5.44	5.44
28	N 77° 22' E	13.47	13.47
29	N 77° 22' E	13.47	13.47
30	S 71° 45' E	5.44	5.44
31	S 71° 45' E	5.44	5.44
32	N 77° 22' E	13.47	13.47
33	N 77° 22' E	13.47	13.47
34	S 71° 45' E	5.44	5.44
35	S 71° 45' E	5.44	5.44
36	N 77° 22' E	13.47	13.47
37	N 77° 22' E	13.47	13.47
38	S 71° 45' E	5.44	5.44
39	S 71° 45' E	5.44	5.44
40	N 77° 22' E	13.47	13.47
41	N 77° 22' E	13.47	13.47
42	S 71° 45' E	5.44	5.44
43	S 71° 45' E	5.44	5.44
44	N 77° 22' E	13.47	13.47
45	N 77° 22' E	13.47	13.47
46	S 71° 45' E	5.44	5.44
47	S 71° 45' E	5.44	5.44
48	N 77° 22' E	13.47	13.47
49	N 77° 22' E	13.47	13.47
50	S 71° 45' E	5.44	5.44
51	S 71° 45' E	5.44	5.44
52	N 77° 22' E	13.47	13.47
53	N 77° 22' E	13.47	13.47
54	S 71° 45' E	5.44	5.44
55	S 71° 45' E	5.44	5.44
56	N 77° 22' E	13.47	13.47
57	N 77° 22' E	13.47	13.47
58	S 71° 45' E	5.44	5.44
59	S 71° 45' E	5.44	5.44
60	N 77° 22' E	13.47	13.47
61	N 77° 22' E	13.47	13.47
62	S 71° 45' E	5.44	5.44
63	S 71° 45' E	5.44	5.44
64	N 77° 22' E	13.47	13.47
65	N 77° 22' E	13.47	13.47
66	S 71° 45' E	5.44	5.44
67	S 71° 45' E	5.44	5.44
68	N 77° 22' E	13.47	13.47
69	N 77° 22' E	13.47	13.47
70	S 71° 45' E	5.44	5.44
71	S 71° 45' E	5.44	5.44
72	N 77° 22' E	13.47	13.47
73	N 77° 22' E	13.47	13.47
74	S 71° 45' E	5.44	5.44
75	S 71° 45' E	5.44	5.44
76	N 77° 22' E	13.47	13.47
77	N 77° 22' E	13.47	13.47
78	S 71° 45' E	5.44	5.44
79	S 71° 45' E	5.44	5.44
80	N 77° 22' E	13.47	13.47
81	N 77° 22' E	13.47	13.47
82	S 71° 45' E	5.44	5.44
83	S 71° 45' E	5.44	5.44
84	N 77° 22' E	13.47	13.47
85	N 77° 22' E	13.47	13.47
86	S 71° 45' E	5.44	5.44
87	S 71° 45' E	5.44	5.44
88	N 77° 22' E	13.47	13.47
89	N 77° 22' E	13.47	13.47
90	S 71° 45' E	5.44	5.44
91	S 71° 45' E	5.44	5.44
92	N 77° 22' E	13.47	13.47
93	N 77° 22' E	13.47	13.47
94	S 71° 45' E	5.44	5.44
95	S 71° 45' E	5.44	5.44
96	N 77° 22' E	13.47	13.47
97	N 77° 22' E	13.47	13.47
98	S 71° 45' E	5.44	5.44
99	S 71° 45' E	5.44	5.44
100	N 77° 22' E	13.47	13.47

The course of Pine
 Woods Creek is
 the boundary
 from Station 54
 to 91 -