

PG This Plot including  
the Marsh contains four  
hundred & seven acres &  
a half being the half of  
Boush neck tract purchased  
by Warburton & Meier and  
said plot is for the benefit  
of John Meier

Wm Boush Seery  
May 1831

Water Course Commence  
at No 2 and continues  
to No 25 inclusively  
from No 25 to No 1  
straight line in the  
ditch line from No. 25  
Warburton tract

by agreement  
of W & M except  
what front does  
appear to be  
patch track

Area 507 3/4

John H. Seery  
Apr - 1903

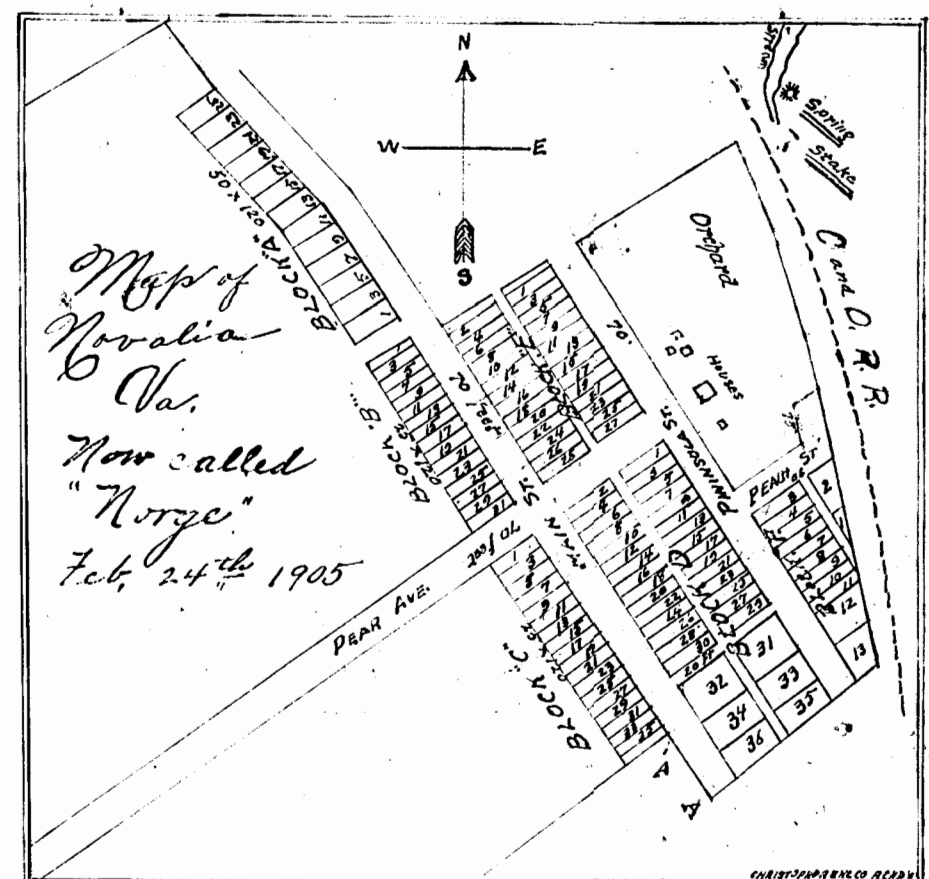

On the main stage road between  
Tanno and Lightfoot Va. and  
being a part of the Foster and  
Tammville tracts of Land James City  
County Virginia. Recorded June 1903.

