

This figure represent a tract of land lying in James City County about four miles from Towns Station and on the old stage road and is a part of S. P. Richardson's Est. which I surveyed by request of Richardson and Wright and found to contain a small fraction over 5 1/2 acres, bounded as follows. Beginning at A a station near a Hickory tree near the road from Barboursville to Towns and running S 87 1/2 W 12.22 Chains to a large Oak tree. Thence S 76 1/2 W 5.22 Chains to a Walnut tree. Thence S 77 1/2 W 2.72 Chains to an old ground near newly marked Oak. Thence S 55 1/2 W 4.74 Chains to a P. O. Oak. Thence S 55 1/2 W 4.20 Chains to a Hickory. Thence S 55 1/2 W 1.80 Chains to a Hickory. Thence S 54 1/2 W 5.43 Chains to a Oak. Thence S 47 1/2 W 3.12 Chains to a H. Oak. Thence S 30 1/2 W 2.22 to a Pine. Thence S 35 1/2 W 5.57 Chains to a Laurel. Thence S 40 1/2 W 2.00 Chains. Thence S 40 1/2 W 8.88 Chains. Thence S 40 1/2 W 2.72 Chains to a Pine. Thence S 40 1/2 W 4.22 Chains to a Pine. Thence S 49 1/2 W 5.22 Chains to an oak. Thence S 57 1/2 W 1.60 Chains to a Pine. Thence S 49 1/2 W 4.47 Chains to an oak. Thence S 40 1/2 W 3.22 Chains to an oak. Thence along the slope of a hill N 16 W 450 Chains and locating several marked trees. Thence N 15 1/2 W 152 Chains. Thence N 1/2 W 5.57 Chains to a stump. Thence N 1/2 W 280 Chains to a Pine and crossing stream. Thence N 61 1/2 W 1.80 Chains to a Pine. Thence N 59 W 4.57 Chains to a Gum. Thence N 59 W 1.20 Chains to a Gum. Thence N 38 W 3.16 Chains to a Pine. Thence N 15 1/2 W 4.47 Chains along stream. Thence leaving stream N 71 E 1.22 Chains to an Ash. Thence N 41 W 1.60 Chains to a Holly. Thence N 12 1/2 W 2.82 Chains to an oak. Thence N 17 1/2 W 4.76 Chains. Thence N 10 1/2 W 9.57 Chains to a Hickory. Thence N 8 W 2.18 Chains to an oak. Thence N 1/2 W 2.18 Chains. Thence N 1/2 W 3.22 Chains. Thence N 31 1/2 W 3.22 Chains to middle of road to Decatur station. From there along said road to its intersection in a Northwesterly course 63.88 Chains to a Walnut near forks of road (Public) Thence along an old ditch N 77 1/2 E 2.18 Chains. Thence N 65 1/2 E 1.22 Chains. Thence N 67 1/2 E 1.58 Chains. Thence N 67 1/2 E 1.62 Chains. Thence N 66 1/2 E 1.62 Chains. Thence N 65 1/2 E 1.22 Chains. Thence N 67 E 1.47 Chains to a stake at head of ditch among. Thence S 17 1/2 E 1.47 Chains to a large Oak. Thence S 77 E 2.56 Chains. Thence S 77 1/2 E 2.52 Chains. Thence S 70 E 11.64 Chains to swamp. Thence along said swamp as it meanders in an Easterly course 42.94 Chains to a large Pine on side of swamp and across on the Bleeders tract south swamp a branch of the big swamp which it empties into. Thence along said big swamp as it meanders in a Southwesterly course 48 Chains to head of said swamp and near a spring and valley. Thence along valley on N side S 62 W 12.5 Chains. Thence S 48 1/2 W 1.28 Chains. Thence S 62 W 3 Chains. Thence S 61 W 1.18 Chains. Thence S 65 1/2 W 1.24 Chains. Thence S 67 W 1.24 Chains. Thence S 67 W to middle of road and near a large (wood) leading from Barboursville to Towns. Thence along said road in a Southwesterly course 54.32 Chains to large Hickory. Thence began at.

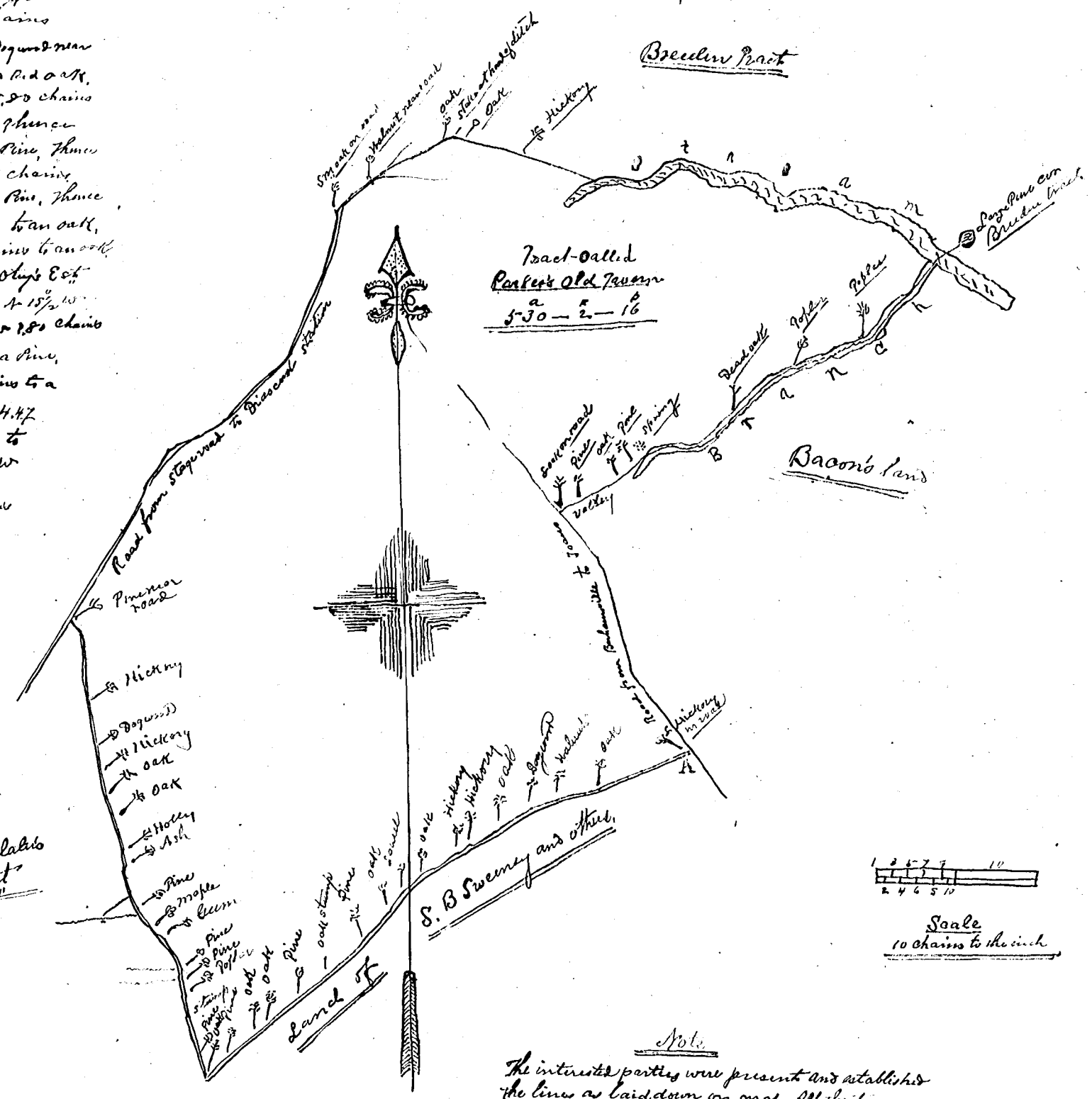

May 12 1800
 JOS. A. CHRISTIAN,
 County Surveyor for
 Charles City and New Kent,
 BINNS' HALL, VA.

JOS. A. CHRISTIAN,
 County Surveyor for
 Charles City and New Kent,
 BINNS' HALL, VA.

This figure represents a tract of land lying in James City County about 4 miles from Towns Station and on the old stage road and is a part of S. P. Richardson's Est. which I surveyed by request of Richardson and Wright and found to contain within a small fraction of 16 1/4 acres, bounded as follows. Beginning at station A a small Walnut tree on the stage road and running along an old ditch N 77 1/2 E 2.12 Chains. Thence N 67 1/2 E 1.22 Chains. Thence N 67 1/2 E 1.62 Chains. Thence N 67 1/2 E 1.47 Chains to a stake at head of ditch marked. Thence S 77 1/2 E 11.64 Chains to a large oak tree. Thence S 77 E 2.52 Chains. Thence S 77 E 2.52 Chains. Thence S 70 E 11.64 Chains to a stream. Thence along said stream as it meanders N 42 1/2 W 42.94 Chains to a large Pine near a branch. Thence along said branch as it meanders S 17 1/2 E 1.47 Chains to the mouth of a valley. Thence along said valley N 49 W 12.5 Chains. Thence N 37 W 88 Chains. Thence N 67 W 1.22 Chains to a Pine near a road (large Pine). Thence S 84 1/2 W 17.14 Chains to a tall oak standing near stage road. Thence crossing said road and running along an old fence marked S 2 1/2 E 1.70 Chains to a Pine near road. Thence S 15 1/2 E 2.18 Chains to a Pine. Thence S 19 E 1.32 Chains to a Pine. Thence S 20 1/2 E 1.82 Chains. Thence S 14 E 1.78 Chains. Thence S 29 E 1.94 Chains. Thence S 36 1/2 E 2.42 Chains. Thence S 40 E 3.02 Chains to a large Pine. Thence S 48 E 2.28 Chains to an oak. Thence N 67 E 1.62 Chains to a large Pine. Thence began at.

May 15 1800

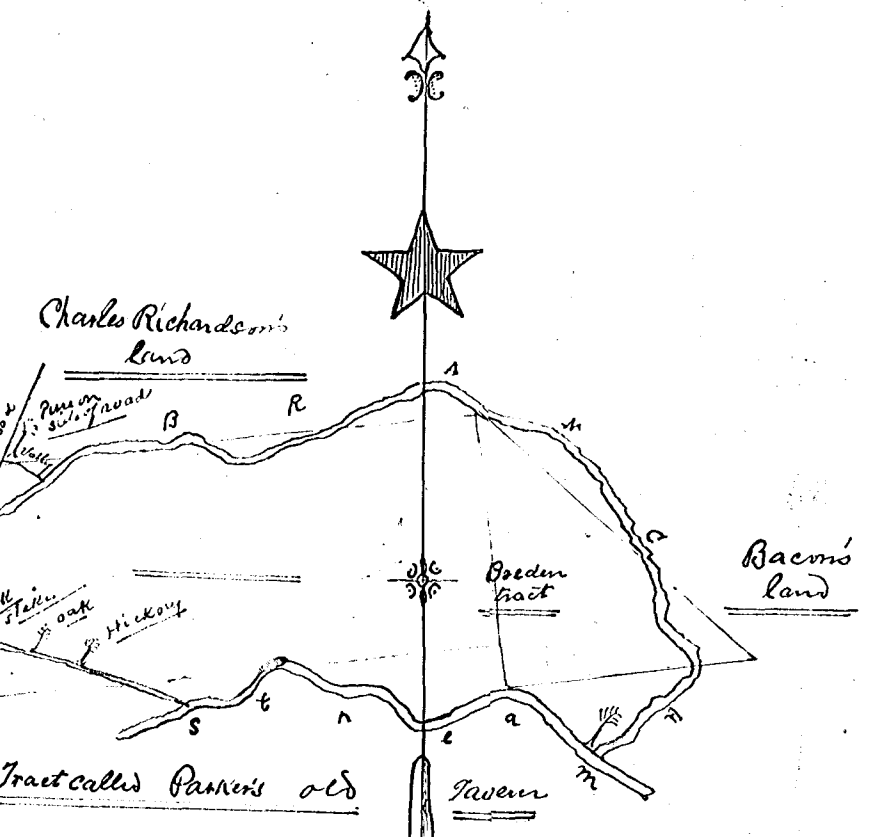

JOS. A. CHRISTIAN,
 County Surveyor for
 Charles City and New Kent,
 BINNS' HALL, VA.

Deed Recorded Deed Book No 7.
 page 377 James City County Va Oct
 29 1800

J. A. Suddley, C. W.