

REVISED	STATE	ROUTE	STATE	PROJECT	SHEET NO.
04/02/21					
08/27/21					
10/06/21	VA.	607		0607-047-630 R201, C501	3
11/09/21					

DESIGN FEATURES RELATING TO CONSTRUCTION OR TO REGULATION AND CONTROL OF TRAFFIC MAY BE SUBJECT TO CHANGE AS DEEMED NECESSARY BY THE DEPARTMENT

NOTE: See Sheet IE(3) For Utility Owners Information

BEGIN PROJECT 0607-047-630, PLOT C501
 CROAKER ROAD SB @ STA. 300+48.50
 BEGIN PROJECT 0607-047-630, R201
 CROAKER ROAD SB @ STA. 300+58.84

001

JANE B. SPEEGLE, A ONE-HALF UNDIVIDED INTEREST AND JOHN H. SPEEGLE, A ONE-HALF UNDIVIDED INTEREST
 Inst. #18001183
 PDB 365 PG 260
 7.859 AC.
 Tax# 2320100001

PROPOSED VARIABLE WIDTH STANDARD PERMANENT UTILITY EASEMENT REQUIRED FOR DOMINION ENERGY AND VDOT UTILITY EASEMENT

- (A) Route 607 SB
 Curve SBC1
 PI = 303+66.04
 DELTA = 27° 40' 13.69" (RT)
 D = 2' 59' 48"
 T = 365.95'
 L = 723.16'
 R = 1912.00'
 PC = 300+00.09
 PT = 307+23.25
 e = 3.30%
 V = 50 MPH
 Lr = 119
 U = 72
- (B) Route 607 NB
 Curve NBC1
 PI = 203+62.22
 DELTA = 27° 40' 13.75" (RT)
 D = 3' 01' 42"
 T = 362.12'
 L = 715.59'
 R = 1892.00'
 PC = 200+00.09
 PT = 207+15.69
 e = Match Existing
 V = 45 MPH ULS (Existing)
 Lr = Match Existing
 U = Match Existing
- (I) Bank Driveway
 Curve BLBANK_3
 PI = 700+96.51
 DELTA = 28° 04' 41.75" (RT)
 D = 76' 23' 40"
 T = 18.75'
 L = 36.75'
 R = 75.00'
 PC = 700+77.76
 PT = 701+4.51
 e = Match Existing
 Lr = N/A
 U = N/A
- (J) Curve 3047900LT_3
 PI = 106.42
 DELTA = 101° 22' 30.05" (RT)
 D = 286' 28' 44"
 T = 24.42'
 L = 35.39'
 R = 20.00'
 PC = 0+82.00
 PT = 1+7.39

Johnson, Mirmiran & Thompson
 Richmond, Virginia
 HYDRAULIC ENGINEER

Johnson, Mirmiran & Thompson
 Richmond, Virginia
 ROADWAY ENGINEER

- Legend**
- Perm Denotes Permanent Easement
 - Temp Denotes Temporary Easement
 - C Denotes Construction Limits In Cuts
 - F Denotes Construction Limits In Fills
 - Denotes mill and overlay
 - Denotes demolition of pavement
 - Denotes proposed hydraulic cement sidewalk
 - Denotes asphalt shared use path
 - Denotes area of proposed pavement

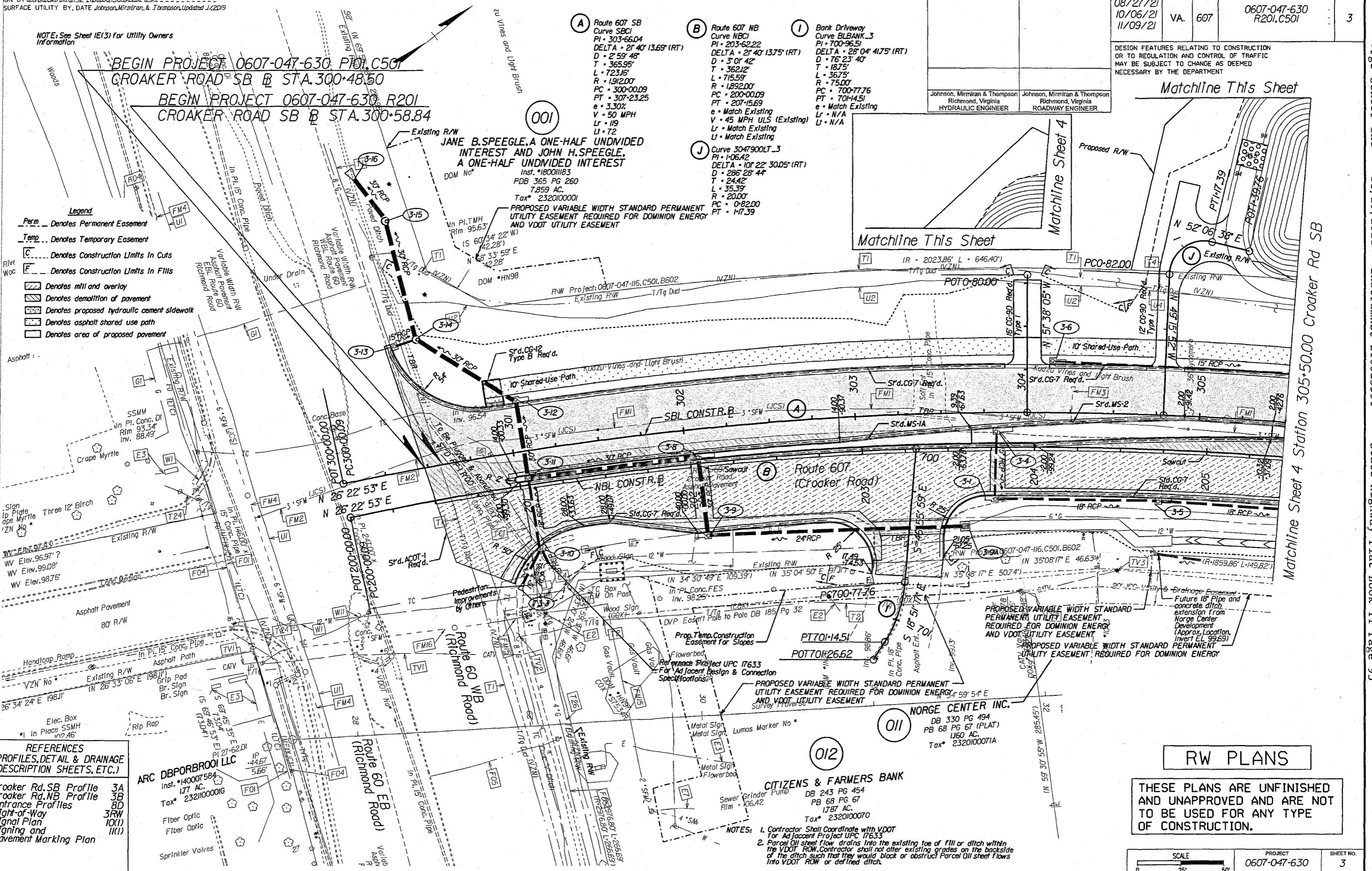

- REFERENCES**
 PROFILES, DETAIL & DRAINAGE DESCRIPTION SHEETS, ETC.)
- Croaker Rd. SB Profile 3A
 - Croaker Rd. NB Profile 3B
 - Infrance Profiles 8D
 - Light-of-Way 3RW
 - Signal Plan 10(I)
 - Pavement Marking Plan 11(I)

ARC DBPORBROOK LLC
 Inst. #140007584
 177 AC.
 Tax# 2321100001G

- NOTES:**
1. Contractor Shall Coordinate with VDOT For Adjacent Project UPC 17633
 2. Parcel Oil sheet flow drains into the existing toe of fill or ditch within the VDOT ROW. Contractor shall not alter existing grades on the backside of the ditch such that they would block or obstruct Parcel Oil sheet flows into VDOT ROW or defined ditch.

RW PLANS

THESE PLANS ARE UNFINISHED AND UNAPPROVED AND ARE NOT TO BE USED FOR ANY TYPE OF CONSTRUCTION.

SCALE	PROJECT	SHEET NO.
0 25' 50'	0607-047-630	3