

PROJECT MANAGER: Wall, Zaman, P.E. (752) 956-3272 (Hampton Roads District)
 SURVEYED BY: DATE Virginia Department of Transportation, Updated 12/2018
 DESIGN BY: Johnson, Mirmiran & Thompson, (804) 267-1246
 SURFACE UTILITY BY: DATE Johnson, Mirmiran & Thompson, Updated 1/2019

REVISED	STATE	ROUTE	STATE PROJECT	SHEET NO.
04/02/21	VA.	607	0607-047-630 R201, C501	8

DESIGN FEATURES RELATING TO CONSTRUCTION OR TO REGULATION AND CONTROL OF TRAFFIC MAY BE SUBJECT TO CHANGE AS DEEMED NECESSARY BY THE DEPARTMENT

Johnson, Mirmiran & Thompson
 Richmond, Virginia
 HYDRAULIC ENGINEER

Johnson, Mirmiran & Thompson
 Richmond, Virginia
 ROADWAY ENGINEER

RW PLANS

THESE PLANS ARE UNFINISHED AND UNAPPROVED AND ARE NOT TO BE USED FOR ANY TYPE OF CONSTRUCTION.

NOTE: See Sheet IE(3) for Utility Owners Information

Legend

- Perm** Denotes Permanent Easement
- Temp** Denotes Temporary Easement
- C** Denotes Construction Limits In Cuts
- F** Denotes Construction Limits In Fills
- Denotes mill and overlay
- Denotes demolition of pavement
- Denotes proposed hydraulic cement sidewalk
- Denotes asphalt shared use path
- Denotes area of proposed pavement

F Route 607 SB
 Curve SBC2
 PI = 339+41.29
 DELTA = 6°05'54.30" (LT)
 D = 1'09'09"
 T = 264.85'
 L = 529.21'
 R = 4972.00'
 PC = 336+76.44
 PT = 342+05.65
 e = 2.00%
 V = 50 MPH
 Lr = 72
 U = 72

H Route 607 NB
 Curve NBC3
 PI = 238+62.81
 DELTA = 6°04'28.6" (LT)
 D = 1'00'08"
 T = 303.35'
 L = 606.13'
 R = 5717.00'
 PC = 235+59.47
 PT = 241+65.60
 e = Match Existing
 V = 45 MPH ULS (Existing)
 Lr = Match Existing
 U = Match Existing

009
217 ASSOCIATES LTD
 Inst. #990015559
 PARCEL B
 Inst. #080001796 (PLAT)
 PB 73 PG 99
 67,357 AC.
 Tax# 1340100013

END PROJECT 0607-047-630 P101, C501
 CROAKER ROAD SB @ STA. 339+80.46

END PROJECT 0607-047-630 R201
 CROAKER ROAD SB @ STA. 338+83.33

217 ASSOCIATES LTD
 PARCEL A
 Inst. #990015559
 PB 73 PG 99
 67,357 AC.
 Tax# 1340100013

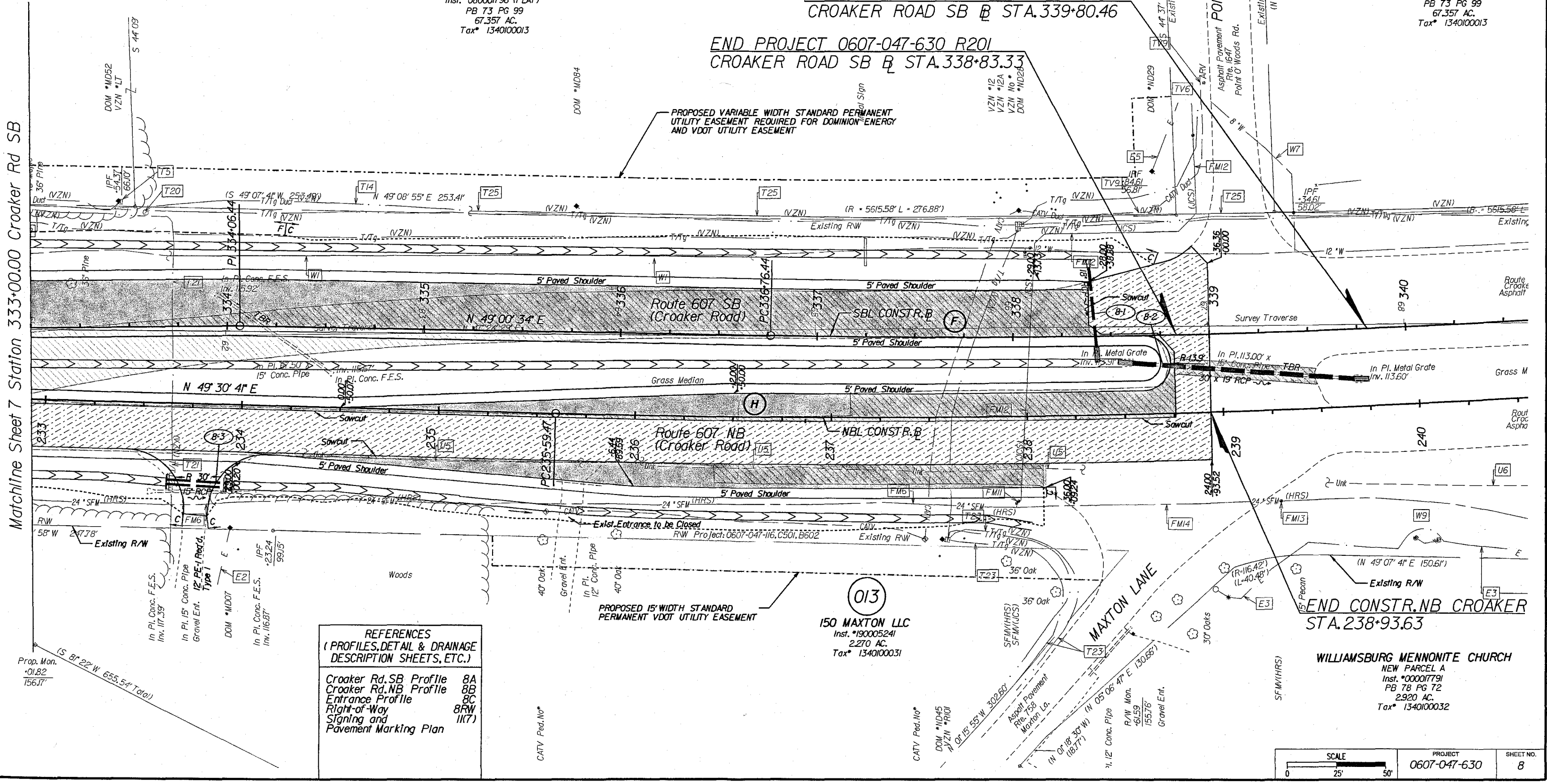

REFERENCES
 (PROFILES, DETAIL & DRAINAGE DESCRIPTION SHEETS, ETC.)

Croker Rd. SB Profile	8A
Croker Rd. NB Profile	8B
Entrance Profile	8C
Right-of-Way	8RW
Signing and Pavement Marking Plan	11(7)

013
150 MAXTON LLC
 Inst. #190005241
 2,270 AC.
 Tax# 1340100031

END CONSTR. NB CROAKER
 STA. 238+93.63

WILLIAMSBURG MENNONITE CHURCH
 NEW PARCEL A
 Inst. #000017791
 PB 78 PG 72
 2,920 AC.
 Tax# 1340100032

SCALE	PROJECT	SHEET NO.
0 25' 50'	0607-047-630	8

Matchline Sheet 7 Station 333+00.00 Croaker Rd SB

150 Maxton LLC Instrument 210022509 11/15/2021 State Highway Plat Book 11 Page 70